

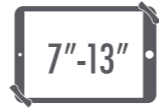

# Compact Gooseneck Floor Stand for 7-13 inch Tablets

## INSTRUCTION MANUAL



**PAD-CGS**

Thank you for choosing CTA Digital's product. We hope that you will enjoy using it. Please follow the guidelines and instructions as laid out in this instruction manual.



Create a mobile, adjustable workstation for your tablet with CTA Digital's Compact Gooseneck Floor Stand for 7-13 Inch Tablets. This stand is without equal in adjustability, featuring a powerful, flexible gooseneck and a tilting headpiece with easy 360-degree rotation. Customize your workstation further, with the stand's height-adjusting, telescoping pole and attachable storage cradle, perfect for an external battery pack or a stack of business cards. The included swivel casters attach effortlessly to the stand base, giving your stand easy mobility in your home, office, living room, classroom, or retail space. The quick-adjusting tablet holder slides open and secures your 7-13 inch tablet by the corners, leaving ports and buttons fully accessible.



Easily adjusts for horizontal or vertical views



Flexible Gooseneck

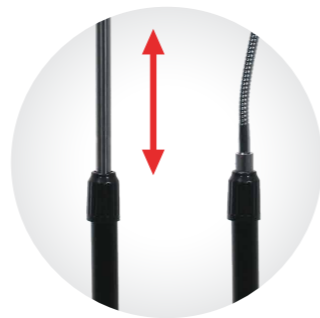

Telescoping Pole



Easy Roll Casters



Battery Pack Holder

### Package contents:

- (1) Stand base
- (1) Telescoping pole
- (1) Multi-function storage cradle
- (1) Gooseneck
- (1) Tablet holder
- (4) Swivel casters
- (1) Set of tools and hardware



### Instructions:

#### 1. Installing the Wheels



Place a spring washer over the screw bolt on the wheel.

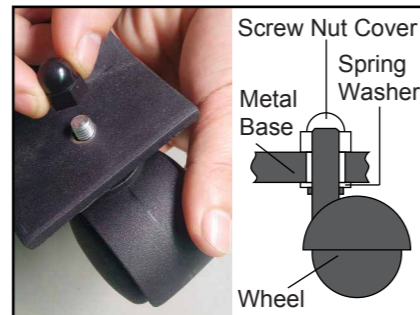

Place the screw bolt from each wheel through the metal base, then place a nut cover over the top of each and tighten until you can not tighten any more by hand. Use the thin wrench to hold the nut cover to tighten further.

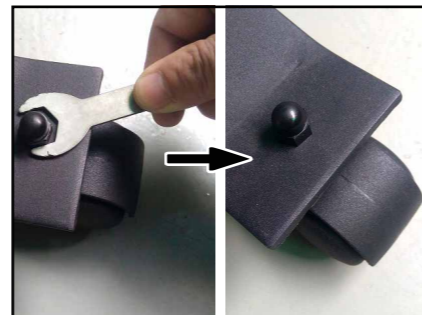

#### 2. Connecting the Pole to the Metal Base

##### Without Wheels

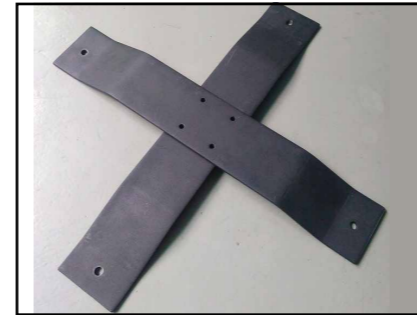

1. Align the holes at the bottom of the pole with the holes on the cross base.

2. Insert a screw bolt into each of the 4 holes.

##### With Wheels

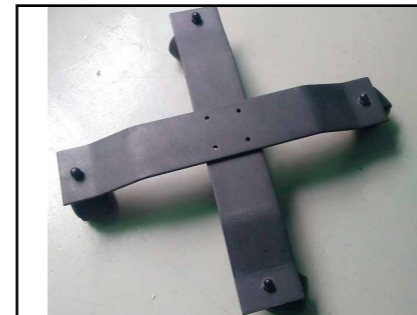

Cross the two metal stand pieces with the higher on top to form the base, aligning the four holes.

3. Place a washer on the underside of each screw and tighten each up.

4. Grip the nut on the underside with one hand and use the other to tighten each screw with the Allen key.

#### 3. Connecting the Metal Cover, Storage Cradle, and Gooseneck

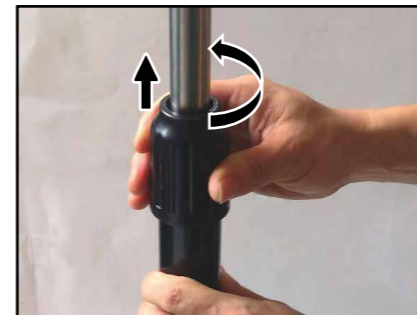

1. Rotate the grip counter clockwise to loosen completely and remove from top of pole.



2. Place the square metal cover over the top of the pole and slide down to stand base.



3. Place grip back over stand pole and tighten, then place storage cradle onto the head of the pole.

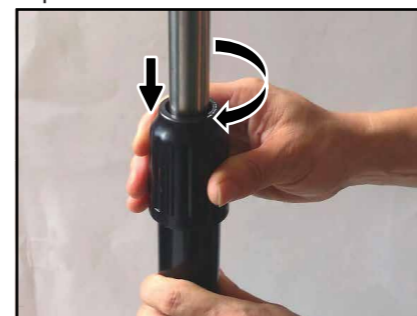

4. Place gooseneck over pole head and turn clockwise to tighten. Use the small Allen key to tighten the screw at the bottom of the gooseneck.

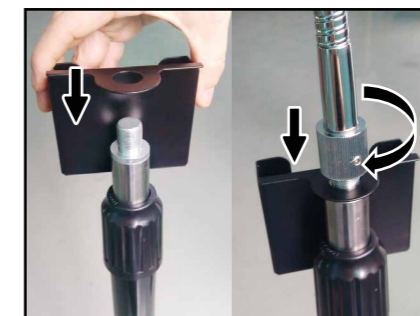

5. Place lock holder onto the gooseneck, connecting with the screw bolt and washer as shown in the diagram.

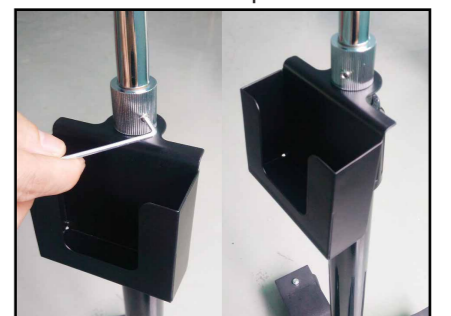

6. Use the large Allen key to tighten the connecting screw bolt.

#### 4. Installing your Device and Adjusting the Floor Stand:



1. Press the button on the side of the holder center to slide out holder arm. Insert your tablet against the spring end, then slide the other arm back in, closing firmly.

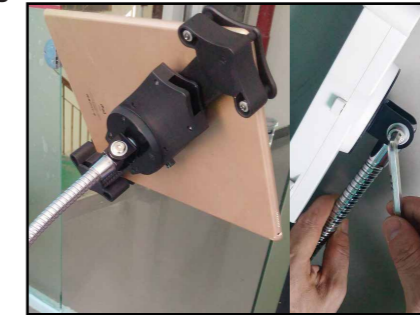

2. Tighten and loosen the gooseneck to holder connection screw to adjust ease of rotation.

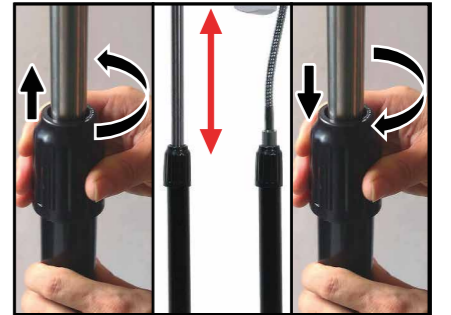

3. Rotate plastic grip counter clockwise to loosen, then adjust pole to desired height. Rotate plastic grip clockwise to tighten.