

DRIVE SLEEK

Vehicle Signal Booster Kit

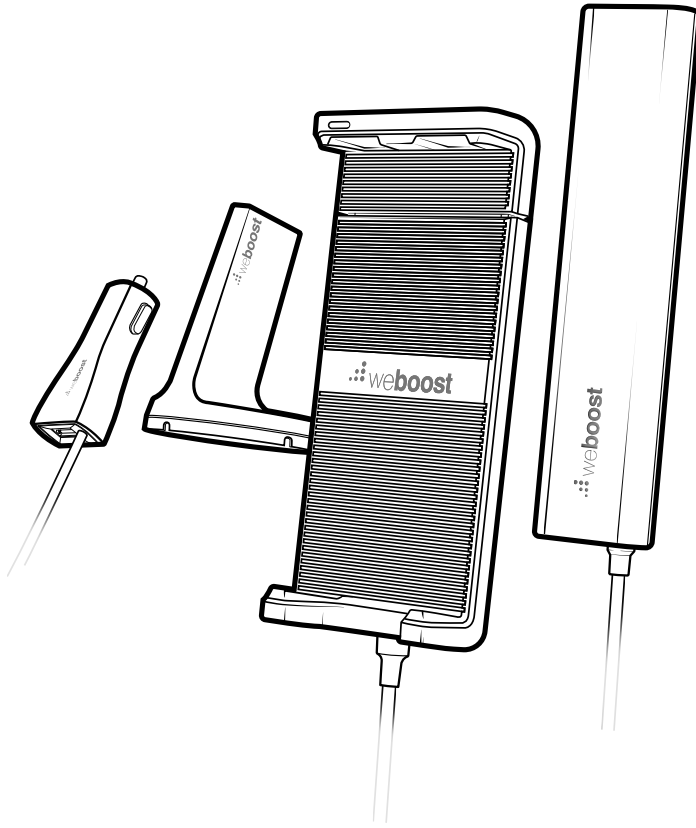

User Manual

Index

| | |
|--|----|
| Package Contents | 1 |
| STEP 1: Mount Outside Antenna | 2 |
| STEP 2: Route & Connect Booster | 3 |
| STEP 3: Route Cable To Front Of Vehicle | 5 |
| STEP 4: Connect System To Power | 6 |
| STEP 5: Insert Phone Into Cradle | 7 |
| Troubleshooting | 8 |
| Safety Guidelines | 9 |
| Specifications | 10 |
| Warranty | 11 |

Package Contents



Sleek
Cradle



Outside
Antenna



Signal
Booster



Power
Supply



Magnetic
Vent Mount
(for cradle)



Adhesive Magnetic
Dash Mount
(for cradle)

Step 1: Mount Outside Magnetic Antenna



Identify a location on the top of your vehicle that is:

- Near the center of the roof
- At least 12 inches away from any other antennas
- At least 6 inches away from any windows (including sunroofs)



Clean the surface where you will place the outside antenna.



Mount the outside antenna by placing on top of vehicle.

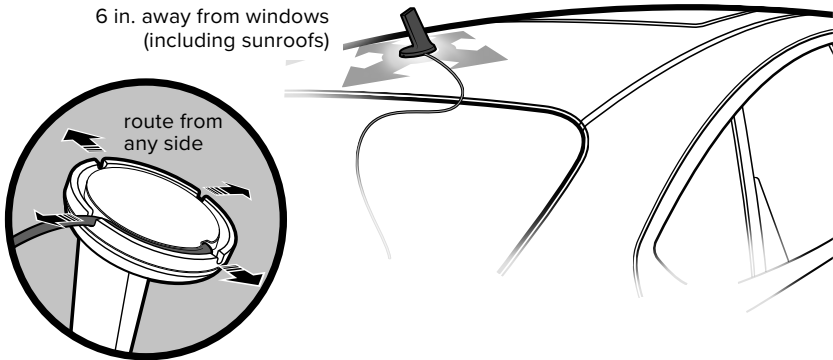

NOTE: For aluminum roofs, an **adhesive disk** is included to mount the outside antenna (do not use if outside antenna will magnetize to the top of your vehicle).



WORKS WITH ALL VEHICLES

Step 2: Route Antenna Cable & Connect Booster

Route the cable into the vehicle. See examples below.

NOTE: The cable is strong enough that it may be shut in most vehicle doors without damaging the cable.

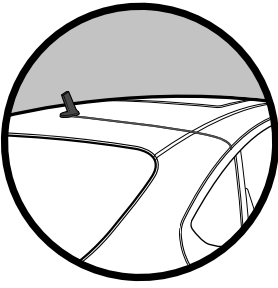

Car/Sedan: Cable routed into rear side door.

NOTE: When going through car wash, remember to remove your antenna.

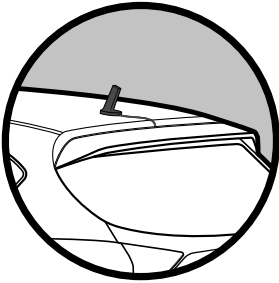

SUV/Van/Hatchback: Cable routed into top of hatchback door.

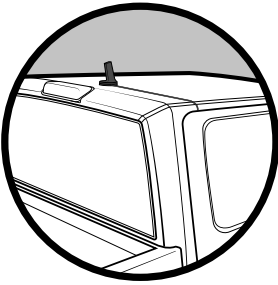

Truck: Cable routed into side door.

(STEP 2 cont.)

Connect the cable from the outside antenna to the booster port labeled **L ANTENNA** by simply pressing the connector in until you hear a “click”.

NOTE: Connecting cable from outside antenna to booster **does not** take much force.

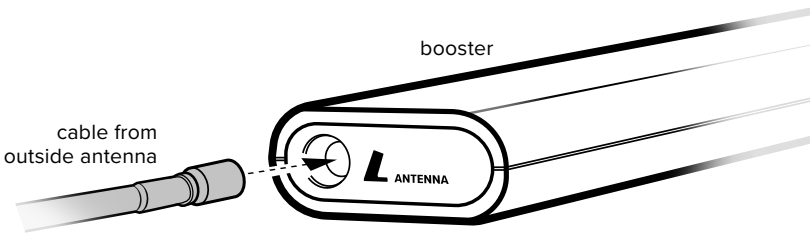

The included Velcro® can be used to mount the booster out-of-the way on the floor under a seat or mounted to the side of the trunk. It is best to mount in a place where the cables cannot be tripped over or snagged (damaging the booster).

NOTE: The “hook” side of the Velcro® (already on the booster) can be used to attach to the carpet of many vehicles.

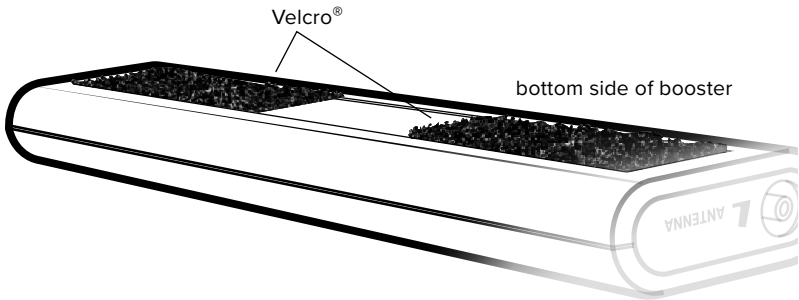

Step 3: Route Cable To Front Of Vehicle & Connect To Cradle

We recommend routing the 15ft. fixed cable from the booster, under mats and between seats up to the front of the vehicle where the cradle will be located.

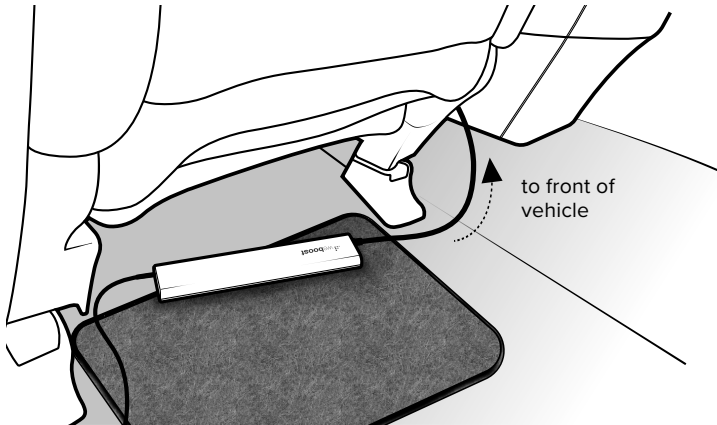

Connect booster cable to cradle cable.

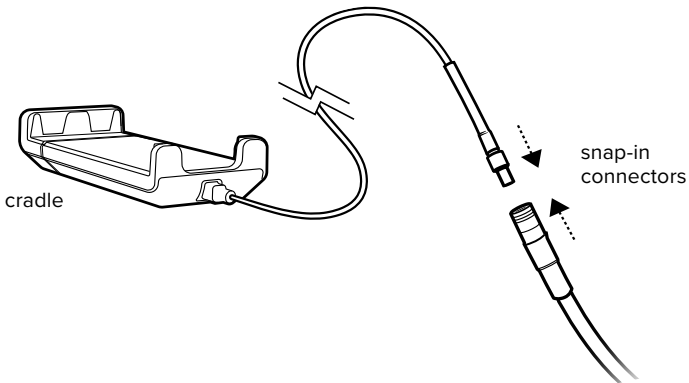

Step 4: Connect System To Power

Connect the power to the 12V* CLA port on your vehicle and route power cable back to the booster.

NOTE: We recommend routing with the same path as the cradle/booster cable (under mats and between seats). Cable clips are provided to help route & secure the cables.

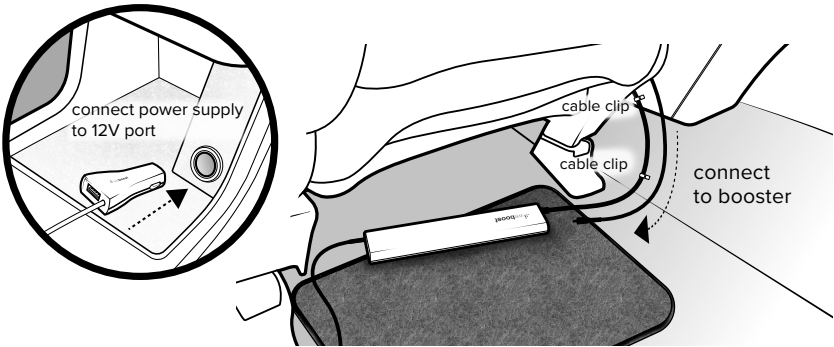

Connect power cable to booster port labeled  .

NOTE: The booster will be on whenever there is power from the 12V CLA port. If your vehicle always has power going to this port, you may want to unplug this when you're not driving so the booster does not drain your battery. ***Only 12V ports are supported.**

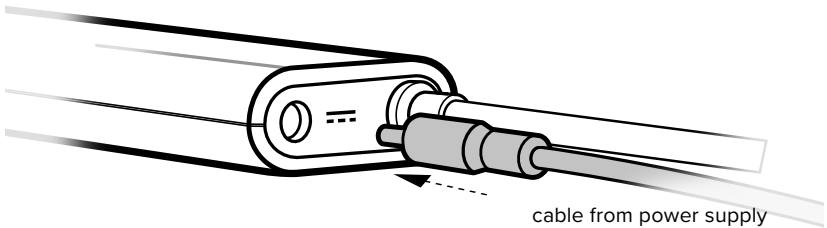

Step 5: Insert Your Phone Into Cradle

Make sure you have plenty of slack in the cable going to the cradle (Velcro® straps included to manage excess cable). Insert your phone into cradle and watch your signal increase!

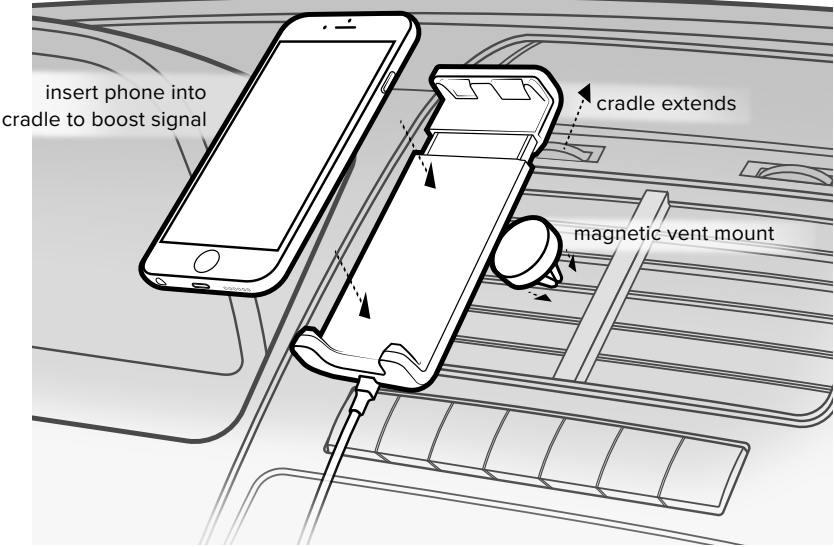

NOTE: A Magnetic Vent Mount & Adhesive Magnetic Dash Mount are provided which provides a versatile, safe and functional smartphone solution.

IMPORTANT: The FCC requires to never use the cell phone in the cradle next to your ear.

Troubleshooting

Solid White (LED on cradle)

This indicates that your booster is functioning properly and at maximum gain.

Light Off (LED on cradle)

Check/secure power connections to the CLA, booster, and cradle. If light shuts off, remove from vehicle port and plug back in to reset the system. For any questions or assistance contact our weBoost Customer Support Team (**1-866-294-1660**).

Dropped Calls

If you are regularly experiencing dropped calls in the same areas, turn off **VoLTE/HD Voice** in your phone's settings.

NEED HELP?



support.weboost.com



866.294.1660

Safety Guidelines

Use only the power supply provided in this package. Use of a non-weBoost product may damage your equipment.

Any antenna used with this device must be located at least 8 inches from all persons.

FCC requires to never use the cell phone in the cradle next to your ear.

This is a **CONSUMER** device.

BEFORE USE, you **MUST REGISTER THIS DEVICE** with your wireless provider and have your provider's consent. Most wireless providers consent to the use of signal boosters. Some providers may not consent to the use of this device on their network. If you are unsure, contact your provider.

In Canada, **BEFORE USE** you must meet all requirements set out in ISED CPC-2-1-05. You **MUST** operate this device with approved antennas and cables as specified by the manufacturer. Antennas **MUST** be installed at least 20 cm (8 inches) from (i.e., **MUST NOT** be installed within 20 cm of) any person.

You **MUST** cease operating this device immediately if requested by the FCC (or ISED in Canada) or licensed wireless service provider.

WARNING. E911 location information may not be provided or may be inaccurate for calls served by using this device.

FOR MORE INFORMATION ON REQUIREMENTS SET OUT IN ISED CPC-2-1-05, SEE BELOW:

<http://www.ic.gc.ca/eic/site/smt-gst.nsf/eng/sf08942.html>

FOR MORE INFORMATION ON REGISTERING YOUR SIGNAL BOOSTER WITH YOUR WIRELESS PROVIDER, PLEASE SEE BELOW:

Sprint: http://www.sprint.com/legal/fcc_boosters.html

T-Mobile/MetroPCS: <https://support.t-mobile.com/docs/DOC-9827>

Verizon Wireless: <http://www.verizonwireless.com/wcms/consumer/register-signal-booster.html>

AT&T: <https://securec45.securewebsession.com/attsignalbooster.com/>

U.S. Cellular: <http://www.uscellular.com/uscellular/support/fcc-booster-registration.jsp>

Specifications

Drive Sleek

| | | | | | |
|---|--|-----------------------------|----------------------------|-----------------------------|-----------------------------|
| Product Number | U470035 | | | | |
| Model Number | 460035 | | | | |
| FCC ID: | PWO460035 | | | | |
| IC: | 4726A-460035 | | | | |
| Frequency | 698-716 MHz, 729-756 MHz, 777-787 MHz, 824-894 MHz, 1850-1995 MHz, 1710-1755/2110-2155 MHz | | | | |
| | Maximum Power | | | | |
| Power output for single cell phone (Uplink) dBm | 700 MHz Band 12/17 18.74 | 700 MHz Band 13 21.57 | 800 MHz Band 5 22.65 | 1700 MHz Band 4 25.56 | 1900 MHz Band 2 19.19 |
| Power output for single cell phone (Downlink) dBm | 700 MHz Band 12/17 2.1 | 700 MHz Band 13 2.1 | 800 MHz Band 5 -2.5 | 2100 MHz Band 4 -0.6 | 1900 MHz Band 2 2.5 |
| Noise Figure | 5 dB nominal | | | | |
| Power Requirements | 12 V 1.5 A / USB 5V 2.1 A | | | | |

The term "IC" before the radio certification number only signifies that Industry Canada technical specifications were met.

Each Signal Booster is individually tested and factory set to ensure FCC compliance. The Signal Booster cannot be adjusted without factory reprogramming or disabling the hardware. The Signal Booster will amplify, but not alter incoming and outgoing signals in order to increase coverage of authorized frequency bands only. If the Signal Booster is not in use for five minutes, it will reduce gain until a signal is detected. If a detected signal is too high in a frequency band, or if the Signal Booster detects an oscillation, the Signal Booster will automatically turn the power off on that band. For a detected oscillation the Signal Booster will automatically resume normal operation after a minimum of 1 minute. After 5 (five) such automatic restarts, any problematic bands are permanently shut off until the Signal Booster has been manually restarted by momentarily removing power from the Signal Booster. Noise power, gain, and linearity are maintained by the Signal Booster's microprocessor.

This device complies with Part 15 of FCC rules. Operation is subject to two conditions: (1) This device may not cause harmful interference, and (2) this device must accept any interference received, including interference that may cause undesired operation. Changes or modifications not expressly approved by weBoost could void the authority to operate this equipment.



2 YEAR WARRANTY

weBoost Signal Boosters are warranted for two (2) years against defects in workmanship and/or materials. Warranty cases may be resolved by returning the product directly to the reseller with a dated proof of purchase.

Signal Boosters may also be returned directly to the manufacturer at the consumer's expense, with a dated proof of purchase and a Returned Material Authorization (RMA) number supplied by weBoost. weBoost shall, at its option, either repair or replace the product.

This warranty does not apply to any Signal Boosters determined by weBoost to have been subjected to misuse, abuse, neglect, or mishandling that alters or damages physical or electronic properties.

Replacement products may include refurbished weBoost products that have been recertified to conform with product specifications.

RMA numbers may be obtained by contacting Customer Support

DISCLAIMER: The information provided by weBoost is believed to be complete and accurate. However, no responsibility is assumed by weBoost for any business or personal losses arising from its use, or for any infringements of patents or other rights of third parties that may result from its use.

NEED HELP?



support.weboost.com



866.294.1660



3301 East Deseret Drive, St. George, UT

 866.294.1660  www.weboost.com  support.weboost.com

Copyright © 2017 weBoost. All rights reserved.

weBoost products covered by U.S. patent(s) and pending application(s)

For patents go to: weboost.com/us/patents