



Tru-Form Media™ 1500 Wireless Ergonomic Keyboard & Laser Mouse



Model: WKB-1500GB

QuickGuide English

www.adesso.com

LIMITED WARRANTY

Adesso provides a one year limited warranty for all of its products against defects in material and workmanship.

During this period, Adesso will repair or replace any product which proves to be defective. However, Adesso will not warranty any product which has been subject to improper freight handling, shipping abuse, neglect, improper installation or unauthorized repair. The warranty will not cover products installed with components not approved by Adesso and products where the sealed assembly trace has been broken.

If you discover a defect, Adesso will, at its option, repair or replace the product at no charge to you provided you return it during the warranty period with freight charges pre-paid to Adesso. Before returning any product, you must obtain a Return Merchandise Authorization number (RMA). This RMA # must be clearly marked on the outside of the package you are returning for warranty service. Be certain to also include your name, shipping address (no PO Boxes), telephone number, and a copy of the invoice showing proof of purchase in the package.

SUPPORT

We have listed most of our FAQ's (Frequently Asked Questions) at: <http://www.adesso.com/faqs.asp>. Please visit our FAQ Service & Support pages before you contact our E-mail or Telephone Support.

Email Support: If our FAQ's do not help you resolve your issues, please email support@adesso.com

Telephone Support:
Toll Free: (800) 795-6788
9:00AM to 5:00PM PST Monday - Friday

INTRODUCTION

The Adesso 2.4GHz Wireless Ergonomic Keyboard & Laser Mouse offer users two advanced input devices with ergonomic design, multifunctional features and a wireless range of up to 30 feet. The design of this keyboard with splitted key zones and gently sloped encourages natural position of hands, wrists, and forearm in maximum comfort for long use. The included wireless laser mouse not just provides comfortable ergonomic design but also equips with a DPI switch for changing resolution (800/1200/1600) and two Internet navigation buttons.

SPECIFICATIONS

- Keyboard & Mouse Wireless Technology: 2.4GHz RF Wireless Technology
- Keyboard & Mouse Working Range: Up to 30 feet (10m)
- Keyboard & Mouse Battery Type: (2) AAA Batteries per device
- Keyboard Layout: 105-Key US
- Key Type: Membrane
- Keyboard Hotkeys: 20 Hotkeys (Windows, Internet and Multimedia)
- Keyboard Indicators: Battery Low, Num Lock & Caps Lock
- Keyboard Dimensions: 20.5" x 9.3" x 1.5" (521 x 236 x 41 mm)
- Mouse Tracking Method: Laser Sensor
- Mouse DPI: 3 Levels - 800, 1200 & 1600
- Mouse Dimensions: 3.3" x 5.0" x 1.7" (85 x 127 x 44 mm)

REQUIREMENTS

- Operating System: Windows® 8/ 7/ Vista/ XP
- Connectivity: USB for Wireless Receiver

CONTENTS

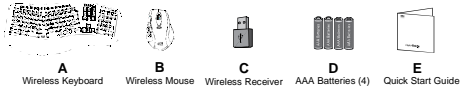

MOUSE DESCRIPTION

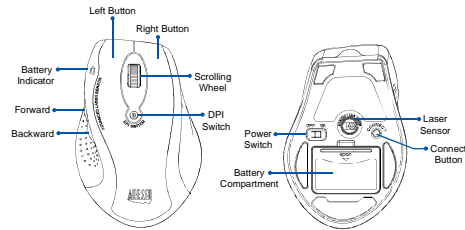

KEYBOARD DESCRIPTION

Internet, Multimedia, Power & Utility Hotkeys (Refer to page 9 for definitions)
Indicators (Num Lock/ Caps Lock/Battery Low)

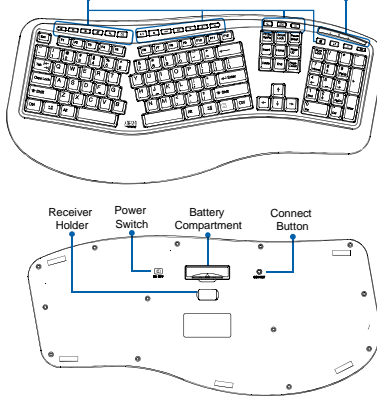

INSTALLATION

1. Procedure of changing your batteries:
 - a) Remove battery cover from mouse battery compartment
 - b) Insert (2) AAA batteries into device.
 - c) Close the battery compartment cover.

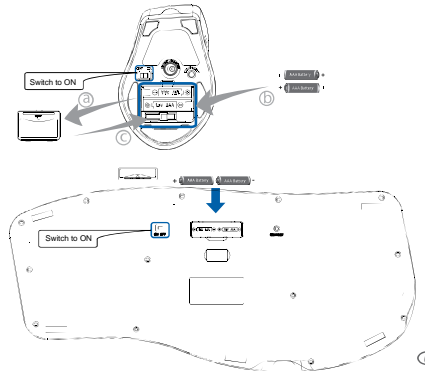

2. Turn ON your computer and let Windows load completely.
3. Plug the USB Wireless Receiver into the USB port of your computer

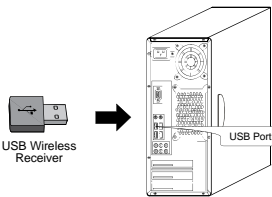

4. Receiver will automatically connect with wireless keyboard and mouse. Now, they are ready to be used.

NOTE:

Windows will detect the driver automatically. No driver required.

TIPS:

- When the Battery Low LED is ON, it means that the device requires to change the batteries.
- We suggest to turn "OFF" the devices when leaving your desk for more than an hour to save battery life for longer lasting use.

TROUBLESHOOTING

If wireless keyboard/ mouse cannot be operated, please try the following:

1. Make sure you have inserted two AAA batteries inside the battery compartment correctly. Switch the device to ON.
2. Make sure you have connected the USB receiver correctly to the computer's USB ports. Move the devices 1 foot away from the receiver in order to avoid interference while pairing connection.
3. Press CONNECT once on the bottom of devices within 15 seconds after plugging USB receiver to computer.

Note: Wireless phone, routers and other devices that uses 2.4GHz frequency, might cause interference with wireless keyboard and mouse. Please relocate such wireless appliances away from your keyboard and mouse.

HOTKEY DEFINITIONS

Key	Action	Description
Home	Home	Accesses Homepage
Back	Back	Back to the previously viewed webpage
Forward	Forward	Go to the next viewed webpage
Refresh	Refresh	Refreshes Internet browser webpage
Search	Search	Launches Search Bar
Favorites	Favorites	Launches saved favorite list in default Internet browser
Play/Pause	Play/Pause	Play or pauses track in multimedia software
Stop	Stop	Stops track from playing in multimedia software
Previous Track	Previous Track	Takes you to previous track in multimedia software
Next Track	Next Track	Takes you to next track in multimedia software
Volume Down	Volume Down	Decreases computer main volume
Volume Up	Volume Up	Increases computer main volume
Mute	Mute	Mutes computer main volume
Sleep	Sleep	Sets computer to sleep mode
Wake Up	Wake Up	Wakes computer up
Power Off	Power Off	Shuts down computer
Calculator	Calculator	Launches Calculator
My Computer	My Computer	Launches My Computer menu
Music	Music	Launches default media player application
Email	Email	Launches default email application