

Connecting Directly To A Vehicle Battery

(Please Refer to Diagram on Previous Page)

1. Mount the inverter inside the vehicle in a well ventilated location close to the battery
2. Disconnect the **NEGATIVE (-)** or black battery terminal of the vehicle
3. Route cables close to the battery
4. Install the insulated terminal boots on the inverter end of the power cables (**RED = positive**, **BLACK = negative**)
5. Connect the **BLACK** Cable to the Negative (-) terminal on the Inverter
6. Connect the **RED** Cable to the Positive (+) terminal on the Inverter
7. Connect the other end of the **RED** cable to the (+) terminal on the vehicle battery
8. Visually inspect and make sure the red wire or its connectors are not touching any metal parts of the vehicle or the black wire connectors
9. Connect the other end of the **BLACK** cable to the (-) terminal on the vehicle battery. **Caution:** There is normally a spark at the point of contact at the negative terminal
10. Check all connections making sure the **RED** cable is connected to the **POSITIVE (+)** terminals and the **BLACK** cable is connected to the **NEGATIVE (-)** terminals
11. Press the **POWER** button to turn on your inverter

Connecting To A Vehicle Accessory Port

Connect the **BLACK** 12V Accessory Cable to the **Negative** Post on the Power Inverter

Connect the **RED** 12V Accessory Cable to the **Positive** Post on the Power Inverter

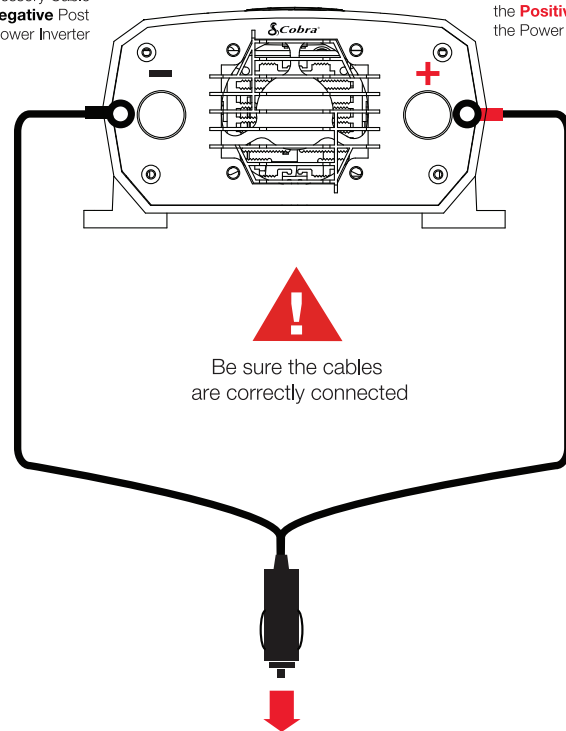

Plug the 12V Accessory Cable into the Vehicle Accessory Port*

1. Mount your inverter in a well-ventilated area of vehicle
2. Remove the thumb cap on the inverter for each terminal
3. Connect the **RED (+)** 12V Accessory Cable ring terminal to the **RED (+)** inverter terminal.
4. Screw the thumb cap back on the **RED (+)** inverter terminal
5. Connect the **BLACK (-)** 12V Accessory Cable ring terminal to the **BLACK (-)** inverter terminal.
6. Screw the thumb cap back on the **BLACK (-)** inverter terminal
7. Plug the 12V Accessory Cable into vehicle accessory port*
8. Place the power switch into the ON position by pressing the left side of the switch to turn ON your inverter. Place the power switch into the OFF position by pressing the right side of the switch to turn OFF your inverter

*The 12V Accessory Cable can support on average up to 120 Watts. Do not overload. Please refer to your vehicle manual for the maximum load your vehicle's accessory port can handle

Cobra®

PURE SINE 400W

POWER INVERTER



QUICK START GUIDE

Thank you for purchasing the Cobra PURE SINE 400 Watt Inverter (Model CPI400PSW)

Ideal for travelers and outdoor enthusiasts who want to power devices and equipment as if they were home. Also perfect for specialty and medical equipment.

Count on Cobra for Power Where You Need It.

Download the full CPI400PSW manual at:
cobra.com/manuals



Cobra® and the snake design are registered trademarks of Cobra Electronics Corporation, USA.
Cobra Electronics Corporation™ is a trademark of Cobra Electronics Corporation, USA.
Other trademarks and trade names are those of their respective owners.

PURE SINE 400W Features

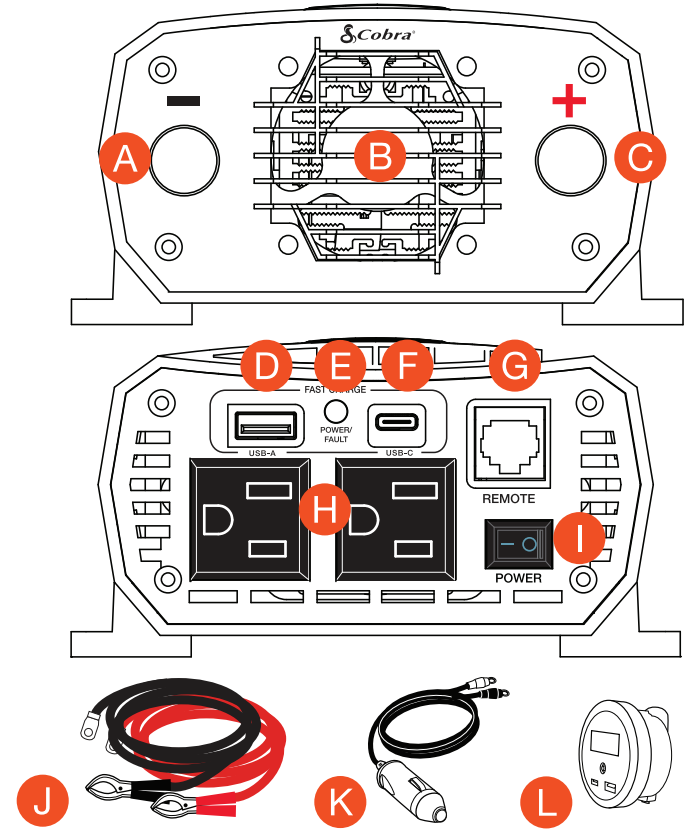

*Model CPIALCDG1

- A. Negative Power Input Terminal
- B. Cooling Fan - regulate the temperature of the inverter, turning on when temperature exceeds the preset limit, and turning off when the temperature reduces
- C. Positive Power Input Terminal
- D. USB-A Fast Charge port (5V/9V/15W)
- E. Power/Fault LED Indicator
- F. USB-C Fast Charge port (5V/9V/15W)
- G. Port for Cobra Remote On/Off Controller with Fast Charge USB (Sold Separately)*
- H. (2) GFCI Protected AC Outlets
- I. Power Switch
- J. Power Cables
- K. 12 Volt Accessory Cable (for vehicle accessory port)
- L. Cobra Remote On/Off Controller with Fast Charge USB (Sold Separately)*

Connecting Directly To A Vehicle Battery

(Instruction on the Following Page)

Connect the **BLACK** Cable to the **Negative** Post on the Power Inverter

Connect the **RED** Cable to the **Positive** Post on the Power Inverter

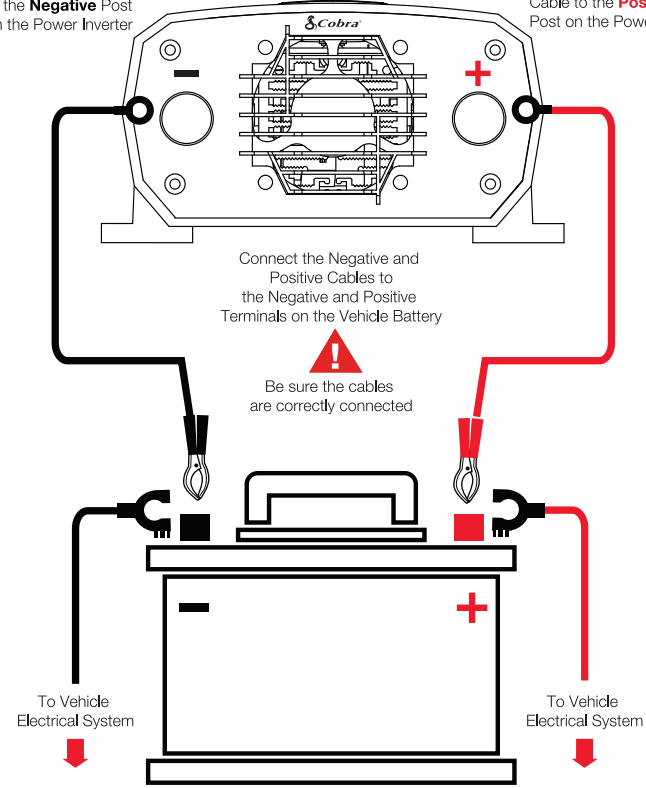

Continued →