

MP3 Equalizer

Note: MP3 files will not play in DVR mode.

1. Press **Mode** to select MP3 mode, indicated by an **MP3 icon** near the top of the display.
2. With playback stopped, press and hold **Mode** until the display starts flashing, then **press Mode repeatedly until the display reads "Eq"**.
3. Use the **Up/Down buttons** to choose one of the following EQ settings:
 - Natural - 00
 - Rock - 01
 - Pop - 02
 - Classic - 03
 - Soft - 04
 - Jazz - 05
 - Dynamic Bass Boost (DBB) - 06
4. Press **Play/Pause** to confirm the selection.

Delete Files

1. In **DVR mode**, use the **Up/Down buttons** to select a file to delete.
2. Press and hold **Mode** to begin deleting the file.
3. When the display reads *"DEL"*, press the **Play/Pause button** to confirm and delete the file.
4. **To delete all files on the recorder**, while the display reads *"DEL"*, press the **Down button** until the display reads *"AL"*.
5. Press **Play/Pause** to confirm and delete all files.

USB Connections

Note: Using USB at anytime will interrupt any other operations or modes. MP3 and WAV file types are supported on this device.

1. Using a **Mini-USB to USB cable (included)**, connect the Mini-USB port on the recorder to a USB port on a powered on computer.
2. Using the computer's file/folder browser, you can access, transfer or delete files on the recorder.

FCC WARNINGS

- Warning: Changes or modifications to this unit not expressly approved by the party responsible for compliance could void the user's authority to operate the equipment.

NOTE: This equipment has been tested and found to comply with the limits for a Class B digital device, pursuant to Part 15 of the FCC Rules. These limits are designed to provide reasonable protection against harmful interference in a residential installation. This equipment generates, uses, and can radiate radio frequency energy and, if not installed and used in accordance with the instructions, may cause harmful interference to radio communications. However, there is no guarantee that interference will not occur in a particular installation. If this equipment does cause harmful interference to radio or television reception, which can be determined by turning the equipment off and on, the user is encouraged to try to correct the interference by one or more of the following measures:

- Reorient or relocate the receiving antenna.
- Increase the separation between the equipment and receiver.
- Connect the equipment into an outlet on a circuit different from that to which the receiver is connected.
- Consult the dealer or an experienced radio/TV technician for help.

ADDITIONAL WARNINGS

- **WARNING:** To prevent fire or shock hazards, do not expose this unit to rain or moisture.
- Keep new and used batteries away from children. If the battery compartment does not close securely, stop using the product and keep it away from children.
- Do not mix old and new batteries.
- Completely replace all old batteries with new ones.
- Do not mix alkaline, standard (carbon-zinc), or rechargeable (ni-cad, ni-mh, etc) batteries.
- Batteries should be recycled or disposed of as per state and local guidelines.
- **WARNING:** This product may contain chemicals known to the State of California to cause birth defects, or other reproductive harm (California Prop 65). Wash hands after handling.
- This product meets and complies with all Federal regulations.
- **To avoid hearing damage**, make sure that the volume on your music player is turned down before connecting your headphones. After placing headphones in/on your ears, gradually turn up the volume until you reach a comfortable listening level.
- If the unit will be left unused for long periods, remove the batteries to prevent corrosion damage from battery leakage.

International Support

To download this User's Guide in English, Spanish, or French, or to get answers to frequently asked questions, visit the support section at:

www.gpx.com

Para descargar este Manual del Usuario en Inglés, Español y Francés, o para obtener respuestas a preguntas frecuentes, visite la sección de apoyo en:

www.gpx.com

Pour télécharger ce guide de l'utilisateur en Anglais, Espagnol ou Français, ou pour obtenir des réponses à des questions fréquemment posées, consultez la rubrique d'assistance sur:

www.gpx.com

Contact Information

Website: www.gpx.com

Email Support: prodinfo@dpiinc.com

Email Parts: partsinfo@dpiinc.com

Phone Support: 1-888-999-4215

Warranty

For Warranty Information and the most up-to-date version of this User's Guide, go to:
www.gpx.com.



***Protect for Today
Sustain for Tomorrow***

Specifications are subject to change without notice.

Copyright © 2017 Digital Products International (DPI, Inc.)

All other trademarks appearing herein are the property of their respective owners.



Digital Voice Recorder

User's Guide for Model PR047B-1652-01

Features

- Voice activated recording - recording starts and stops when sound stops
- 4GB installed flash memory - up to 272 hours hrs recording time or 99 audio files
- 4 recording settings:
 - LP - Long Play for lower quality, smaller files
 - SP - Standard Play for higher quality, larger files
 - HP - High Quality Play for best quality
 - L1 - Telephone recording file
- Digital audio record/playback: WAV/MP3
- Digital audio: MP3
- Hold switch
- Built-in microphone and speaker
- Mini-USB port for PC connect
- 3.5mm headphone jack
- External microphone jack
- LCD display
- DC battery power: requires 2 AAA batteries (not included)
- Battery life: approx. 13.5 hrs recording, 9 hrs at headphone playback, 3.5 hrs speaker playback

Includes

- Stereo earbuds
- Mini-USB to USB cable
- 3.5mm audio cable
- Telephone/recording junction box
- Telephone Cable
- Clip-on microphone
- User's Guide

Battery Power

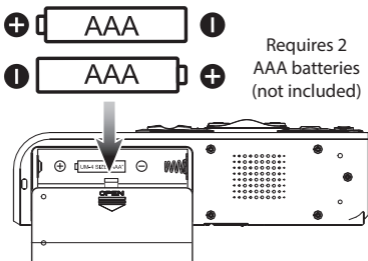

Overview & Controls

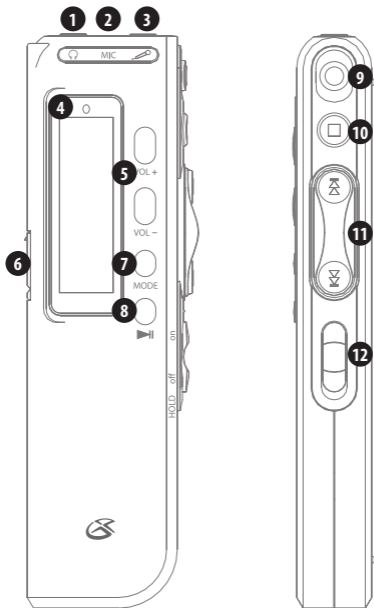

1. Headphone Jack
2. Internal Mic
3. External Mic jack
4. LED display/record indicator light
5. Volume
6. Mini-USB port
7. Mode select
8. Power On/Off/Play/Pause
9. Record
10. Stop
11. Skip Fwd/Rev/Up/Down
12. Hold/Lock controls

Powering On

- Press and hold the **Play/Pause button** to power the unit ON or OFF. The display will read *“Open”*.
- If the unit is idle for 2 minutes, it will automatically power OFF.

Record/Play Modes

- The unit will enter **Record mode** automatically after powering ON, indicated by a **DVR icon** in the top left of the display. **Play mode** is indicated by an **MP3 icon** in the top right of the display.
- Press the **Mode button** to change between **Record (DVR)** and **Play (MP3)** modes.

Recording Quality

1. In DVR mode, press & hold **Mode** until the display starts flashing, then press **Mode** repeatedly until display reads "rec".
2. Use **Up/Down buttons** to select HP, LP, SP and L1.
3. Press **Play/Pause** to confirm the selection.

Recording

1. In **DVR mode**, press the **Record button** to begin recording. The display will read "- - -" for 2 seconds. When the timer begins counting, the track is recording.
2. Press the **Record button** to pause/resume recording.
3. Press the **Stop button** at any time to stop recording and save the file.

Voice Activate Function

1. In **DVR Mode**, long press the **Mode button**, then short press the **Mode button** until the display reads "VOR".
2. Press **Up/Down** to turn Voice Activation ON or OFF, indicated by "On" or "of" on the display. Press **Play/Pause** to confirm the selection.
3. Press **Record** to begin recording. The unit will pause recording when no sound is detected and will resume recording when sound is detected.

Playback (DVR & MP3)

Note: Recorded WAV files will not play in MP3 mode.

1. Use the **Play/Pause/Stop controls** to play a file.
2. To change files, use the **Up/Down buttons**.

Loop/Repeat

1. While playback is stopped, long press the **Mode button**, then short press the **Mode button** until the display reads "*Loop*", then press the **Up/Down buttons** to select between the following:
 - "*ALL*" - repeat all recorded tracks
 - "*1*" - repeat the current selected track
 - No icon - repeat OFF
2. Press **Play/Pause** to confirm the selection.

A-B Mode (Program Repeat)

1. While playing a track, press the **Mode button** to simultaneously enter **A-B Repeat Mode and choose the starting point for A-B repeat.**
2. An **A-B icon** will appear on the display and "*-B*" will blink. Press the **Mode button** again to select the ending point for the repeating section.
3. To cancel A-B repeating and resume normal playback, press the **Mode button** again. The **A-B icon** will no longer be visible on the display.