

DOLPHIN

wavesync™
INSTRUCTIONS INSIDE



SPB-8X

DOLPHIN

wavesync™
INSTRUCTIONS INSIDE



SPB-8X

OVERVIEW

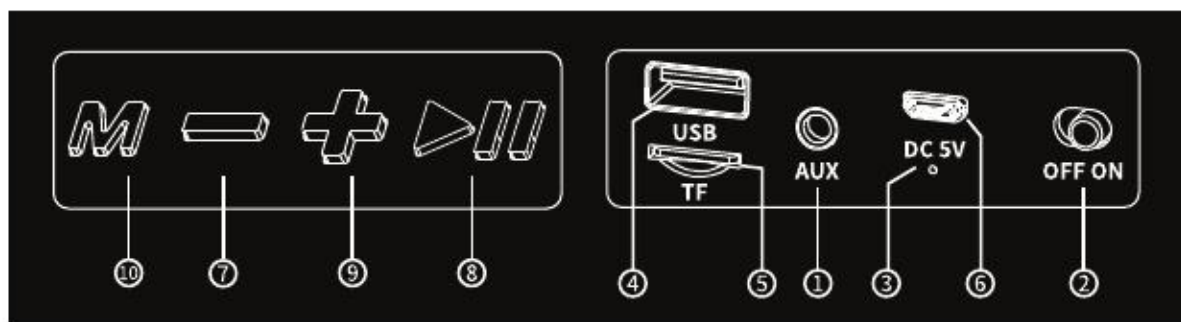

- 1. AUX Input:** Play music from an auxiliary device when AUX mode.
- 2. On/Off Switch:** Use this switch to turn the unit on or off
- 3. LED Charge Indicator:** Lets you know when the unit is
- 4-5. USB/TF MP3 Port:** Insert your USB or TF card with mp3 file to play music.
- 6. Micro USB Charge Port:** Use the included USB cable to charge the speaker with a USB adaptor.
- 7. Previous Song/Lower Volume:** Press once to go to the previous track and hold to lower the volume
- 8. Play/Pause and Radio Scan Button**
- 7. Next Song/Raise Volume:** Press once to go to the next track and hold to raise the volume
- 10. Mode/WaveSync™ Button:** Press once to change between Bluetooth and Radio modes. Hold this button to pair another speaker using the instruction on the following page.

BLUETOOTH CONNECTION

1. Press the mode button on the main channel control panel until you are in Bluetooth mode.
2. Turn on the Bluetooth setting on your phone and search for "SPB-8X".
3. Once connected, the LCD display will confirm the connection and you can begin to play music from your Bluetooth device. If a PIN code is required, enter "0000".

The wireless range for Bluetooth on this speaker is 33ft (~10m). Any distance further than this may cause stability issues with the music cutting in and out.

WaveSync™

To connect two speakers using WaveSync, first make sure you have two matching speakers with the same model number. Then do the following:

1. Turn on both speakers and put them in Bluetooth mode.
2. Hold the WaveSync™ button on one of the speakers and you will hear a beep noise confirming the connection.
3. Connect your device to the speakers by following the Bluetooth instructions on the top of this page.
4. Now any music played through Bluetooth will play on both speakers. This function only works in Bluetooth mode and does not transfer music from Radio, AUX, or USB/TF.

NOTE: WaveSync may not work with older or newer versions of the same model speaker. WaveSync is also not likely to work with another WaveSync enabled model. Consult your dealer before making any purchasing decisions.

AUX MODE

1. Find a 3.5mm AUX cable.
2. Connect one end of the cable to the AUX port of the speaker and the other end to your audio device.
3. Once the cable is inserted into the speaker, the speaker will automatically enter AUX mode. You can now play your music and control the volume on both your audio device and the speaker itself.

USB/TF MP3 FUNCTION

1. Place your MP3 song files in the root folder of a USB or SD card.
2. Insert the card into the proper port and the speaker will automatically begin to play the songs.
3. You can skip through the songs with the minus and plus buttons.

FM RADIO

1. Press the mode button once and you will be in the radio mode.
2. Hold the play button for 3 seconds and the speaker will scan for nearby radio stations.
3. Once it is done scanning, you can use the forward and back buttons to switch between the stations.
4. You can skip through the stations with the minus and plus buttons.

ACCESSORIES

Included in the box of this unit is the speaker, a USB charge cable, AUX Cable, and this user manual.

Please note that the adapter to charge this speaker is not included in the box. You can use any standard USB adapter or powerbank along with the included charge cable to charge this speaker. Also note that this speaker is not water resistant when aux or charge cable is connected and the rear flap is open.

WATER RESISTANCE GUIDELINES

This speaker has an IPX5 water resistance rating which means the it can be near or around water without worry. The speaker can withstand light rain and splash from a pool without getting damaged.

This rating does not mean the speaker can be submerged in water or withstand heavy rain for a long period of time. Please do not try to float this speaker in the pool, use in the shower, or use it in any way that will expose it to similar amounts of water.



HAPPY

If you are happy with your item, consider connecting with us on social media or leaving a positive rating online.

FELIZ

Si está satisfecho con su artículo, considere conectarse con nosotros en las redes sociales o dejando un comentario positivo en línea.



Something Wrong?

If you are unhappy with your item then we are not accomplishing our goal. Please contact us through our toll free number to see how we can make things right.

No esta Satisfecho?

Si no está satisfecho con su artículo, entonces no estamos cumpliendo nuestro objetivo. Por favor contáctenos a través de nuestro número gratuito para ver cómo podemos hacer las cosas bien.

FOLLOW US AT:

@dolphinaudio



1.888.550.3938
1.951.800.0078 (International)



support@dolphinaudio.com