

---

# GOLD DIGGER™ TREASURE DETECTOR Owner's Manual



Use 9-volt **ALKALINE** batteries.

Do not use "Heavy Duty" batteries.

Do not use ordinary "Zinc Carbon" batteries.

# GOLD DIGGER™ TREASURE DETECTOR

## Owner's Manual

### **I. ASSEMBLY:**

**To assemble your GOLD DIGGER™ Treasure Detector, follow this simple procedure:**

1) Unpack your detector and find the following parts:

- Detector Body with armrest, searchcoil and attached coil knob.
- Upper Stem (thicker silver rod with many holes).
- Lower Stem (thinner silver rod with plastic extension and button).
- Two (2) stem attachment knobs (in the plastic bag).

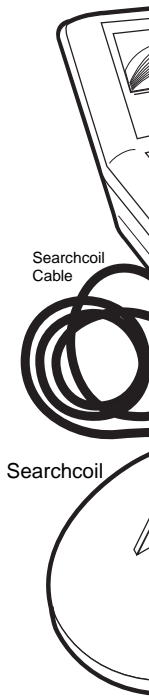

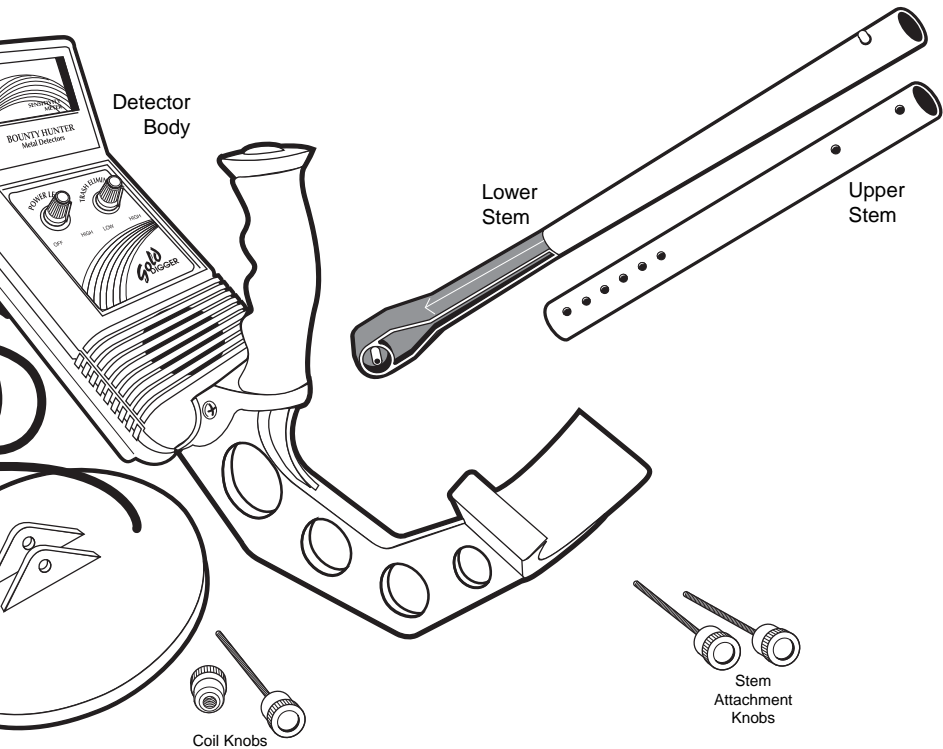

Detector  
Body

Lower  
Stem

Upper  
Stem

Coil Knobs

Stem  
Attachment  
Knobs

# I. ASSEMBLY: *(continued)*

2) Attach the Upper Stem to the back of the detector body with the two knobs supplied.

There are two battery doors on the back of the detector body.

3) Depress the button on the lower stem and push the lower stem into the upper stem.

**IMPORTANT:** use 9-volt ALKALINE batteries ONLY.

4) Wind the searchcoil cable around the two-piece stem.

5) Leave some slack in the cable as you reach the end of the lower stem.

6) Attach the coil to the lower stem using the attached coil knob.

7) Install two (2) 9-volt ALKALINE batteries (not supplied).

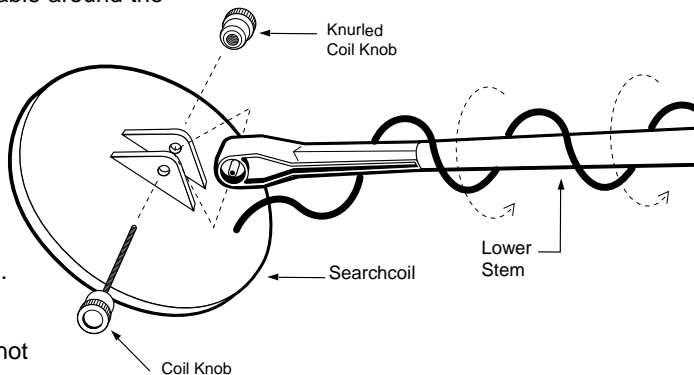

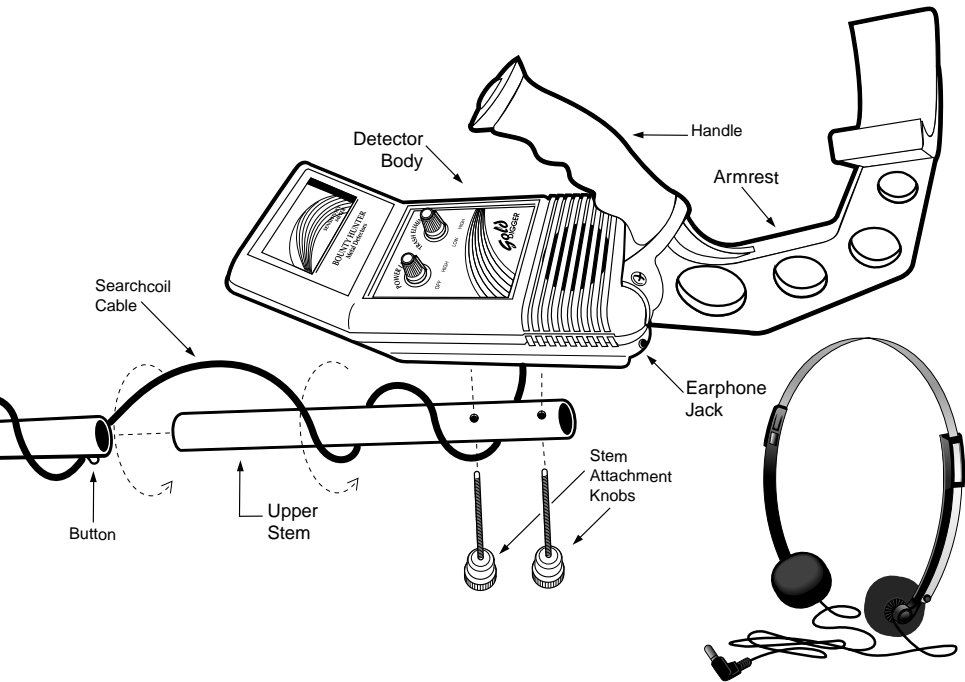

## II. HEIGHT ADJUSTMENT

Stand with the detector in one hand, with the coil on the ground, a few feet in front of you. If the stem is not set at a comfortable height, push the button on the lower rod to change the length. If you make a large adjustment, wrap the cable again, starting at the top.

**CAUTION:** *Do not pull on the cable where it connects to the detector body. It is permanently attached; too much force could damage the connection.*



### **III. FIND TREASURE!**

Your Treasure Detector will detect all kinds of metal from iron relics, to coins and household items, to precious metals like gold and silver.

## IV. SENSITIVITY METER

Your meter moves when metal is detected. It shows the strength of the signal and helps with pinpointing the object. Watch for the location where the meter jumps strongly to the right; that's where the target is.

## V. AIR TESTING

You can test your detector by passing coins over the search coil. Remember that coins found on the ground will lie flat; so pass the coins parallel to the search coil for optimum results.

**CAUTION:** *There is metal in the floors, ceilings, wall and counters of most homes. There is metal in tables. Keep the detector away from metal.*



*Do not attempt to place coins on the floor of your home or apartment; the metal in the floor will interfere with the signal.*

It is best to have a friend hold the detector body, with the search coil suspended in the air, while you pass the coins.

If you turn the detector on and turn the Trash Eliminator switch fully clockwise (to the right), you will hear different tones. Pass a penny, nickel, dime, quarter, nail, screwdriver and pull-tab. Notice the different sounds, or no sound at all! Turn the Trash Eliminator to many different settings, and sometimes notice different tones for the same object.

## VI. TUNING and GROUND BALANCING

*Forget it !*

With your GOLD DIGGER™ Treasure Detector, it's automatic. Be it hard ground, a sandy beach, rocks, or the black sand terrains common to gold prospecting locations, your GOLD DIGGER™ adjusts itself to tune out naturally occurring mineral deposits, and only detect the metal objects you are looking for.

## VII. CONTROLS

- **POWER/SENSITIVITY**

*(the left knob)*

The detector is off in the full counter-clockwise position (to the left).

Turn it on with a click to the right. The further clockwise, the higher the sensitivity. If you get static or noise, then lower the sensitivity a bit.

- **TRASH ELIMINATOR**

*(the right knob)*

**OFF Position**

In this position, all different metals will be detected.

One tone will sound for all types of metal.



- **TRASH ELIMINATOR** *(continued)*

**Applications: (Trash Eliminator in OFF position)**

- 1) Relic Hunting: Historical objects are usually made of iron. Keep the Trash Eliminator turned off for best detection of relics.
- 2) Household Applications: Find property markers, lost keys, etc.
- 3) Gold Prospecting: Did you know that only 1% of the world's gold supply has been mined? The other 99% is still out there waiting for you to find it!

**ON Position**

Click on to cause your detector to emit different sounds for different types of metals.

Turn the knob clockwise (to the right) to eliminate more trash items.

- **TRASH ELIMINATOR** *(continued)*

**Applications: (Trash Eliminator in ON position)**

- 1) Coin-shooting
- 2) Jewelry-Hunting

- Small iron objects, like nails, will not be detected.
- Trash items, like pull-tabs, will be identified with a broken tone.
- Silver and copper items (like some coins), will be identified with a high tone.

**CAUTION:** *some metal objects have a metallic signature very similar to trash.*

A nickel can sound very similar to a pull-tab. At different Trash Elimination settings, you can sometimes notice a slight tone difference.

- **TRASH ELIMINATOR** *(continued)*

between the two. There are several different types of pull-tabs and bottle caps. It takes practice to notice the difference.

Gold rings are almost impossible to distinguish from many pull-tabs. If you're looking for gold rings, get used to digging. You'll kiss a lot of frogs before you find your first prince. Perseverance furthers!

## **VIII. EARPHONES**

Use earphones to save battery life. When earphones are plugged into the jack, the Internal Speaker no longer produces sound. All audio feedback comes through your earphones. You can now detect fainter sounds indicating more deeply buried objects.

This device is to be used with interconnecting cables/headphone cables shorter than three meters.

**IS THERE A PROBLEM WITH MY DETECTOR?**  
(Detectorist's TROUBLESHOOTING GUIDE)

<b>SYMPTOM</b>	<b>PROBABLE CAUSE</b>	<b>SOLUTION</b>
Weak signal, constant chatter, low sensitivity, or no signal.	<ul style="list-style-type: none"> <li>• No batteries.</li> <li>• Dead batteries.</li> <li>• Wrong batteries.</li> <li>• Interference.</li> </ul>	<ul style="list-style-type: none"> <li>• Check batteries.</li> <li>• Use 9-volt ALKALINE batteries only.</li> <li>• Turn sensitivity down.</li> </ul>
Cannot detect coins on the floor.	Interference from metal in the floor.	<ul style="list-style-type: none"> <li>• Try it outdoors.</li> </ul>
No sound for some objects.	Trash eliminator is on. Small iron objects are purposely eliminated	<ul style="list-style-type: none"> <li>• Turn trash eliminator off.</li> </ul>
It just does not work.	Did you pull the cord loose from the detector?	<ul style="list-style-type: none"> <li>• None</li> </ul>
Poor performance operating near another detector, power lines, or indoors.	<ul style="list-style-type: none"> <li>• Interference from another detector or other electromagnetic field.</li> </ul>	<ul style="list-style-type: none"> <li>• Keep two detectors at least 20 feet apart.</li> <li>• Keep away from power lines.</li> <li>• Turn household appliances and lights off</li> </ul>

**Be Environmentally Conscious and Respect Others' Property**

- Use small digging tools. (a garden spade is preferable to a coal shovel.)
- Fill in holes.
- Obtain permission before hunting on private or government property.

## TREASURE HUNTER'S CODE OF ETHICS:

- Always check Federal, State, County and local laws before searching.
- Respect private property and do not enter private property without the owner's permission.
- Take care to refill all holes and leave no damage.
- Remove and dispose of any and all trash and litter found.
- Appreciate and protect our inheritance of natural resources, wildlife and private property.
- Act as an ambassador for the hobby, use thoughtfulness, consideration and courtesy at all times.
- Never destroy historical or archaeological treasures.
- All treasure hunters may be judged by the example you set; always conduct yourself with courtesy and consideration of others

### FIRST TEXAS PRODUCTS, LLC 1-YEAR LIMITED WARRANTY

This product is warranted against defects in workmanship or materials under normal use for one year from date of purchase to the original user. Liability in all events is limited to the purchase price paid. Liability under this Warranty is limited to replacing or repairing, at our option, any Bounty Hunter Detector returned, shipping cost prepaid, to First Texas Products, LLC. Damage due to neglect, accidental damage or misuse of this product is not covered by this warranty.

**Proof of purchase is required to make a claim under this warranty.**

#### NOTE TO CUSTOMERS OUTSIDE THE U.S.A.

This warranty may vary in other countries, check with your distributor for details.  
Warranty does not cover shipping costs.

According to FCC part 15.21 Changes or Modifications made to this device not expressly approved by the party responsible for compliance could void the users authority to operate this equipment. This device complies with FCC Part 15 Subpart B Section 15.109 Class B.

Copyright ©2014 by First Texas Products, L.L.C.

All rights reserved, including the right to reproduce this book, or parts thereof, in any form, except for the inclusion of brief quotations in a review.

Published by First Texas Products, L.L.C. Bounty Hunter® and VLF® are registered trademarks of First Texas Products, L.L.C.

[www.detecting.com](http://www.detecting.com)



First Texas Products, L.L.C.  
1465 Henry Brennan Dr., El Paso, TX 79936  
1-800-413-4131