



 **WARNING**



IMPORTANT: Read and follow all warnings and information before using this product, to reduce the risk of serious injury or fatality.

MEGA PRO GYM

*Strength-building power
with 450lbs total resistance*

TRAINING MANUAL





WARNING



IMPORTANT: Read and follow all warnings and information before using this product, to reduce the risk of serious injury or fatality.

DOOR ANCHOR:

- **ALWAYS** place the Door Anchor through the *hinge* side of the door
- **ALWAYS** lock the door when using the Door Anchor
- **NEVER** place the Door Anchor at the top nor bottom of the door
- **NEVER** place the Door Anchor at the door-knob side of the door

TUBING:

- **NEVER** stretch Tubing more the *twice* its resting length
- **NEVER** align stretched Tube with face or other sensitive parts of the body
- **ALWAYS** inspect Tubing before every use
- **DISCONTINUE USE** if Tubing becomes nicked or torn
- **ONLY** use this product in the manner shown or intended



WARNING

The risk of injury from participating in this or an fitness regimen and/or from the performance of these exercises or similar exercises is significant, and includes the potential for catastrophic injury or death. You should and must consult a medical professional before undertaking any fitness regimen or exercise program or diet including any exercises or techniques set forth in these materials (whether in video/DVD, book or pullout card form—collectively referred to in every media form as “Materials”).

These Materials are for educational purposes only (ie. they illustrate and explain various fitness-related and/or exercise techniques), and they do NOT advise that you or any other particular viewer undertake or perform any particular technique or exercise. You agree that you will not undertake or perform any exercise or technique described in the Materials until and unless you consult-with and are cleared-by a medical doctor in relation to such participation, and you agree to the terms of these Warnings and Disclaimers.

The models depicted in this program are well trained athletes and only you and your doctor can assess whether you are suited for the exercises and/or diets depicted in the program (e.g., you may have pre-existing injuries or other conditions that make the exercises or diets depicted inappropriate for you).

You acknowledge and agree that the Materials are provided by GoFit, LLC (directly and/or through their licensors). You agree that all persons appearing in these Materials do so on behalf of GoFit, LLC and that GoFit, LLC are the sole providers of the content of the Materials, notwithstanding any other person in the Materials appearing to endorse or recommend the Materials.

GOFIT, LLC AND THEIR AFFILIATED COMPANIES, DIRECTORS, OFFICERS, EMPLOYEES, AGENTS (INCLUDING THE MODELS IN THE MATERIALS) MAKE NO WARRANTIES OF ANY KIND OR NATURE RELATING TO THE MATERIALS, EITHER EXPRESS OR IMPLIED, AND EXPRESSLY DISCLAIMS ALL SUCH WARRANTIES AND REPRESENTATIONS, INCLUDING, BUT NOT LIMITED TO, THE WARRANTY OF FITNESS FOR A PARTICULAR PURPOSE. KNOWLEDGE REGARDING THE HUMAN BODY AND EXERCISES CHANGES; THEREFORE, YOU SHOULD CHECK THE FOLLOWING WEBSITE FROM TIME TO TIME IN ORDER TO DETERMINE WHETHER THERE IS ANY NEWS REGARDING THE MATERIALS AT WWW.GOFIT.COM; HOWEVER GOFIT, LLC HAS NO OBLIGATION TO PROVIDE UPDATES AND NEWS.



WARNING

DOOR ANCHOR INSTALLATION

(Refer to *DOOR ANCHOR PLACEMENT* on page 4 for proper placement and position options)

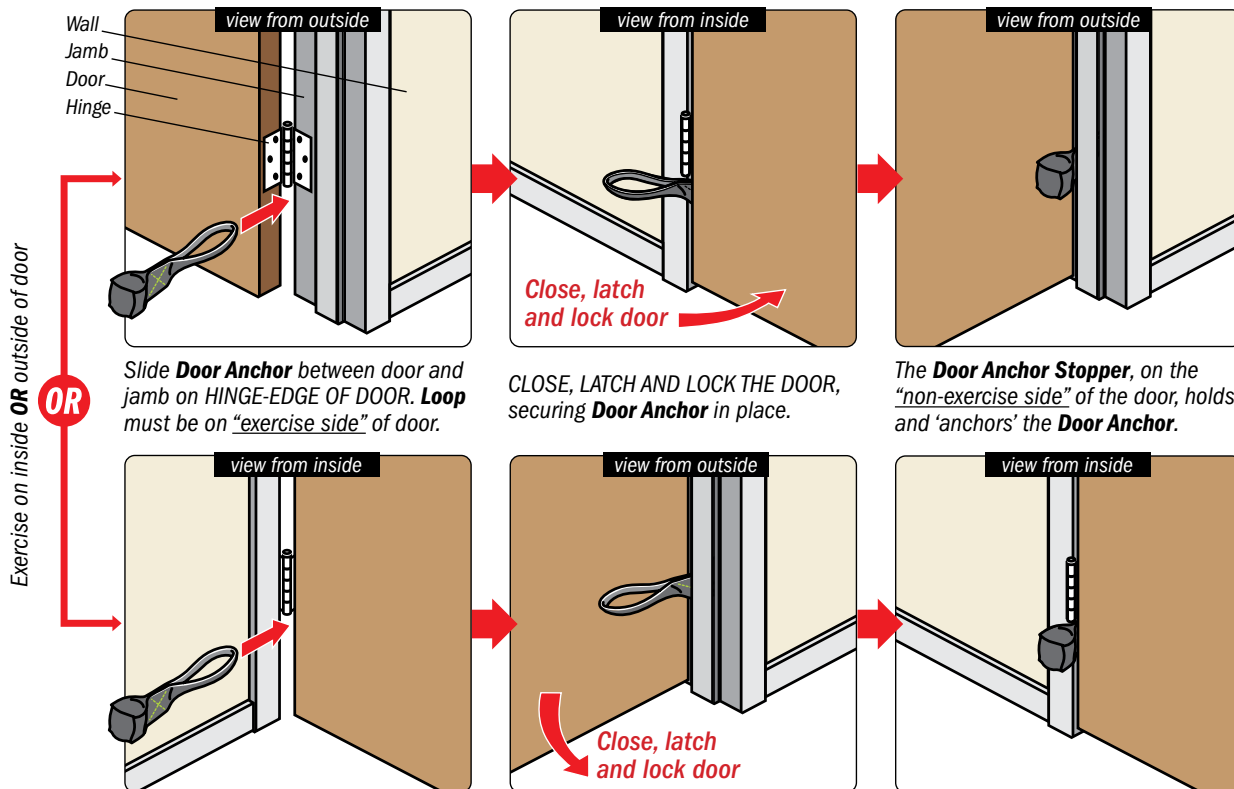



WARNING

DOOR ANCHOR PLACEMENT

(Refer to DOOR ANCHOR INSTALLATION on page 3)

• **ALWAYS** place Door Anchor through **HINGE SIDE** of door

• **NEVER** place Door Anchor at the **top** of the door

• **NEVER** place Door Anchor at the **door-knob side** of the door

• **NEVER** place Door Anchor at the **bottom** of the door

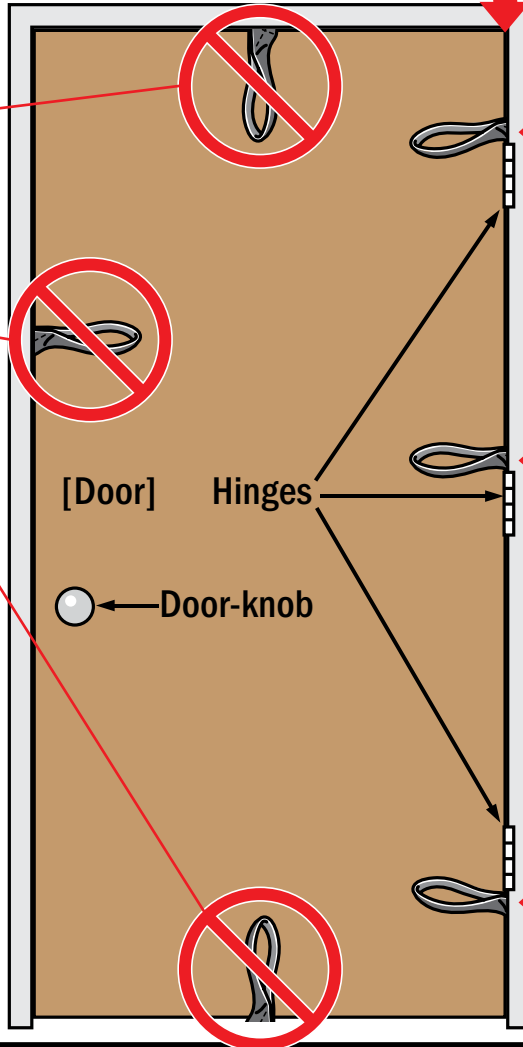
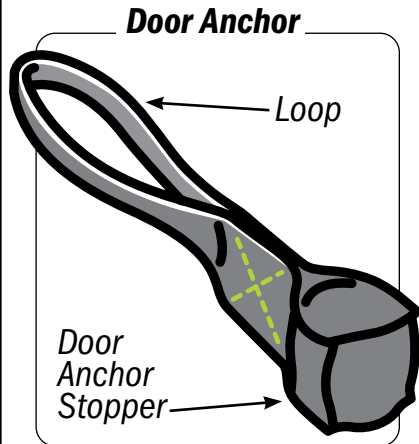

DOOR ANCHOR POSITION OPTIONS:

UPPER POSITION
[for specific exercises]

OR

MIDDLE POSITION
[for specific exercises]

OR

LOWER POSITION
[for specific exercises]

SQUATS

Standing with the instep of both feet on the tubing, bring the handles up over the back of your shoulders. Keeping your chin forward and your back straight, slowly flex at your knees, lowering your bottom towards the floor. Do not go beyond 90 degrees.



LUNGE

Place the tubing under the instep of your front foot while bringing the handles up to shoulder level. Place your back foot to the rear, approximately 3' (1 meter) from your front foot. Try to keep your feet pointing forward. Slowly bend at your knees, ensuring that both knees flex to 90 degrees. Do not let your back knee touch the ground.



BICEP CURLS

Standing with the instep of both feet on the tubing (about shoulder width apart), grasp the handles with your palms facing forward. Maintaining a straight back and keeping your elbows at your sides, curl the handles toward your shoulders.



This exercise can be done simultaneously or alternating.

ALTERNATING SHOULDER PRESS

With a slightly staggered foot stance, stand with the instep of your front foot on the tubing and bring the handles up to shoulder level. With your palms facing forward, slowly extend your right arm over your shoulder, bringing your hand directly overhead. Return to the starting position and perform the movement on the opposite side.

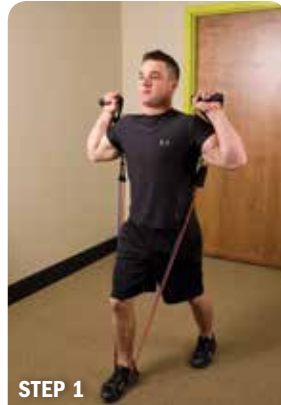

STEP 1



STEP 2



STEP 3

UPRIGHT ROWS

Standing with your feet far enough apart so that there is slight tension in the tubes, grasp the handles with your palms facing towards you. Your hands should be approximately at hip level. Slightly flex your knees while keeping your back and upper body straight. Bring your hands in a straight line towards your chin, ensuring that your elbows go out away from your body.



STEP 1



STEP 2

SQUAT WITH SIDE STEP

Standing with the instep of both feet on the Mega ProGym tubing, bring the handles up, over the back of your shoulders. Keeping your chin forward and your back straight, with your right foot, step to the right (approximately 12" [31cm]). Slowly flex at your knees, lowering your bottom towards the floor. Bring your feet back to the starting position and repeat the movement going to the left side.



SEATED LAT PULL DOWN

- Door Anchor placed through **HINGE SIDE** of door
- Door Anchor positioned in the **UPPER POSITION**

While seated on the floor, facing the door, grasp the handles with your hands facing downward; reaching up and to the front of your position. Slightly leaning forward at your hips, pull the handles towards your shoulders, insuring that your elbows come toward your sides.



STEP 1



STEP 2

SQUAT ROW

- Door Anchor placed through **HINGE SIDE** of door
- Door Anchor positioned in the **UPPER POSITION**

Facing the door, grasp the handles, insuring that there is tension in the tubes. Slowly lower your rear towards the ground, insuring that you do not go beyond a 90-degree angle in your knees. Return to the starting position. From this position bring the handles toward your chest, finishing the movement with your forearms parallel to the ground.



STEP 1

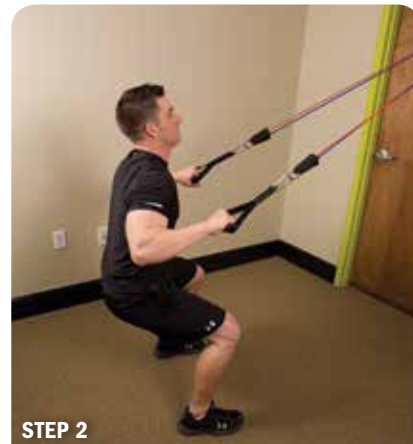

STEP 2

- Door Anchor placed through **HINGE SIDE** of door
- Door Anchor positioned in the **UPPER POSITION**

PADDLER'S ROW



STEP 1



STEP 2

Facing the door, grasp the handles, ensuring that there is equal tension on the tubes. Slightly bend your knees and flex at your hips. With your palms facing toward the floor and your arms straight, bring your hands towards the back of your body in a paddling motion. Keep your chest up and your head forward as your hands come past your hips.

- Door Anchor placed through **HINGE SIDE** of door
- Door Anchor positioned in the **UPPER POSITION**

REVERSE LUNGE

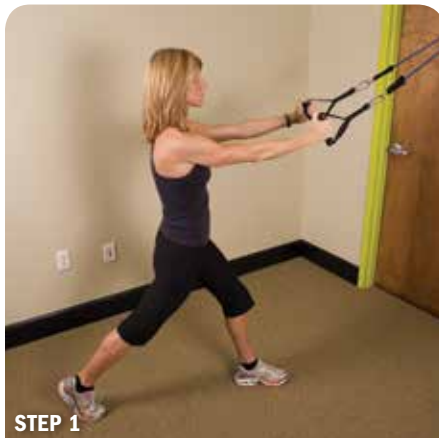

STEP 1

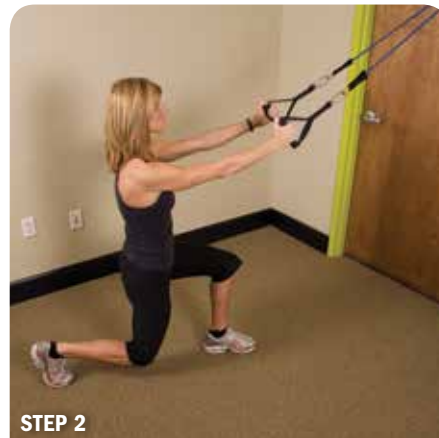

STEP 2

Facing the door, grasp the handles, insuring that there is slight tension in the tubes. Place your back foot to the rear approximately 3' (1 meter) from your front foot. Try and keep your feet pointing forward. Slowly bend at your knees, insuring that both knees flex to 90 degrees. Do not let your back knee touch the ground.

CHEST PRESS

Facing away from the door, position yourself far enough away so that you have slight tension on the tubes. Begin the exercise with elbows bent, palms facing down and the handles at chest level. Squeeze your chest and extend your arms at chest level to the front. Bring your hands close together (6"-12" apart [15cm-31cm]) at the end of the movement.

- Door Anchor placed through **HINGE SIDE** of door
- Door Anchor positioned in the **UPPER POSITION**



STEP 1



STEP 2

POST DELTS HIGH-TO-LOW

(START HIGH – FINISH LOW): Facing the door, grasp the handles, insuring that there is slight tension in the tubes. Position yourself far enough away so that your arms are straight and slightly higher than shoulder height. With your palms facing upward, bring the handles down and towards your hips, insuring your arms stay straight.

- Door Anchor placed through **HINGE SIDE** of door
- Door Anchor positioned in the **UPPER POSITION**



STEP 1



STEP 2



- Door Anchor placed through **HINGE SIDE** of door
- Door Anchor positioned in the **UPPER POSITION**



STEP 1



STEP 2

OVERHEAD TRICEP EXTENSIONS

Facing away from the door, bend at your elbows, grasping the handles with palms facing forward. Handles should be positioned slightly above your ears. While maintaining an upright stance, extend your hands forward, keeping your elbows locked-in near your ears. At the end of the movement your palms should be facing the floor.

- Door Anchor placed through **HINGE SIDE** of door
- Door Anchor positioned in the **UPPER POSITION**



STEP 1



STEP 2

KNEELING AB CRUNCH

While kneeling on both knees, face the door and grasp the handles. Bring the handles to your shoulders. There should be slight tension on the tubes. Flexing at your hips, slowly crunch your upper body forward towards the floor, ensuring that the handles stay at shoulder level. To increase the difficulty, position yourself further away from the door.

STANDING ROWS

- Door Anchor placed through **HINGE SIDE** of door
- Door Anchor positioned in the **MIDDLE POSITION**



While facing the door, stand with feet shoulder-width apart. Using either a neutral (handshake position) or palms-down grip, grasp the handles. Ensuring that there is equal tension on the tubes, slowly bring the handle of one arm back towards your chest, while your other arm stays slightly extended. Bring that arm back to the starting position and repeat the movement on the other side.

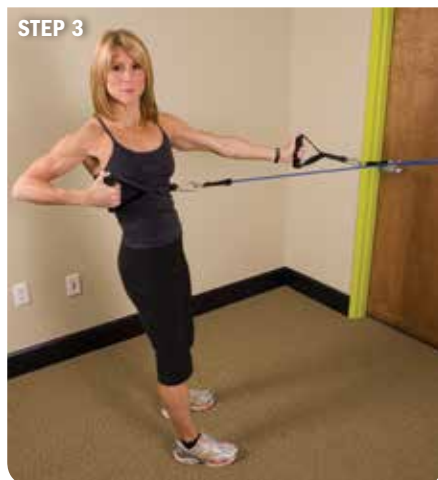

- Door Anchor placed through **HINGE SIDE** of door
- Door Anchor positioned in the **MIDDLE POSITION**

CHEST FLYS



STEP 1



STEP 2

Facing away from the door, position yourself far enough away so that you have slight tension on the tubes. With your palms in a neutral position (facing each other) grasp the handles. Slightly leaning forward, bending from your hips, bring the handles towards the midline of your body in an upward angle (45 degrees) so that the hands finish at chest level with your palms up. Slowly return to the starting position and repeat. This exercise can be done with both arms simultaneously or individually.

- Door Anchor placed through **HINGE SIDE** of door
- Door Anchor positioned in the **MIDDLE POSITION**

TRICEPS KICKBACK



STEP 1



STEP 2

Stand facing the door, bending at your knees and hips. Grasp the handles, keeping your chest over your knees. Elbows should be flexed and positioned to your sides. Extend your elbows, driving your hands back towards the back wall. Ensure that elbows remain high and locked-in at your sides.

OBLIQUE TRUNK TWIST

- Door Anchor placed through **HINGE SIDE** of door
- Door Anchor positioned in the **MIDDLE POSITION**

Attach both ends of the tubes to one handle. Stand facing the door, grasping the handle with both hands. With both hands extended out at shoulder level, having tension in the tubes, twist your entire body to one side—use your obliques to rotate. Your arms should remain straight, your hips squared, and feet planted.



LATERAL RAISES

- Door Anchor placed through **HINGE SIDE** of door
- Door Anchor positioned in the **MIDDLE POSITION**

Facing the door, grasp the handles, ensuring that there is slight tension in the tubes. Position yourself far enough away so that your arms are slightly lower than shoulder level. With your hands facing one another, pull the handles back and outward to your sides while raising them to shoulder height. Bring your hands back to the starting position and repeat.



- Door Anchor placed through **HINGE SIDE** of door
- Door Anchor positioned in the **LOWER POSITION**

CHEST PRESS WITH ROTATION



Facing away from the door, keep tension on the tubes. With feet shoulder-width apart, grasp the handles, palms-in about hip level. Press one arm forward and across the midline of your body, rotating your hand so palm is facing downward. Keep hips stationary as you rotate your upper body. Finish the movement with arm straight and to the outside of your opposite hip. Return to starting position, repeat on the opposite side.

- Door Anchor placed through **HINGE SIDE** of door
- Door Anchor positioned in the **LOWER POSITION**

BICEP CURLS - ANCHORED



Facing the door, grasp the handles, ensuring that there is slight tension in the tubes. Maintaining a straight back and keeping your elbows at your sides, curl the handles toward your shoulders. This exercise can be done with both arms simultaneously or individually.

FRONT RAISES

- Door Anchor placed through **HINGE SIDE** of door
- Door Anchor positioned in the **LOWER POSITION**



Facing away from the door, grasp both handles with your palms facing to the rear. Starting at hip level, bring the handles directly to the front, ending the movement at shoulder level. This exercise can be done with both arms simultaneously or individually.



- Door Anchor placed through **HINGE SIDE** of door
- Door Anchor positioned in the **LOWER POSITION**

ABDOMINAL CRUNCHES

Begin the exercise by lying on your back with your head close to the door. Either bend your knees to 90 degrees or completely lift your legs off the ground. Grasp the handles of the Mega ProGym, keeping your arms straight and to the sides of your body. Slowly crunch your upper body towards your knees, lifting your shoulders off the floor and bringing your hands forward. Keep your chin up and off of your chest when performing this movement.





WARNING



IMPORTANT: Read and follow all warnings and information before using this product, to reduce the risk of serious injury or fatality.

Serious or fatal injury can occur. Exercise Programs of any kind present an inherent danger to the participant. Consult your doctor before beginning any exercise program. All GoFit equipment is intended to be used by adults only in the manner shown/illustrated/described. Anyone under the age of 18 should have constant adult supervision. Always read and follow all warnings and information before use. Always use proper techniques and common sense when exercising. Before each use, check your equipment thoroughly for any signs of damage, defect or wear. If any is found, discontinue use immediately and contact GoFit for assistance. Not intended for commercial use.

Log on to www.gofit.com for more details and product information.

©2016 GoFit, LLC. All rights reserved. No part of this publication may be reproduced or transmitted in any form or by any means, electronic or mechanical, including photocopying, recording, or any other information storage and retrieval system, without the written permission of GoFit, LLC.