

GeekTale

User Manual

Model No.: L-B01/B02

IMPORTANT: Read the instructions carefully before operating the appliance and keep them for future reference.

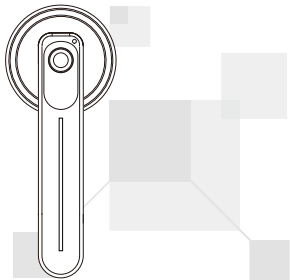

Product Description & Dimention	1
Product packaging	3
Installation instructions	4
How to use	7
Troubleshooting	8
FCC Warning	9
Specifictionst	10

Welcome

GeekTale bids you welcome to a world of smart home devices, smart locks, and smart surveillance. We at GeekTale strive to explore and develop the the smart home industry for the good of all. We combine bridge cutting-edge technologies to develop products fit and ready for the market. Please visit our website www.geektechnology.com

Before installing, please scan the QR codes to watch our easy step-by-step installation video.

If you have questions regarding the installation process please contact us by mail service_lock@geektechnology.com or by phone 1-844-801-8880/(862) 352-0406.



Product Description

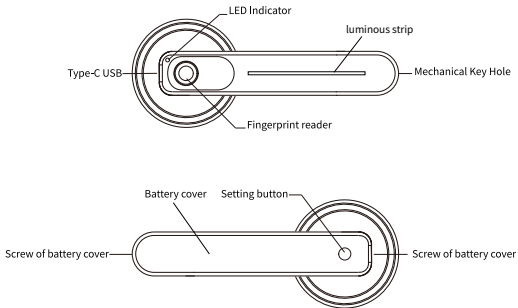

Product Dimension

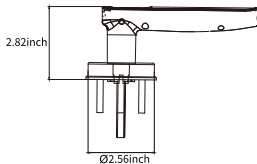
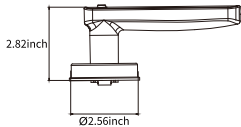
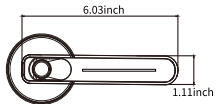
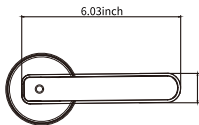

Preparing For Installation

Include in the box



A. Exterior handle



B. Interior handle



C. Latch



D. Strike parts



E. Keys



F. Screws A x4



G. Screws B x4
(Two screws are backup)



H. Rubber Gasket



I. Type-C USB



$2\frac{3}{8}''$ (60mm)



$2\frac{3}{4}''$ (70mm)

Check the Dimensions & Install the latch

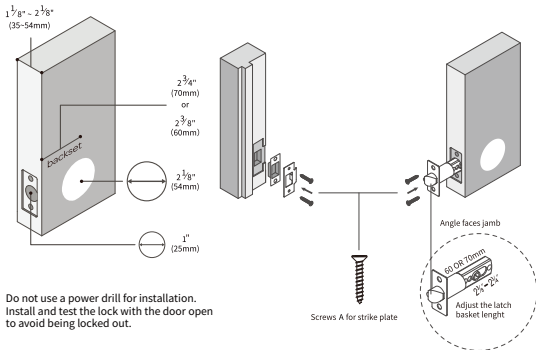

Installing Exterior Handle

Remember to attach rubber gasket to handle before insertion.

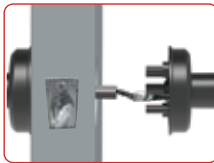
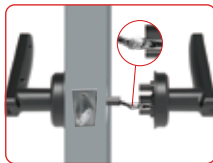
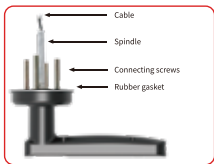

Installing Battery

1. Insert 4*AAA batteries according to positive and negative pole.
Please do not load the Lithium Batteries or Rechargeable Batteries.

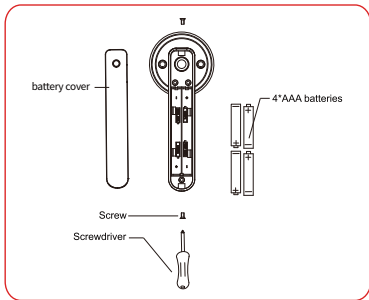

Lock Operation

How to add fingerprint?

Press the setting button on the interior handle. You will be asked to scan your fingerprint 6 times.

The first 2 fingerprint added are administrators. Adding new fingerprint needs to scan the administrator's fingerprint to verify besides the first one added.

How to enable the passage mode?

Scan administrator's fingerprint, Press the button on the interior handle when the lock is unlocked.

How to disable the passage mode?

Press the button on the interior handle twice.

How to delete fingerprint?

Press the setting button on the interior handle 3 times. Verify administrator fingerprint, then scan the fingerprint which you want to delete

How to enable or disable silent mode?

Press the setting button on the interior handle 4 times.

How to check the battery level?

Press the setting button on the interior handle 5 times.

How to reset the lock?

Long press the setting button on the interior handle for seconds until you hear the voice prompt "Please long press the setting button to initialize", then remove your finger and long press the setting button until you hear the prompt again.

Troubleshooting

Q: After the door lock is installed, there is no response or abnormal behaviour.

A: Please check as follows:

- ① Check the battery installation direction and make sure that the battery has sufficient power.

Q: Any fingerprint can unlock the lock.

A: The lock was reset/in the default resetting or adding administrator fingerprint unsuccessfully, please make sure the fingerprint was added successfully after installing.

Q: The fingerprint recognition success rate is different from what the manual says.

A: ① When entering the fingerprint, please try to move the position of the fingertip slightly every time you enter the fingerprint, so that you can enter a larger fingerprint area. Please try to cover areas that are frequently used.

- ② Fingers are too dry, wet, oily or dirty.
- ③ There is direct sunlight on the sensor.

Q: What prompt will I receive when the battery is low?

A: ① Low power, there will be a voice reminder "low battery, please replace the battery" when unlocking every times.

- ② The remaining power can be provided about 100 times to unlock, please replace battery in time

Q: What should I do if the battery is totally dead?

A: There is a Type-c port at the head of the front handle. You can use this interface to temporarily power the door lock through a power bank etc.

Q: I can't find the model of lock on the app.

A: This fingerprint lock does not use an app to save fingerprints or operate. Fingerprints are stored locally.

FCC Warning

Any Changes or modifications not expressly approved by the party responsible for compliance could void the user's authority to operate the equipment.

Note: This equipment has been tested and found to comply with the limits for a Class B digital device, pursuant to part 15 of the FCC Rules.

These limits are designed to provide reasonable protection against harmful interference in a residential installation. This equipment generates uses and can radiate radio frequency energy and, if not installed and used in accordance with the instructions, may cause harmful interference to radio communications. However, there is no guarantee that interference will not occur in a particular installation.

If this equipment does cause harmful interference to radio or television reception, which can be determined by turning the equipment off and on, the user is encouraged to try to correct the interference by one or more of the following measures:

- Reorient or relocate the receiving antenna.
- Increase the separation between the equipment and receiver.
- Connect the equipment into an outlet on a circuit different from that to which the receiver is connected.
- Consult the dealer or an experienced radio/TV technician for help.

This device complies with part 15 of the FCC Rules. Operation is subject to the following two conditions: (1) This device may not cause harmful interference, and (2) this device must accept any interference received, including interference that may cause undesired operation.

Specifications

Name	Description
Power Supply	4 PCS AAA 1.5V Battery
USB Interface	Type-c
Unlock Mode	Fingerprint,Key
Fingerprint Capacity	20Max
Fingerprint Pixels	508dpi
Identification Speed	0.25 sec
False Positive Rate	<0.001%
Rejection Rate	<1%
Working Temperature	-20~70°C
Working Humidity	40%~85%(no condensation)
Low power warrinning	± 4.8V
Static power	<50uA
Dynamic power	<200mA



GeekTale

Bring The Future Home

GEEK TECHNOLOGY CO.LTD.
120 Route 46 West,
Parsippany, NJ 07054.
Toll Free
1-844-801-8880
(862)352-0406