

USER GUIDE • GUIDE DE L'UTILISATEUR



INFILTRATE™ KL2 MULTI-COLOR LED GAMING KEYBOARD

REGISTER NOW



ENREGISTRER

This product comes with a 1 year limited warranty.

Register this product within 30 days of sale to activate a complimentary 2 year warranty extension and receive free advanced technical support. Learn more and register now.

Ce produit a une garantie limitée de 1 an.

Enregistrez ce produit dans les 30 jours suivant son achat pour activer l'extension de garantie de 2 ans et bénéficier de notre service après-vente gratuit. Pour en savoir plus, enregistrez ce produit dès à présent.

[ENHANCEgaming.com/warranty](https://www.enhancegaming.com/warranty)

BECOME A VIP



Free Product Giveaways

Exclusive Discounts

Sneak Peek at New Products

And More VIP Perks!

AccessoryPower.com/VIPclub

IN LESS THAN 30 SECONDS

LIKE US ON FACEBOOK



Join Our Community
and Stay Up-To-Date
with News & Promotions

[Facebook.com/AccessoryPower](https://www.facebook.com/AccessoryPower)



**Need help with this product?
Besoin d'assistance sur ce produit?
¿Necesita ayuda con este producto?
Benötigen Sie Hilfe bei diesem Produkt?
Hai bisogno di aiuto per questo prodotto?
购买的产品 · 是否需要提供协助？**

[ENHANCEgaming.com/support](https://www.enhancegaming.com/support)

PRODUCT COMFORT NOTICE: NOTICE DE CONFORT:

Long period of repetitive motion using this product may be associated with nerve, tendon, or muscle injury in your hands, wrists, arms, shoulders, neck, or back. If you experience symptoms such as persistent or recurring discomfort, pain, throbbing, aching, tingling, numbness, burning sensation, or stiffness you should see a qualified health professional. Please read guidelines at www.enhancegaming.com/comfort.

Une utilisation répétitive et prolongée de ce produit peut entraîner des douleurs au niveau des nerfs, tendons ou musculaires au niveau des mains, poignets, épaules, du cou ou du dos. Si vous présentez des symptômes tels que de l'inconfort, de la douleur, des palpitations, des sensations de picotements, d'engourdissement, de brûlure ou de rigidité, persistants ou récurrents, consultez votre docteur. Consultez les instructions d'utilisation sur www.enhancegaming.com/comfort

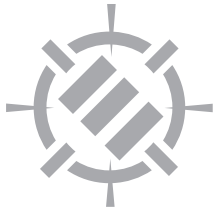

ENHANCE®



INFILTRATE™ KL2

MULTI-COLOR LED GAMING KEYBOARD

Product diagram
Schéma du produit
Diagrama de product
Producttabbildung
Schema del prodotto

产品图



EN

- 1 Multimedia keys
- 2 Device holder
- 3 USB cable
- 4 Win key
- 5 LED illumination key
- 6 FN (function) key

FR

- 1 Touches multimédias
- 2 Support d'appareil
- 3 Câble USB
- 4 Touche Win
- 5 Touche d'éclairage DEL
- 6 Touche (fonction) FN

ES

- 1 Teclas multimedia
- 2 Portadispositivo
- 3 Cable USB
- 4 Tecla Win
- 5 Tecla iluminación LED
- 6 Tecla FN (función)

DE

- 1 Multimediatasten
- 2 Gerätehalter
- 3 USB-Kabel
- 4 Windowstaste
- 5 LED-Beleuchtungs-Taste
- 6 FN-Taste (Funktionstaste)

IT

- 1 Tasti multimediali
- 2 Supporto dispositivo
- 3 Cavo USB
- 4 Tasto Windows
- 5 Tasto illuminazione LED
- 6 Tasto FN (funzione)

ZN

- 1 多媒体键
- 2 设备支架
- 3 USB 线
- 4 Win 键
- 5 LED 发光键
- 6 功能 (fn) 键

Operating instructions

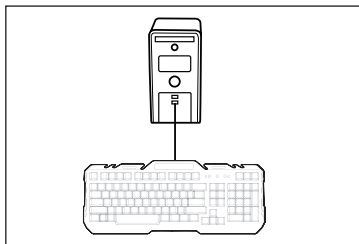

While your computer is running, insert the USB plug. The drivers will automatically install. After being notified that the driver installation is complete, the keyboard is ready for use.

Key Combination		Function
FN + F1		Media player
FN + F2		Volume down
FN + F3		Volume up
FN + F4		Mute
FN + F5		Stop
FN + F6		Previous track
FN + F7		Play/Pause
FN + F8		Next track
FN + F9		Email
FN + F10		Internet home
FN + F11		Keyboard lock
FN + F12		Calculator
LED icon		LED color modes or Off
FN + LED icon		Color breathing
FN + -		Decrease breathing
FN + +		Increase breathing
FN + Page up		Increase brightness
FN + Page down		Decrease brightness
FN + Q		62 characters/second input
FN + W		WASD/arrow key swap
FN + Windows		Windows key lock/unlock

Mode d'emploi

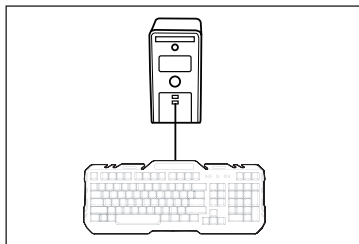

Lorsque votre ordinateur fonctionne, insérez la prise USB. Les pilotes seront installés automatiquement. Une fois reçue la notification que l'installation du pilote est achevée, le clavier est prêt à être utilisé.

Key Combination		Function
FN + F1		Lecteur multimédia
FN + F2		Volume BAS
FN + F3		Volume HAUT
FN + F4		Muet
FN + F5		Arrêter
FN + F6		Piste précédente
FN + F7		Lecture/Pause
FN + F8		Piste suivante
FN + F9		Courriel
FN + F10		Accueil Internet
FN + F11		Verrouillage du clavier
FN + F12		Calculatrice
LED icon		Modes DEL couleur ou éteint
FN + LED icon		Respiration des couleurs
FN + -		Diminuer la respiration
FN + +		Augmenter la respiration
FN + Page up		Augmenter la luminosité
FN + Page down		Diminuer la luminosité
FN + Q		Entrée de 62 caractères/seconde
FN + W		WASD/échange de touches fléchées
FN + Windows		Windows verrouiller / déverrouiller

Instrucciones de Operación

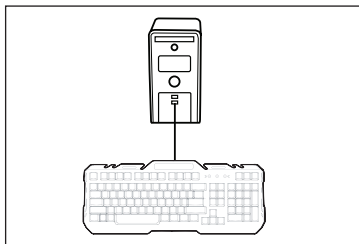

Conecte el cable USB con el ordenador encendido. Los controladores se instalarán automáticamente. Después de recibir la notificación de que la instalación del controlador ha finalizado, el teclado estará listo para su uso.

Bedienungsanleitung

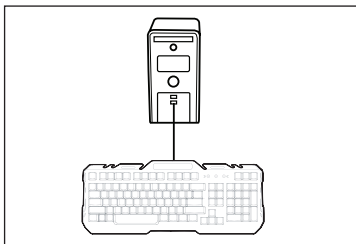

Stecken Sie, während Ihr Rechner läuft, den USB-Stecker ein. Die Treiber installieren sich automatisch. Nachdem Sie benachrichtigt wurden, dass die Installation der Treiber abgeschlossen ist, ist die Tastatur einsatzbereit.

Key Combination		Function
FN + F1		Reproductor multimedia
FN + F2		Bajar volumen
FN + F3		Subir volumen
FN + F4		Silenciar
FN + F5		Parar
FN + F6		Pista anterior
FN + F7		Reproducir/Pausar
FN + F8		Siguiente pista
FN + F9		Correo electrónico
FN + F10		Internet Home
FN + F11		Bloqueo de teclado
FN + F12		Calculadora
LED icon		Modos color LED o Apagar
FN + LED icon		Breathing de colores
FN + -		Reducir breathing
FN + +		Aumentar breathing
FN + Page up		Aumentar brillo
FN + Page down		Reducir brillo
FN + Q		Entrada 62 caracteres/segundo
FN + W		Cambio teclas WASD/flechas
FN + Windows		Bloquear/desbloquear tecla Windows

Key Combination		Function
FN + F1		Mediaplayer
FN + F2		Lautstärke verringern
FN + F3		Lautstärke erhöhen
FN + F4		Stumm schalten
FN + F5		Anhalten
FN + F6		Vorheriger Track
FN + F7		Play/Pause
FN + F8		Nächster Track
FN + F9		E-Mail
FN + F10		Internet Home
FN + F11		Tastatursperre
FN + F12		Taschenrechner
LED icon		LED-Farbmodi oder AUS
FN + LED icon		Farbatmung
FN + -		Atmung verringern
FN + +		Atmung erhöhen
FN + Page up		Helligkeit erhöhen
FN + Page down		Helligkeit verringern
FN + Q		62 Zeichen/zweite Eingabe
FN + W		WASD-/Pfeiltasten-Tausch
FN + Windows		Windowstaste sperren/entsperren

Istruzioni operative

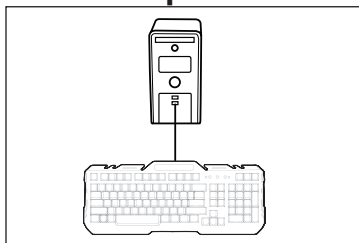

Mentre il computer è in esecuzione, inserisci la presa USB. I driver verranno installati automaticamente. Dopo aver ricevuto la notifica del completamento dell'installazione dei driver, la tastiera è pronta all'uso.

操作指令

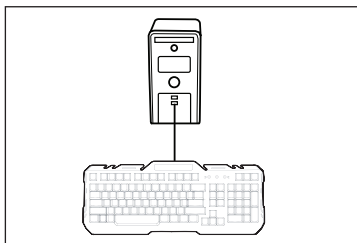

在您的电脑运行时，插入USB插头。驱动程序将自动安装。在通知驱动程序安装完成后，键盘即可使用。

Key Combination		Function
FN + F1		Lettore multimediale
FN + F2		Abbassa volume
FN + F3		Alza volume
FN + F4		Silenzioso
FN + F5		Stop
FN + F6		Traccia precedente
FN + F7		Play/Pausa
FN + F8		Traccia seguente
FN + F9		E-mail
FN + F10		Home Internet
FN + F11		Blocco tastiera
FN + F12		Calcolatrice
LED icon		Modalità LED a colori o Off
FN + LED icon		Colore effetto respiro
FN + -		Diminuisci respiro
FN + +		Aumenta respiro
FN + Page up		Aumenta luminosità
FN + Page down		Diminuisci luminosità
FN + Q		Input 62 caratteri/secondo
FN + W		WASD/scambio tasti freccia
FN + Windows		Blocco/sblocco tasto Windows

Key Combination		Function
FN + F1		媒体播放器
FN + F2		降低音量
FN + F3		提高音量
FN + F4		静音
FN + F5		停止
FN + F6		上一首曲目
FN + F7		播放/暂停
FN + F8		下一首曲目
FN + F9		电子邮件
FN + F10		互联网首页
FN + F11		键盘锁
FN + F12		计算器
LED icon		LED 颜色模式开关
FN + LED icon		颜色呼吸
FN + -		减少呼吸
FN + +		增加呼吸
FN + Page up		增加亮度
FN + Page down		降低亮度
FN + Q		输入 62 字符/秒
FN + W		WASD / 箭头键切换
FN + Windows		Windows 键锁定/解锁

Product specifications

Spécifications du produit

Especificaciones del producto

Produktspezifikationen

Specifiche del prodotto

产品规格

Switch: Quiet membrane

Key rollover: 19KRO (19 keys)

Features: Anti-ghosting, adjustable input speed, WASD/arrow swap

Color mode: Multi-color

LED effects: Solid multi-color or breathing mode

Power input: 5V = 0.7A

Braided USB cable length: 70 inches

Dimensions: 17.5 x 7 x 0.98 inches

Weight: 1.87 pounds

Commutateur: membrane silencieuse

Remplacement de clé: 19KRO (19 clés)

Caractéristiques: Anti-ghosting, vitesse d'entrée réglable, WASD / changement de flèches

Mode couleur: multicolore

Effets LED: mode multicolore permanent ou par pulsation

Puissance absorbée: 5V = 0.7A

Longueur du câble USB tressé: 178 cm

Dimensions: 44,5 x 17,8 x 2,5 cm

Poids: 848 g



FCC Compliance Notice

FCC Compliance Notice This equipment has been tested and found to comply with the limits for a class B digital device, pursuant to part 15 of the FCC Rules. These limits are designed to provide reasonable protection against harmful interference in a residential installation. This equipment generates, uses and can radiate radio frequency energy and if not installed and used in accordance with the instructions, may cause harmful interference to radio communications. However, there is no guarantee that interference will not occur in a particular installation. If this equipment does cause harmful interference to radio or television reception, which can be determined by turning the equipment off and on, the user is encouraged to try to correct the interference by one or more of the following measures:

- Reorient or relocate the receiving antenna.
- Increase the separation between the equipment and receiver.
- Connect the equipment into an outlet on a circuit different from that to which the receiver is connected.
- Consult the dealer or an experienced radio/TV technician for help.

WARRANTY GARANTIE GARANTÍA



GARANTIE GARANZIA 保固

This product comes with a 1 year limited warranty, the acceptance of which is a condition of sale. Register this product within 30 days of sale to activate a complimentary 2 year warranty extension and receive free advanced technical support. For warranty program details, registration, and support visit ENHANCEgaming.com/warranty

Ce produit à une garantie limitée de 1 an, la condition étant son achat. Enregistrer ce produit dans les 30 jours suivant son achat pour activer l'extension de garantie de 2 ans et bénéficier de notre service après-vente gratuit. Pour en savoir plus sur l'enregistrement et le service après-vente allez sur ENHANCEgaming.com/warranty

Este producto viene con una garantía limitada de 1 año, la aceptación de que es una condición de la venta. Registrar este producto dentro de los 30 días de la venta para activar una extensión de cortesía 2 años de garantía y recibir soporte técnico avanzado libre. Para los detalles del programa de garantía, el registro, y una visita de apoyo ENHANCEgaming.com/warranty

Dieses Produkt kommt mit einer 1-Jahres-Garantie, deren Annahme ist eine Bedingung des Verkaufs. Registrieren Sie dieses Produkt innerhalb von 30 Tagen den Verkauf an ein kostenloses 2 Jahre Garantie-Erweiterung zu aktivieren und erhalten kostenlose erweiterte technische Unterstützung. Für Garantie-Programm Details, Registrierung und Support Besuch ENHANCEgaming.com/warranty

Questo prodotto viene fornito con una garanzia limitata di 1 anno, la cui accettazione è una condizione di vendita. Registra questo prodotto entro 30 giorni di vendita per attivare tutte le mattine una estensione di garanzia di 2 anni e di ricevere supporto tecnico avanzato gratuito. Per i dettagli del programma di garanzia, la registrazione e supporto visitate ENHANCEgaming.com/warranty

本产品带有1年有限保修的销售承诺。在购买后30天内注册本产品将获赠2年延长保修及得到免费高级技术支持。关于保修流程的细节、注册和支持，请访问 ENHANCEgaming.com/warranty

Windows® is a registered trademark of Microsoft Corporation in the United States and/or other countries.

© 2019 AP Global, Inc. All rights reserved. Accessory Power, the Accessory Power logo, ENHANCE, the ENHANCE logo, Infiltrate and other marks and logos are either registered trademarks or trademarks of AP Global in the United States and/or other countries. All other trademarks are the property of their respective owners.

Manufactured in China. Designed in California.

Windows® est une marque déposée de Microsoft Corporation aux États-Unis et/ou dans d'autres pays.

© 2019 AP Global, Inc. Tous droits réservés. Accessory Power, le logo Accessory Power, ENHANCE, le logo ENHANCE, Infiltrate et les autres marques et logos sont des marques déposées ou des marques de AP Global aux États-Unis et/ou dans d'autres pays. Toutes les autres marques sont la propriété de leurs propriétaires respectifs.

Fabriqué en Chine. Conçu en Californie.



[YouTube.com/AccessoryPower](https://www.youtube.com/AccessoryPower)



[Facebook.com/AccessoryPower](https://www.facebook.com/AccessoryPower)



[Instagram.com/AccessoryPower](https://www.instagram.com/AccessoryPower)



ENHANCE

MULTI-COLOR LED GAMING KEYBOARD

MODEL NUMBER: ENINKL2100BKUS

ENHANCEgaming.com/recycle

