

Go to www.vtechphones.com to register your product for enhanced warranty support and the latest VTech product news.

VM320
VM320-2
Video Monitor



vtech

Quick start guide

Specifications are subject to change without notice.
© 2020 VTech Communications, Inc. VM320-2_GSG_VZ

WHAT'S IN THE BOX

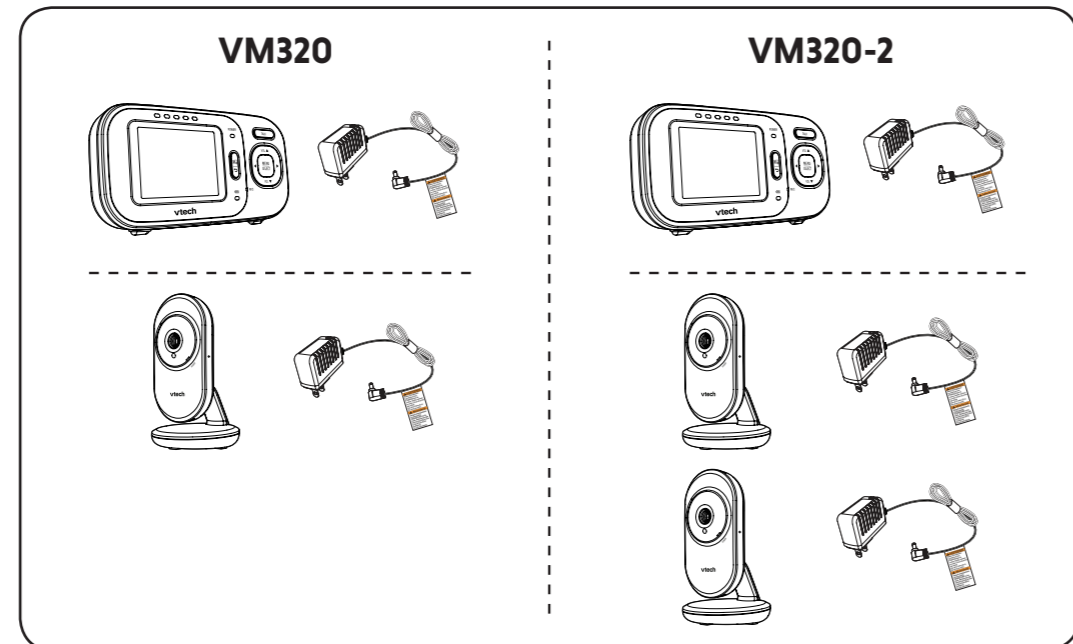

1 CONNECT THE BABY MONITOR

NOTES

- The rechargeable battery is pre-installed in your parent unit.
- Use only the power adapters supplied with this product.
- Make sure the baby monitor is not connected to an electric outlet that is controlled by a switch.
- Connect the power adapters in a vertical or floor mount position only. The adapters' prongs are not designed to hold the weight of baby monitor, so do not connect them to any ceiling, under-the-table, or cabinet outlets. Otherwise, the adapters may not properly connect to the outlets.
- Make sure the parent unit, the baby unit and the power adapter cords are out of reach of children.

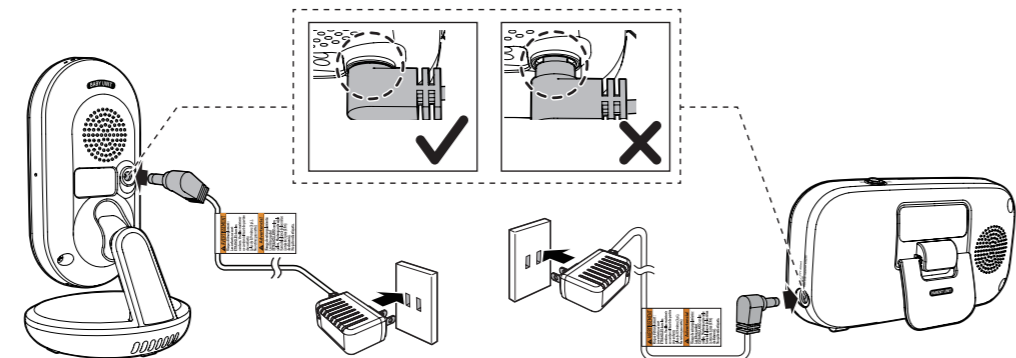

2 POWER ON OR OFF THE BABY MONITOR

- Slide the **ON/OFF** switch to power on or off your baby unit.
- Slide the **ON/OFF** switch to power on or off your parent unit.

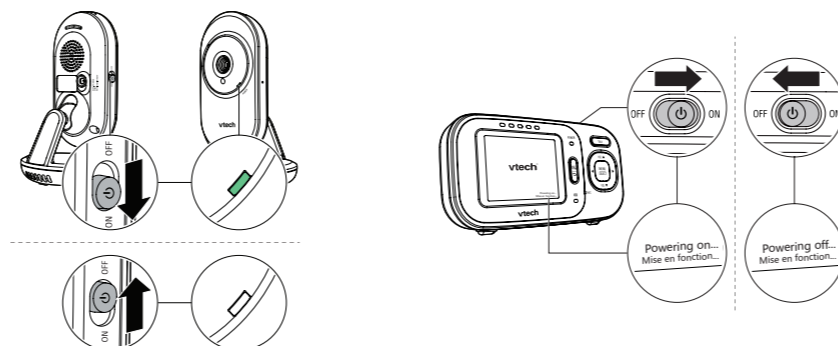

3 POSITIONING THE BABY MONITOR

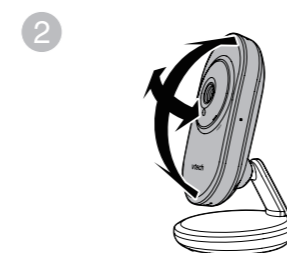

CAUTION

- The default volume of your parent unit is level 3, and the maximum volume is level 5. If you experience high-pitched screeching noise from your baby monitor while positioning:
 - Make sure your baby unit and parent unit are more than 1 meter (3 feet) apart, OR
 - Turn down the volume of your parent unit.

NOTE

- To avoid interference from other electronic devices, place your baby monitor at least 3 feet (1 meter) away from devices such as wireless routers, microwaves, cell phones and computers.

4 STATUS CHECK

Once you power on both your baby unit and parent unit, your parent unit displays image from the baby unit, and the connection status displays on the LCD screen.

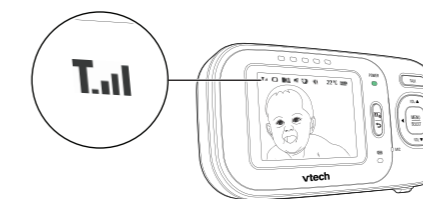

The **POWER** LED light of baby unit turns on.

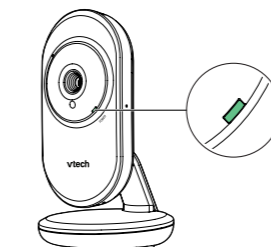

BASIC OPERATION - PARENT UNIT

Adjust speaker volume

Press **VOLA / VOLV** to adjust your parent unit speaker volume.

The sound sensitivity setting also affects the speaker volume. For details, refer to **Sound sensitivity and sound activation**.

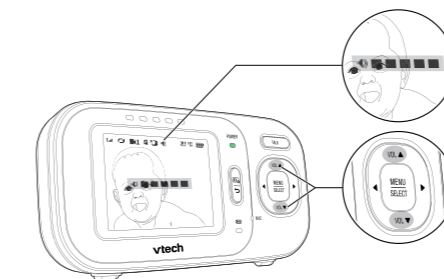

Set screen off timer

- Press **MENU/SELECT** to enter the main menu when the parent unit is idle.
- Press **◀** or **▶** to choose **⏻**, then press **MENU/SELECT** or **▲** to open the submenu.
- Press **▲** or **▼** to choose the desired time period to automatically turn off screen (**OFF** / **5 min.** - 5 min. / **30 min.** - 30 min. / **60 min.** - 60min.), then press **MENU/SELECT** to confirm your selection.

NOTE

- Press any keys on the parent unit to turn on the screen again.

LCD off

Press **⏻** to turn off LCD and keep the sound broadcast.

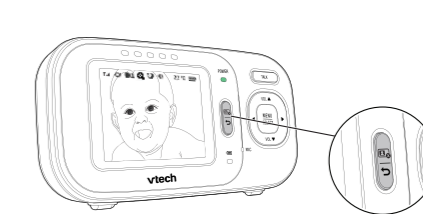

Talk to your baby unit

Press and hold **TALK** and speak to your parent unit. Your voice is transmitted to the baby unit.

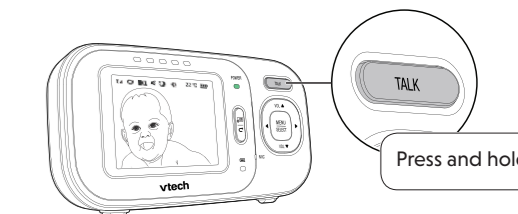

Use the menu

Press **MENU/SELECT** to enter the menu, choose a menu item, or save a setting. You can use the parent unit for advanced settings or operations, such as to adjust the baby unit sound sensitivity or the temperature range for alerts.

While in the menu:

- Press **◀** or **▶** to scroll among the main menu options.
- Press **MENU/SELECT** to choose a submenu item, or save a setting.
- Press **▲** or **▼** to scroll among the submenu options.
- Press **⏻** to exit the main menu or submenu.

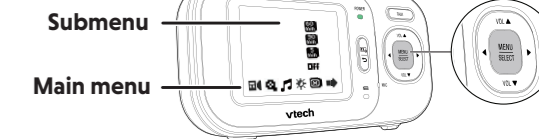

OVERVIEW - PARENT UNIT

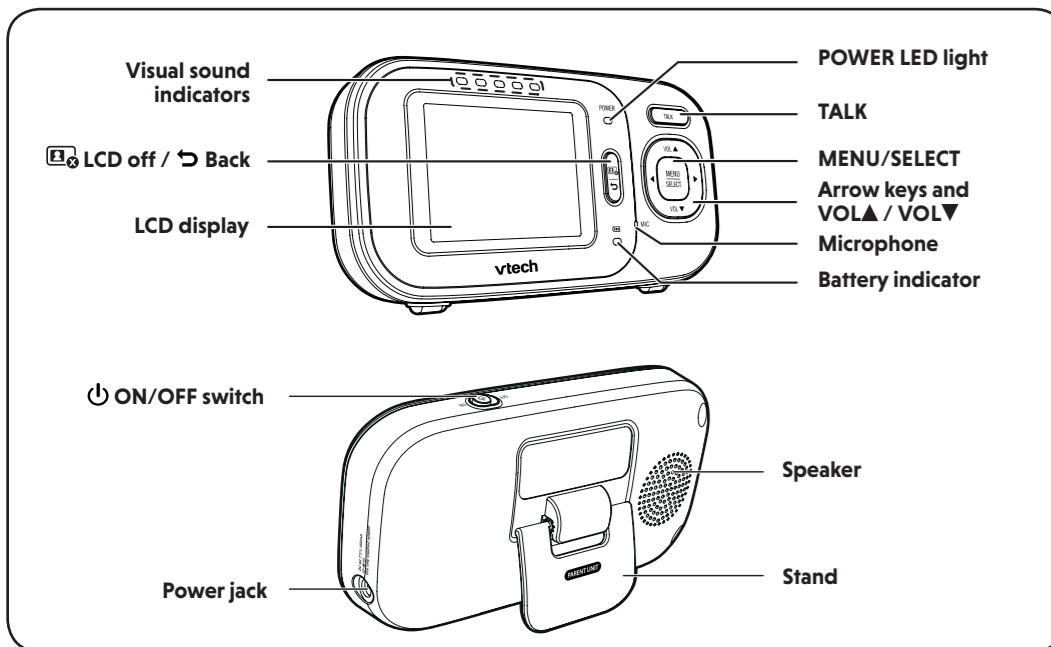

SOUND SENSITIVITY AND SOUND ACTIVATION

Adjust sound detection sensitivity

With sound sensitivity setting, you can choose to hear sounds from the baby unit all the time, or to hear sounds that exceed a certain level.

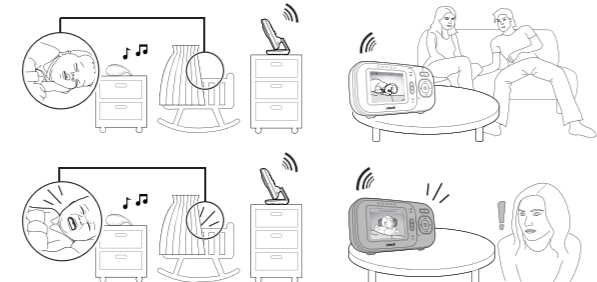
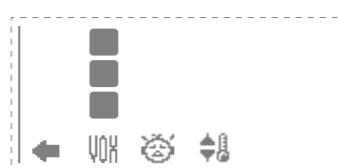

| Parent unit setting | What happens... | You may experience... | What you could do... |
|--------------------------------|--|---|--|
| Speaker volume: Low | Hear all sounds all the time, including background sounds. | Difficulty in hearing your baby's soft sounds if the background sounds are louder. | <ul style="list-style-type: none"> Increase parent unit's speaker volume, and lower sound sensitivity. If you are using a white noise machine or sound machine, set its volume to low, or relocate it to minimize background sounds. |
| Sensitivity: Highest [Default] | | | |
| Speaker volume: MAX | Only hear sounds that exceed the selected sound sensitivity level. | No sound; or sounds that cut in and out at times as the baby unit may not detect extra soft sounds. | Increase the sound sensitivity, and adjust the volume level if necessary. |
| Sensitivity: Low / Medium | | | |

For details, please see **Adjust the sound sensitivity of the baby unit** in the User's manual.

Sound activated screen

When sound activation is on, the parent unit screen stays off to save power when the baby unit detects no sound.

Once the baby unit detects sounds that are louder than the chosen sound sensitivity level, the parent unit screen turns on automatically. It will then turn off again after 50 seconds of no sound detection.

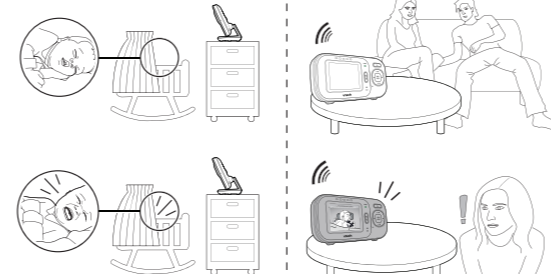

OVERVIEW - BABY UNIT

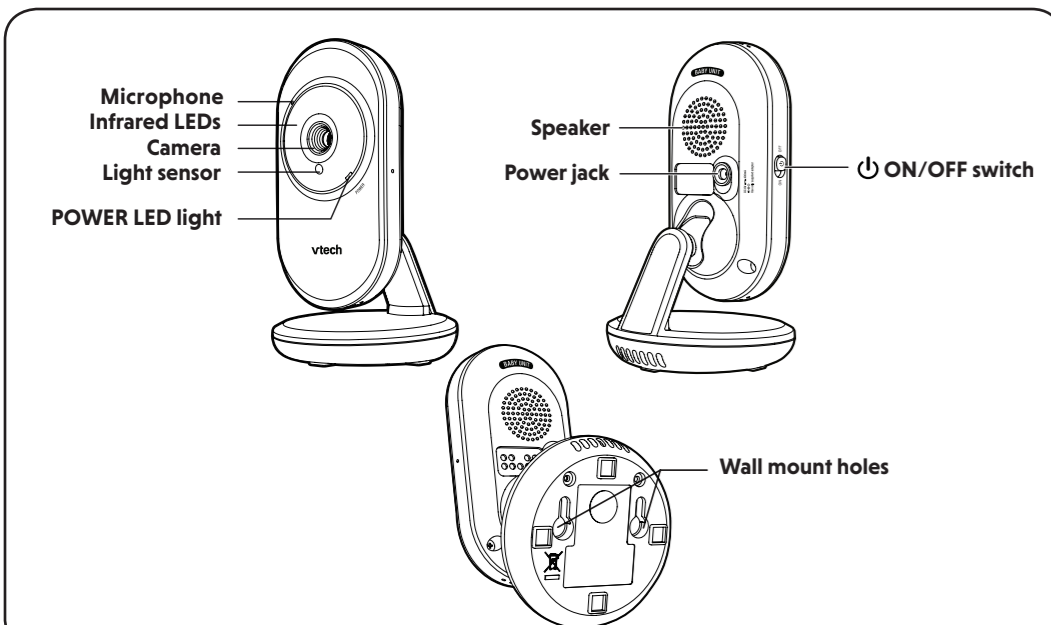

NIGHT VISION

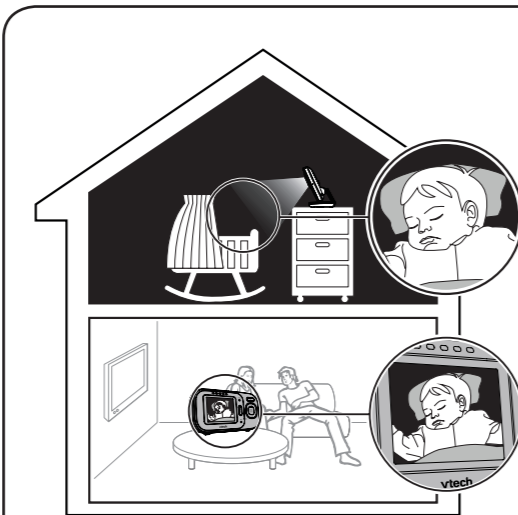

The baby unit has infrared LEDs that allow you to see your baby clearly at night or in a dark room. When the baby unit being viewed detects low light levels, the infrared LEDs are switched on automatically. The images from the baby unit are in black and white, and appears on the screen.

NOTES

- It is normal if you see a short white glare on your parent unit screen as the baby unit is adapting to the dark environment.
- When the infrared LEDs are on, the images are in black and white. This is normal.

TIP

- Depending on the surroundings and other interfering factors, like lightings, objects, colors and backgrounds, the display resolution may vary. Adjust the baby unit's angle or place the baby unit at a higher level to prevent glare and blurry display.

MOUNT THE BABY UNIT ON DRY WALL (OPTIONAL)

Items to purchase

You will need to purchase the following items separately to mount your baby unit:

- 2 screws
- 2 anchors

NOTE

- The types of screws and anchors you need depend on the composition of the wall.

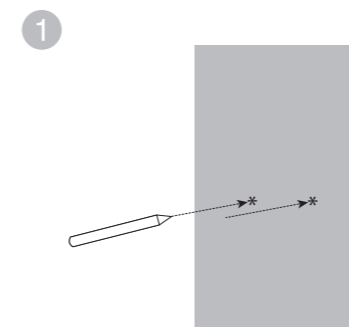

NOTE

- Check for reception strength and camera angle before drilling the holes.
- Use a pencil to mark two holes in parallel. Make sure they are the same distance apart as the wall mount holes on the baby unit.

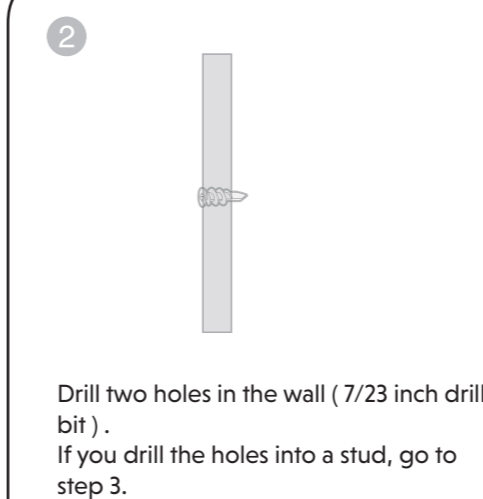

-OR-
If you drill the holes into an object other than a stud, insert the wall anchors into the holes. Tap gently on the ends with a hammer until the wall anchors are flush

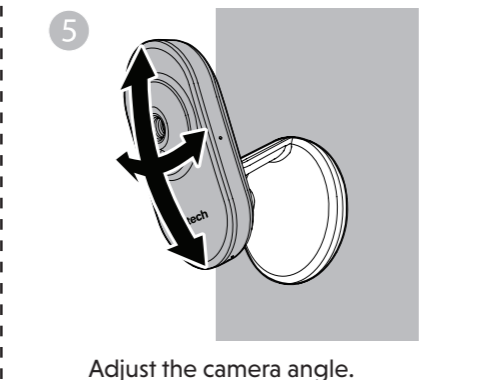
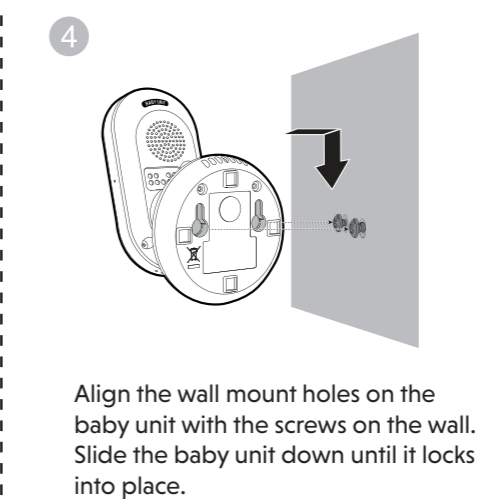

FOR VM320-2 ONLY

Status check - Two baby units

If you are viewing baby unit **1**, the **POWER LED** light of baby unit **1** turns on. As baby unit **2** is not being viewed, its **POWER LED** light flashes.

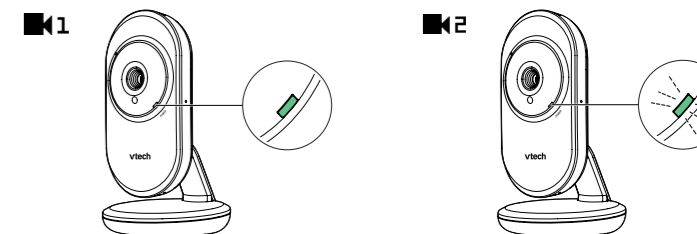

NOTE

- If you power on only one baby unit, your parent unit may display **1** and the **POWER LED** light flashes. Press **MENU/SELECT** and then **◀** or **▶** to choose **1**. Press **MENU/SELECT** or **▲** to open the submenu. Press **▲** or **▼** to select the baby unit you have powered on.

Change different views - Patrol

Press **MENU/SELECT** and then **◀** or **▶** to choose **1**. Press **MENU/SELECT** or **▲** to open the submenu. After that, press **▲** or **▼** to select **1** to enter **PATROL** mode to alternately view the image from one baby unit to the next one in every 10 seconds.

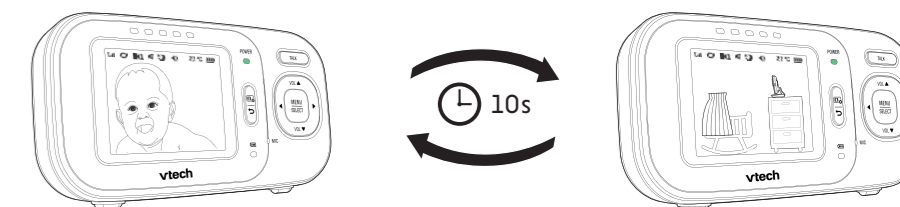

Change different views - Single-cam

Press **MENU/SELECT** and then **◀** or **▶** to choose **1**. Press **▲** to open the submenu. After that, press **▲** or **▼** to select a camera number to enter **SINGLE-CAM** mode.

