

ULTIMEA

HDMI™
HIGH-DEFINITION MULTIMEDIA INTERFACE

Bluetooth®



User Manual

Nova S40

EN: User Manual

DE: Benutzerhandbuch

JP: ユーザーマニュアル

FR: Manuel de l'Utilisateur

IT: Manuale d'uso

ES: Manual del usuario

Model No.: U2100

Nova S40 2.1 Channel Soundbar with Separate Subwoofer

Contents

01	User Manual	English
	Connection and Installation	02
05	Benutzerhandbuch	Deutsch
	Anschluss und Installation	06
09	ユーザーマニュアル	日本語
	接続と設置	10
13	Mode d'Emploi	Français
	Raccordement et installation	14
17	Manuale d'uso	Italiano
	Connessione e installazione	18
21	Manual del usuario	Español
	Conexión e instalación	22

User Manual

WE ARE
READY
TO HELP



support@ultimea.com



Model No.: U2100

Prefer video tutorial?

Setup guidance video, USER MANUAL or Trouble Shooting on ULTIMEA website.



support.ultimea.com

+1 888-598-8875 (US) Mon-Fri 9am-5pm (PST)
+49 89-628-25828 (EU) Mon-Fri 9am-5pm (CET)

1 ACCESSORIES LIST

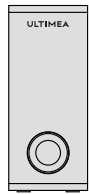

Subwoofer



Soundbar



Power Adaptor

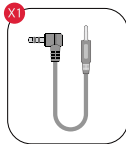

Stereo 3.5mm to 3.5mm Audio Cable

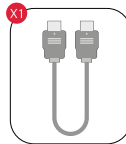

HDMI Cable

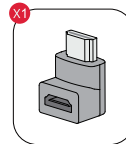

HDMI Adaptor

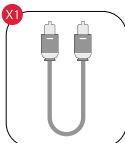

Digital Optical Cable



Remote Control

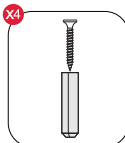

Wall Mounted Kit

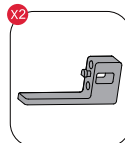

Wall Bracket



User Manual

2 SOUNDBAR CONTROLS

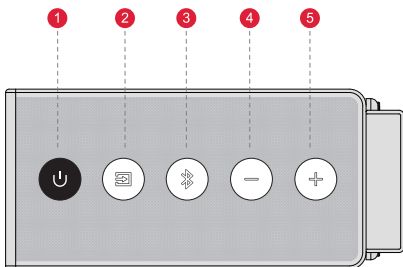

Control Panel

- 1 "⏻": **Power Button**
Press to power on / Hold for 3 seconds to power off.
- 2 "📺": **Input Mode**
Press to switch channels: ARC-OPT(OPTICAL)-BT-AUX-USB.
- 3 "📶": **BT**
Press to switch to Bluetooth channel and enter pairing mode. Hold for 3 seconds to disconnect the current device and connect to a new device manually on your mobile phone / PC / TV (BT ID: Nova S40).
- 4 "⏪": **Volume Down**
- 5 "⏩": **Volume Up**

Remote Control

- 1 “⏻”: **Power Button**
Press to power on / Hold for 3 seconds to power off.
- 2 “ARC”: **ARC**
Press to switch to ARC channel.
- 3 “📶”: **BT**
Press to switch to Bluetooth channel and enter pairing mode. Hold for 3 seconds to disconnect the current device and connect to a new device manually on your mobile phone / PC / TV (BT ID: Nova S40).
- 4 “📺”: **OPT**
Press to switch to OPTICAL channel.
- 5 “🎧”: **AUX**
Press to switch to AUX channel.
- 6 “💡”: **LED**
Press to turn on the LED, press again to turn off.
- 7 “🔌”: **USB**
Press to switch to USB channel.
- 8 “+”: **Volume Up**
- 9 “-”: **Volume Down**
- 10 “<”: **Previous**
For BT and USB mode only: Skip to previous track.
- 11 “>”: **Next**
For BT and USB mode only: Skip to next track.
- 12 “▶||”: **Play / Pause**
For BT and USB mode only.
USB mode: Hold for 3 seconds to switch between single loop playback and list loop playback.
- 13 “MOVIE”: **MOVIE**
Press to switch to MOVIE mode, the display will show: “E9 1”.
- 14 “GAME”: **GAME**
Press to switch to GAME mode, the display will show: “E9 2”.
- 15 “MUSIC”: **MUSIC**
Press to switch to MUSIC mode, the display will show: “E9 3”.
- 16 “BASS MX”: **BASSMX™**
Press to adjust bass level, the display will show: “b5- 1”, “b5 □”, “b5 1”.
- 17 “🔇”: **Mute / Recover the volume.**

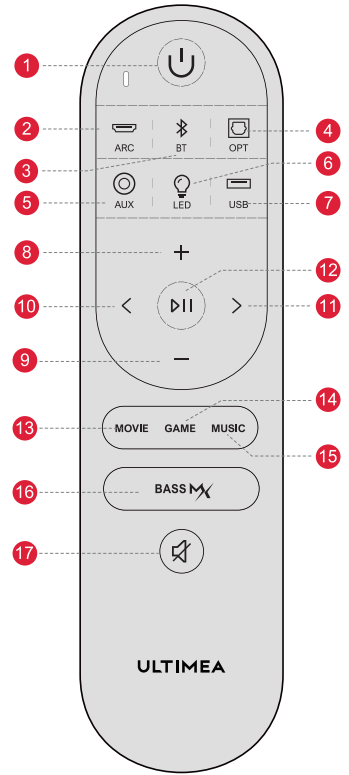

3 CONNECT TO SUBWOOFER

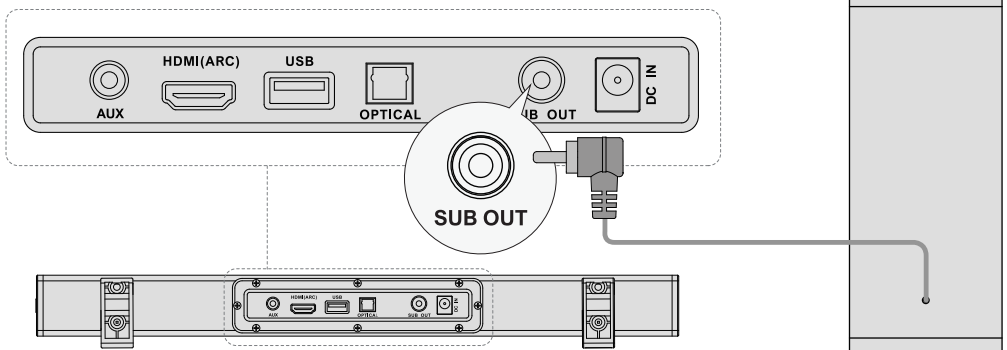

4 CONNECT TO THE TV VIA ARC

EN

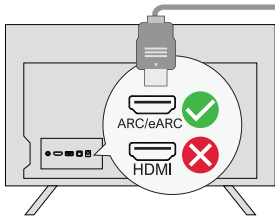

Step 1:

Connect one end of the HDMI cable to the ARC/eARC port on the back of your TV.

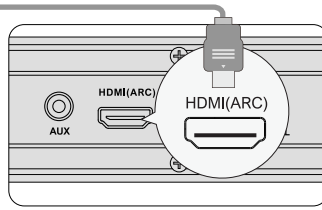

Step 2:

Then connect the other end into the HDMI ARC port of the soundbar.

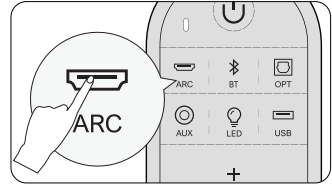

Step 3:

Press "ARC" button on the remote control to select "ARC" input.

If there is no sound, try setting the TV audio output to PCM:

TV Settings > Home > Settings > Sound > Digital Audio Output > PCM

Note: Please turn on the "CEC" function on your TV.

When ARC is connected, your TV remote control can control the soundbar and TV simultaneously:

- 1 Turn on/off
- 2 Adjust the volume

5 CONNECT TO THE TV VIA OPTICAL / AUX

OPTICAL

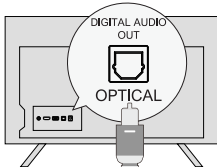

OPTION 1: OPTICAL

- 1 Make sure the TV's port is OPTICAL OUT, connect both sides of the cable to OPTICAL, for both the TV and the soundbar.
- 2 Make sure the optical plug is inserted correctly as it shows in the picture. Do not insert the plug upside down and break the optical.

Note: If audio is playing from the internal TV speakers, mute or minimize the TV volume.

AUX

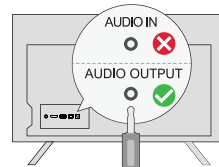

OPTION 2: AUX

- 1 Connect the 3.5mm to 3.5mm Audio Cable to your TV's AUDIO OUT port.
- 2 Not support AUDIO IN port on TV.

Note: Please remember to unplug the AUX cable from TV and Soundbar when you want to switch to other mode.

In Optical Mode: If there is no sound, try setting the TV audio output to PCM: TV Settings > Home > Settings > Sound > Digital Audio Output > PCM

6 CONNECT TO BLUETOOTH®

- 1 Press the "BT" button on the soundbar or remote control to enter Bluetooth pairing mode.
- 2 Open your phone's Bluetooth settings, find and select "Nova S40" to connect the soundbar.

Note: If it's already in the Bluetooth mode and connected, press and hold "BT" button for 3 seconds to disconnect the current device and connect to a new device manually on your mobile phone / PC / TV.

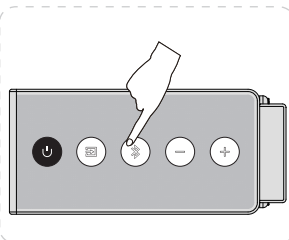

OR

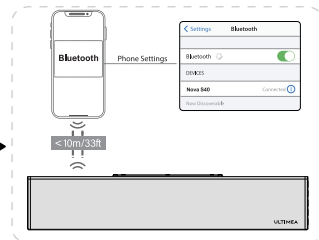
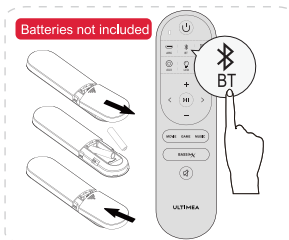

7 PLACEMENT OPTIONS

EN

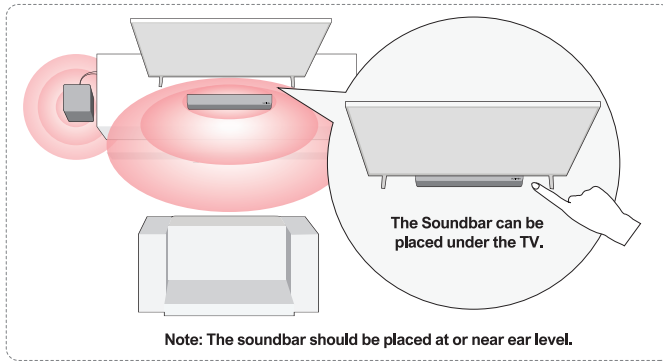

8 WALL MOUNT INSTALLATION

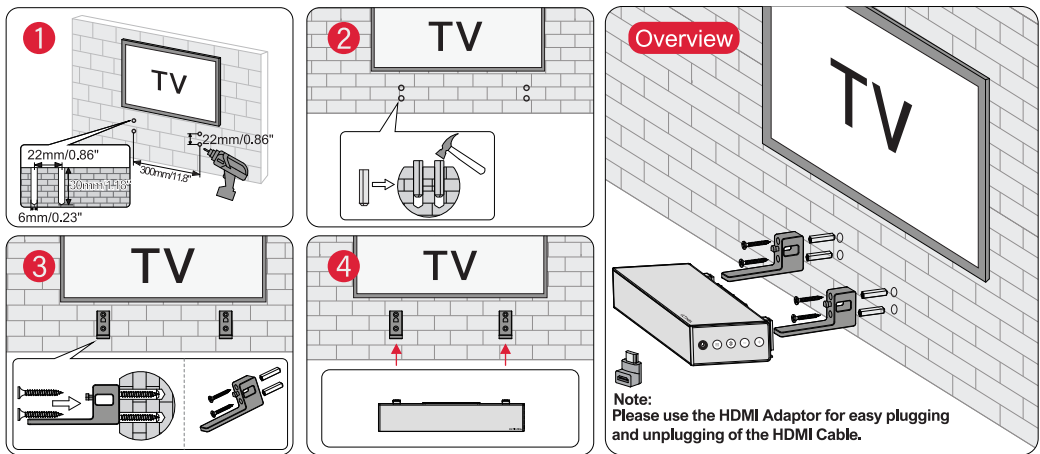

9 SPECIFICATIONS

Model Number	U2100
Power Supply	AC 100-240V, ~50/60Hz
Soundbar Drivers	(1.2" x 3.8") x 2 (Soundbar) + 5.25" (Subwoofer)
Frequency Response	45Hz - 18kHz
Standby Power	<0.5W
Operating Temperature	0°C - 45°C / 32°F - 113°F
Bluetooth Vision	5.3

Dimensions and Weight	
Soundbar	400(W) x 38(H) x 76(D)mm 15.7" x 1.5" x 3.0"
Subwoofer	270(W) x 115(H) x 270(D)mm 10.5" x 4.5" x 10.6"
Packaging	332(W) x 432(H) x 190(D)mm 13.1" x 17" x 7.5"
Net Weight	3.3kg / 7.28lbs
Gross Weight	4.2kg / 9.26lbs

ULTIMEA

Nova S40

Benutzerhandbuch



Modell Nr.: U2100

WIR SIND BEREIT ZU HELFEN



support@ultimea.com

DE

Bevorzugen Sie ein Video-Tutorial?

Setup-Anleitung Video, oder
USER MANUAL auf ULTIMEA
Website.



@ultimea_official



support.ultimea.com

+1 888-598-8875 (US) Mon-Fri 9am-5pm (PST)
+49 89-628-25828 (EU) Mon-Fri 9am-5pm (CET)

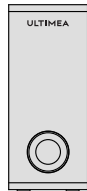
1 ZUBEHÖRLISTE



Soundbar



Subwoofer



Netzadapter

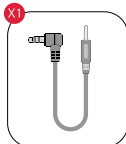

Stereo 3.5mm auf
3.5mm Audiokabel

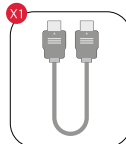

HDMI-Kabel

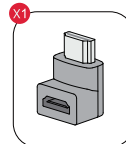

HDMI-Adapter

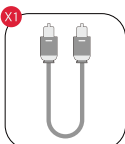

Optisches
Digitalkabel



Fernbedienung

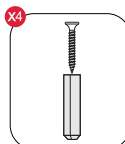

Wandmontage-Kit

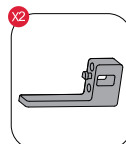

Wandhalterung



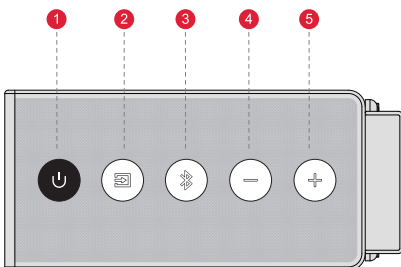

Benutzerhandbuch

2 SOUNDBAR-BEDIENELEMENTE

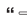
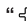

Bedienfeld

- 1 : **Einschalttaste**
Zum Einschalten drücken / zum Ausschalten 3 Sekunden lang gedrückt halten.
- 2 : **Eingangsmodus**
Um den Kanal zu wechseln: ARC-OPT-BT-AUX-USB.
- 3 : **BT**
Um zum Bluetooth-Kanal zu wechseln und den Kopplungsmodus zu aktivieren. Halten Sie die Taste 3 Sekunden lang gedrückt, um die Verbindung mit dem aktuellen Gerät zu trennen und sich manuell mit einem neuen Gerät auf Ihrem Mobiltelefon / PC / Fernseher zu verbinden. (BT ID: Nova S40).
- 4 : **Lautstärke verringern**
- 5 : **Lauter**

Fernsteuerung

- 1 "⏻": **Einschalttaste**
Zum Einschalten drücken / zum Ausschalten 3 Sekunden lang gedrückt halten.
- 2 "⌂": **ARC**
Um zum HDMI ARC-Kanal zu wechseln.
- 3 "📶": **BT**
Um zum Bluetooth-Kanal zu wechseln und den Kopplungsmodus zu aktivieren. Halten Sie die Taste 3 Sekunden lang gedrückt, um die Verbindung mit dem aktuellen Gerät zu trennen und sich manuell mit einem neuen Gerät auf Ihrem Mobiltelefon / PC / Fernseher zu verbinden. (BT ID: Nova S40).
- 4 "📺": **OPT**
Um zum OPTICAL-Kanal zu wechseln.
- 5 "🔊": **AUX**
Um zum AUX-Kanal zu wechseln.
- 6 "💡": **LED**
Um auf den USB-Kanal umzuschalten, drücken Sie die Taste, um die LED einzuschalten, drücken Sie erneut, um sie auszuschalten.
- 7 "🔌": **USB**
Um zum USB-Kanal zu wechseln.
- 8 "+": **Lautstärke aufwärts**
- 9 "-": **Lautstärke runter**
- 10 "<": **Zurück**
BT- und USB-Modus: Sprung zum nächsten Titel.
- 11 ">": **Nächster**
For BT and USB mode only: Skip to next track.
- 12 "⏸": **Wiedergabe / Pause**
Nur für BT- und USB-Modus.
USB-Modus: Halten Sie die Taste 3 Sekunden lang gedrückt, um zwischen Einzelschleifenwiedergabe und Listenschleifenwiedergabe umzuschalten.
- 13 "MOVIE": **MOVIE**
Um in den MOVIE-Modus zu wechseln, wird auf dem Display angezeigt: "E9 I".
- 14 "GAME": **GAME**
Um in den GAME-Modus zu wechseln, wird auf dem Display angezeigt: "E9 2".
- 15 "MUSIC": **MUSIC**
Um in den MUSIC-Modus zu wechseln, wird auf dem Display angezeigt: "E9 3".
- 16 "BASS Mx": **BASSMX™**
Um den Basspegel einzustellen; auf dem Display wird angezeigt: "b5- I", "b5 0", "b5 I".
- 17 "🔇": **Stummschaltung / Wiederherstellung der Lautstärke.**

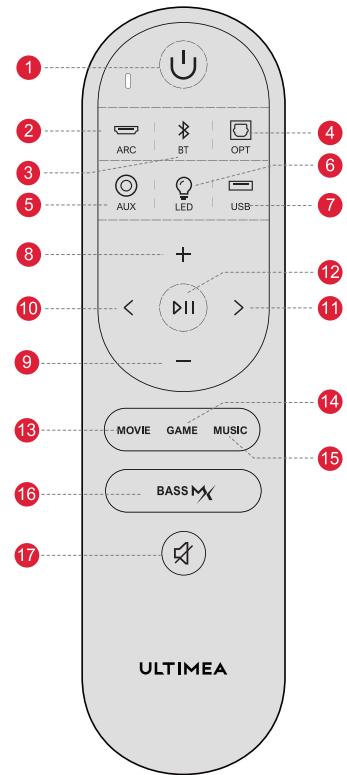

3 ANSCHLUSS AN SUBWOOFER

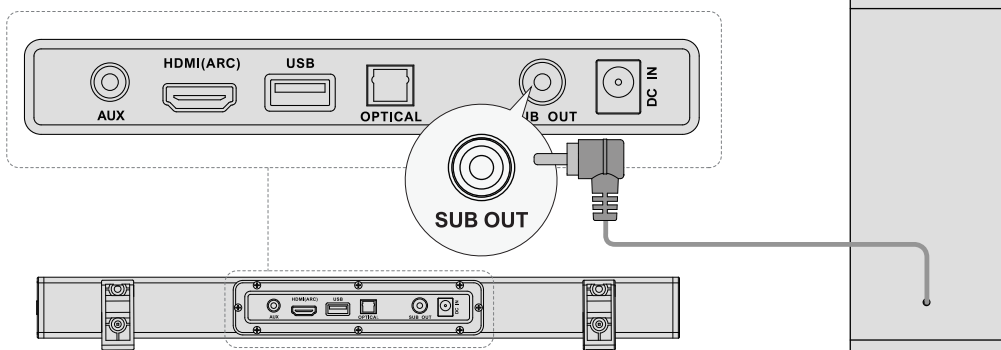

4 ANSCHLUSS AN DEN TV VIA HDMI ARC

DE

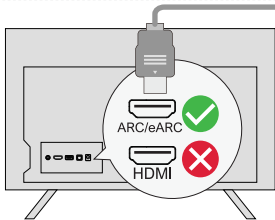

Schritt 1:

Schließen Sie ein Ende des HDMI-Kabels an den eARC / ARC Anschluss auf der Rückseite Ihres Fernsehers an.

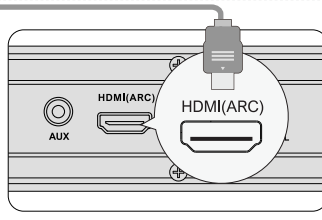

Schritt 2:

Schließen Sie dann das andere Ende an den HDMI (ARC)-Anschluss der Soundbar an.

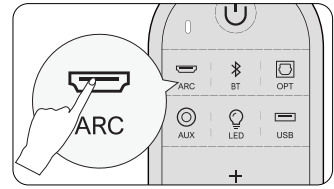

Schritt 3:

Drücken Sie die Taste "ARC" auf der Fernbedienung, um den Eingang "HDMI (ARC)" auszuwählen.

Im optischen Modus: Wenn kein Ton zu hören ist, versuchen Sie, den Audioausgang des Fernsehers auf PCM einzustellen:
TV-Einstellungen > Home > Einstellungen > Ton > Digitaler Audioausgang > PCM

Hinweis: Bitte schalten Sie die "CEC"-Funktion an Ihrem Fernseher ein.

Wenn ARC angeschlossen ist, kann Ihre TV-Fernbedienung die Soundbar und den Fernseher gleichzeitig steuern:

- 1 Einschalten / Ausschalten
- 2 Lautstärke einstellen

5 ANSCHLUSS AN FERNSEHER ÜBER OPTISCH / AUX

OPTISCH

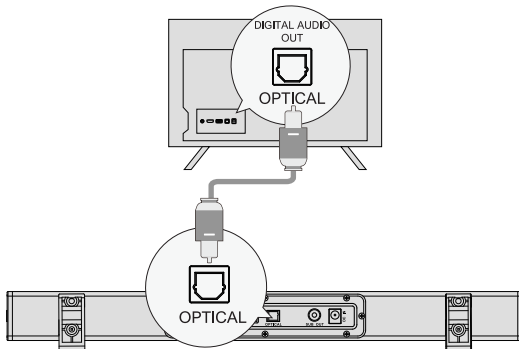

OPTION 1: OPTISCH

- 1 Vergewissern Sie sich, dass das Kabel an den OPTICAL OUT-Anschluss Ihres Fernsehers und das andere Ende an den OPTICAL-Anschluss der Soundbar angeschlossen ist.
- 2 Vergewissern Sie sich, dass der optische Stecker richtig eingesteckt ist, wie auf dem Bild zu sehen. Stecken Sie den Stecker nicht verkehrt herum ein und brechen Sie die Optik nicht ab.

Hinweis: Wenn der Ton über die internen TV-Lautsprecher wiedergegeben wird, schalten Sie die Lautstärke des Fernsehers stumm oder verringern Sie sie.

AUX

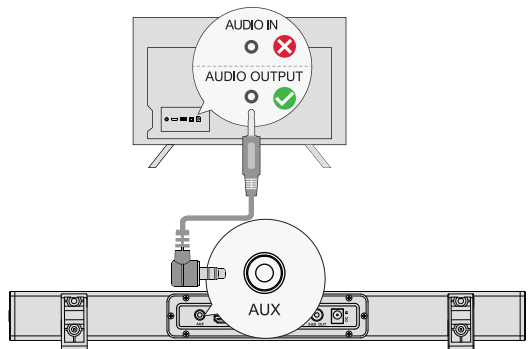

OPTION 2: AUX

- 1 Schließen Sie das 3,5-mm-auf-3,5-mm-Audiokabel an den RCA AUDIO OUT-Anschluss Ihres Fernsehers an.
 - 2 Unterstützt nicht den AUDIO IN-Anschluss des Fernsehers.
- Hinweis: Bitte denken Sie daran, das AUX-Kabel vom Fernseher und der Soundbar zu trennen, wenn Sie einen anderen Modus verwenden möchten.**

Im optischen Modus: Wenn kein Ton zu hören ist, versuchen Sie, den Audioausgang des Fernsehers auf PCM einzustellen:
TV-Einstellungen > Home > Einstellungen > Ton > Digitaler Audioausgang > PCM

6 MIT BLUETOOTH® VERBINDEN

- 1 Drücken Sie die Taste "BT" auf der Soundbar oder der Fernbedienung, um den Bluetooth-Kopplungsmodus zu aktivieren.
 - 2 Öffnen Sie die Bluetooth-Einstellungen Ihres Telefons, suchen und wählen Sie "Nova S40", um die Soundbar zu verbinden.
- Hinweis:** Wenn sich das Gerät bereits im Bluetooth-Modus befindet und verbunden ist, halten Sie die Taste "BT" 3 Sekunden lang gedrückt, um die Verbindung mit dem aktuellen Gerät zu trennen und manuell eine Verbindung mit einem neuen Gerät auf Ihrem Mobiltelefon / PC / Fernseher herzustellen.

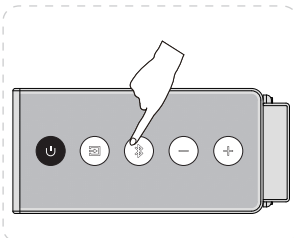

oder

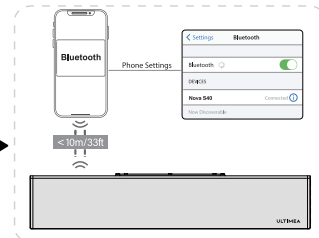
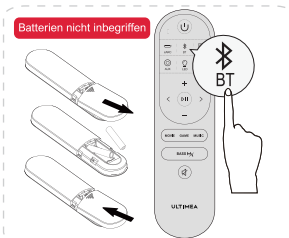

7 PLATZIERUNGSMÖGLICHKEITEN

DE

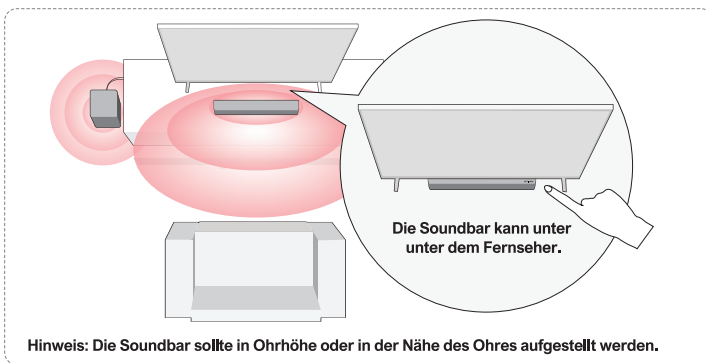

8 WANDBEFESTIGUNG

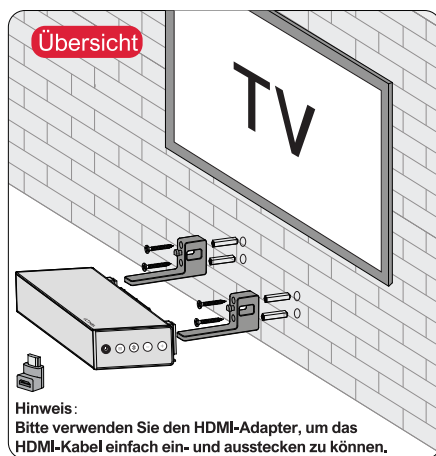
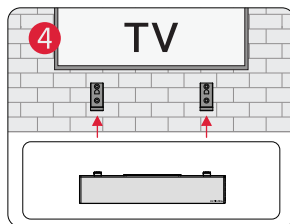
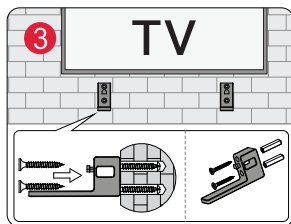
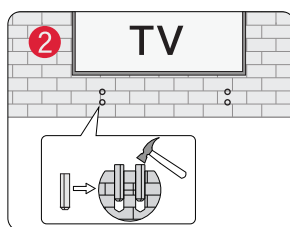
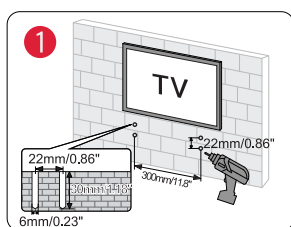

9 SPEZIFIKATIONEN

Modell-Nummer	U2100
Stromversorgung	AC 100-240V, ~50/60Hz
Soundbar-Treiber	(1.2" x 3.8") x 2 (Soundbar) + 5.25" (Subwoofer)
Frequenzgang	45Hz - 18kHz
Standby-Leistung	<0.5W
Betriebstemperatur	0°C - 45°C / 32°F - 113°F
Bluetooth Vision	5.3

Abmessungen und Gewicht	
Soundbar	400(W) x 38(H) x 76(D)mm 15.7" x 1.5" x 3.0"
Subwoofer	270(W) x 115(H) x 270(D)mm 10.5" x 4.5" x 10.6"
Verpackung	332(W) x 432(H) x 190(D)mm 13.1" x 17" x 7.5"
Nettogewicht	3.3kg / 7.28lbs
Bruttogewicht	4.2kg / 9.26lbs

ULTIMEA

Nova S40

ユーザーマニュアル

ご対応させていただきます



support@ultimea.com

JP



モデルNo: U2100

ビデオチュートリアルをご希望ですか?

ULTIMEAのホームページで、セットアップガイダンスの動画や取扱説明書をご覧ください。



support.ultimea.com

Twitter Facebook Instagram YouTube SoundCloud @ultimea_official

+1 888-598-8875 (US) Mon-Fri 9am-5pm (PST)
+49 89-628-25828 (EU) Mon-Fri 9am-5pm (CET)

1 アクセサリーリスト

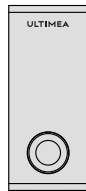

サブウーファー



サウンドバー



電源アダプター

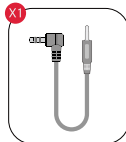

ステレオ3.5mm-3.5mmオーディオケーブル

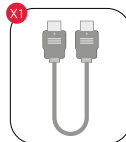

HDMIケーブル

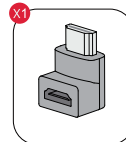

HDMIアダプター

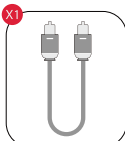

光デジタルケーブル



リモコン

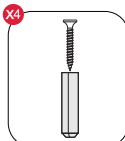

壁掛けネジ

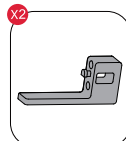

壁掛けスタンド



ユーザーマニュアル

2 サウンドバーコントロール

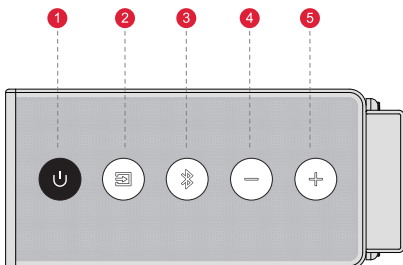

コントロールパネル

- 1 “”: **電源ボタン**
押すと電源が入り、3秒間押し続けると電源が切れます。
- 2 “”: **入力モード**
押すとチャンネルを切り替え: ARC-OPT-BT-AUX-USB。
- 3 “”: **BT**
を押してBluetoothチャンネルに切り替え、ペアリングモードに入ります。押すとBluetoothを切り替え、ペアリングモードに入ります。3秒間押し付けると現在のデバイスが切断された後、それでは他のデバイスを接続します。(BT: Nova S40)
- 4 “”: **ボリュームダウン**
- 5 “”: **ボリューム・アップ**

リモコン

JP

- 1 “**⏻**” : 「電源ボタン」
短押しでオン、3秒長押しでオフ。
- 2 “**⇄**” : ARC
押すとHDMI ARCに切り替える。
- 3 “**📶**” : BT
を押してBluetoothチャンネルに切り替え、ペアリングモードに入ります。押すとBluetoothを切り替え、ペアリングモードに入ります。3秒間押し付けると現在のデバイスが切断された後、それでは他のデバイスを接続します。(BT: Nova S40)
- 4 “**📺**” : OPT
押すとOPTICALに切り替える。
- 5 “**🎧**” : AUX
押すとAUXに切り替える。
- 6 “**💡**” : LED
押すとLEDライト開ける、再び押すと消灯する。
- 7 “**🔌**” : USB
押すとUSBに切り替える。
- 8 “**+**” : 「ボリュームアップ」
- 9 “**-**” : 「ボリュームダウン」
- 10 “**<**” : 前
BTおよびUSBモード: 前のトラックにスキップします。
- 11 “**>**” : 次へ
BTおよびUSBモード: 次のトラックにスキップします。
- 12 “**⏮**” : 再生/停止
BTおよびUSBモードのみ
3秒間長押しすると、単一曲循環再生とリスト循環再生が切り替わります。
- 13 “**MOVIE**” : MOVIE
押すと映画モードに切り替わり、“E9 i”と表示されます。
- 14 “**GAME**” : GAME
押すとゲームモードに切り替わり、“E9 2”と表示されます。
- 15 “**MUSIC**” : 音楽
押すと音楽モードに切り替わり、“E9 3”と表示されます。
- 16 “**BASS Mx**” : ベースマックス
押してベースの音量を調節します: “b5- i”, “b5 0”, “b5 i”。
- 17 “**🔇**” : 音量ミュート/リストア。

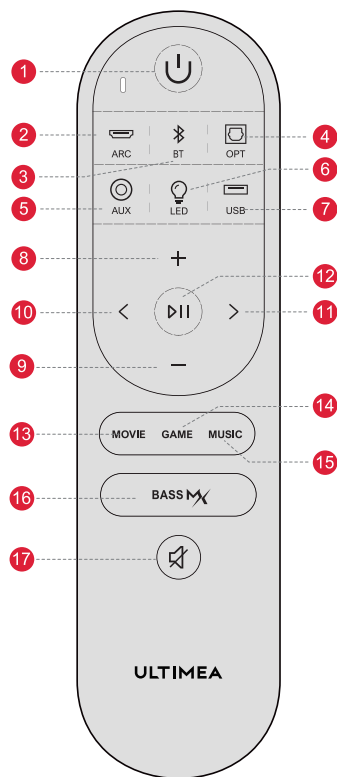

3 サブウーファーに接続

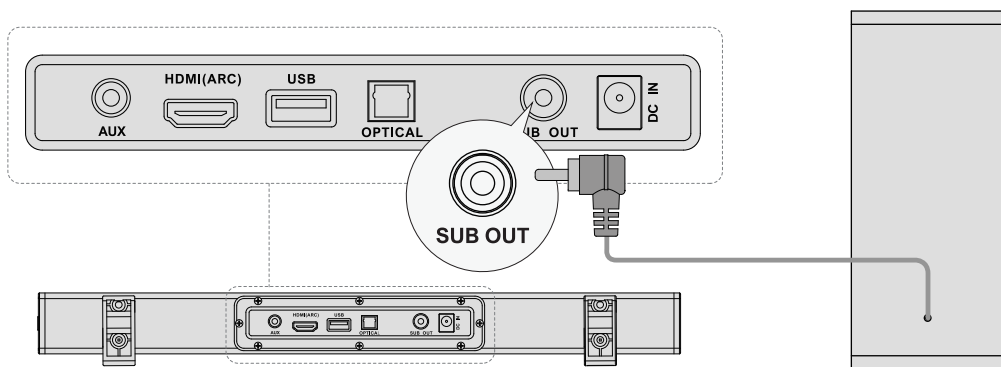

4 HDMI ARCでテレビに接続する

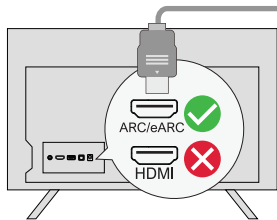

ステップ①:
HDMIケーブルの一端をテレビ背面のARC/eARCポートに接続します。

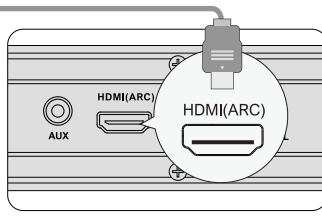

ステップ②:
次に、もう一方の端をサウンドバーのHDMI ARCポートに接続します。

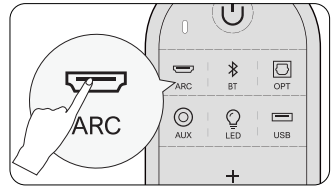

ステップ③:
リモコンの「ARC」ボタンを押して「ARC」入力を選択します。

JP

光学モードの場合：音が出ない場合は、テレビの音声出力をPCMに設定してみてください。
テレビの設定 > ホーム > 設定 > サウンド > デジタル音声出力 > PCM

注：テレビの「CEC」機能をオンにしてください。

ARCが接続されている場合、テレビのリモコンでサウンドバーとテレビを同時に操作できます：

- ① 電源オン/オフ
- ② 音量調整

5 オプティカル/AUXでテレビに接続

光学式

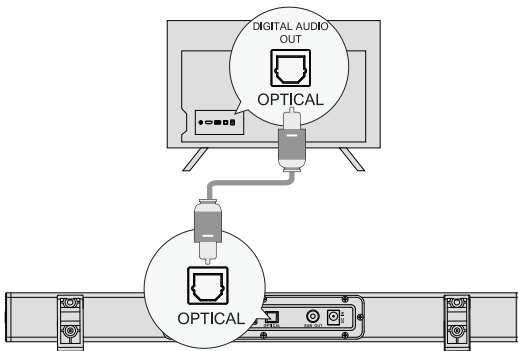

オプション1: 光学式

- ① ケーブルがテレビのOPTICAL OUTポートに接続され、もう一方がサウンドバーのOPTICALポートに接続されていることを確認してください。
- ② コードの差し込み口が写真のように正しく差し込まれていることを確認してください。（間違っても差し込むと破損する恐れがあります）

注：サウンドバーを接続した後、テレビのスピーカーからも音声再生される場合は、テレビの音量をミュートまたは最小にしてください。

AUX

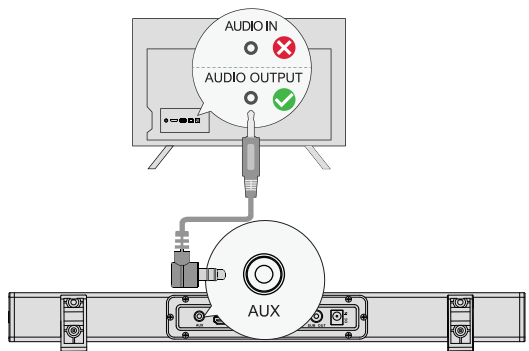

オプション2: AUX

- ① 3.5mmオーディオケーブルをテレビのRCA AUDIO OUTポートに接続します。
- ② テレビのAUDIO INポートには対応していません。

注：他のモードを使用する場合は、テレビとサウンドバーからAUXケーブルを抜いてください。

光学モードの場合：音が出ない場合は、テレビの音声出力をPCMに設定してみてください。
テレビの設定 > ホーム > 設定 > サウンド > デジタル音声出力 > PCM

6 ブルートゥース接続

- ① サウンドバーまたはリモコンの"⌘"ボタンを押して、Bluetoothペアリングモードに入ります。
- ② 携帯電話のBluetooth設定を開き、"Nova S40"を見つけて選択し、サウンドバーを接続します。

注：すでにBluetoothモードで接続されている場合は、"⌘"ボタンを3秒間長押しして、現在のデバイスを切断し、携帯電話/PC/テレビで手動で新しいデバイスに接続します。

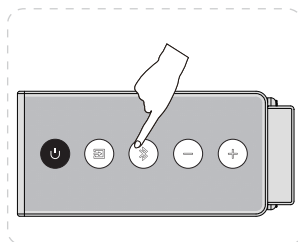

または

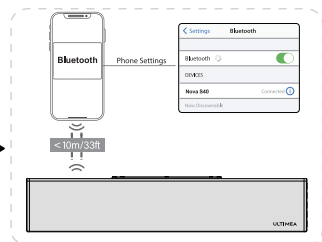
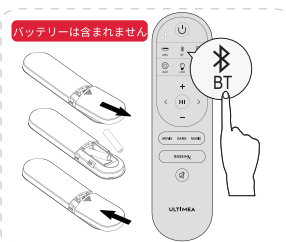

7 配置オプション

JP

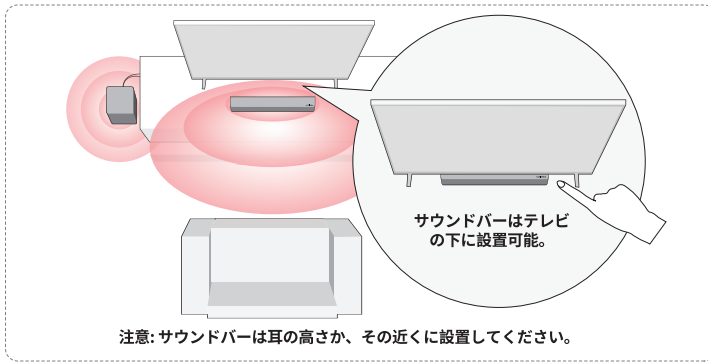

8 壁掛け設置

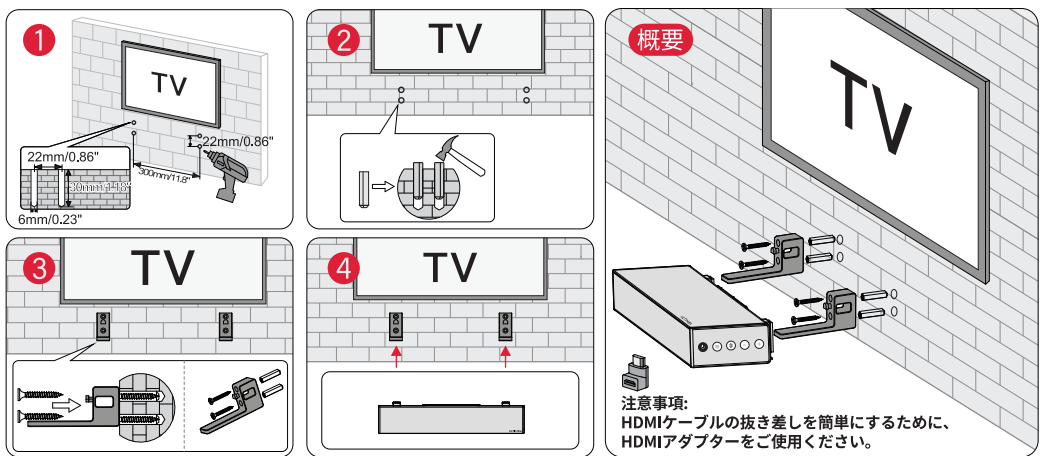

9 仕様

モデル番号	U2100
電源	AC 100-240V, ~50/60Hz
サウンドバードライバー	(1.2インチ×3.8インチ) ×2 (サウンドバー) +5.25インチ (サブウーファー)
周波数特性	45Hz - 18kHz
待機時消費電力量	<0.5W
動作温度	0°C - 45°C / 32°F - 113°F
ブルートゥース・ビジョン	5.3

寸法と重量	
サウンドバー	400(W) x 38(H) x 76(D)mm 15.7" x 1.5" x 3.0"
サブウーファー	270(W) x 115(H) x 270(D)mm 10.5" x 4.5" x 10.6"
パッケージング	332(W) x 432(H) x 190(D)mm 13.1" x 17" x 7.5"
正味重量	3.3kg / 7.28lbs
総重量	4.2kg / 9.26lbs

ULTIMEA

Nova S40

Manuel d'utilisation



N° de modèle : U2100

NOUS SOMMES PRÊTS À VOUS AIDER



support@ultimea.com

FR

Vous préférez un tutoriel vidéo ?

Vidéo d'aide à l'installation, ou MANUEL D'UTILISATION sur le site web d'ULTIMEA.



@ultimea_official



support.ultimea.com

+1 888-598-8875 (US)
+49 89-628-25828 (EU)

Mon-Fri 9am-5pm (PST)
Mon-Fri 9am-5pm (CET)

1 LISTE DES ACCESSOIRES



Caisson de basse



Barre de son

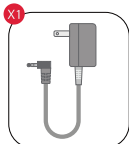

Adaptateur électrique

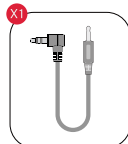

Câble audio stéréo 3.5 mm à 3.5 mm

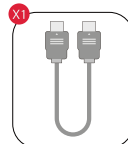

Câble HDMI

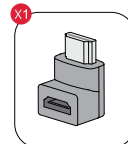

Adaptateur HDMI

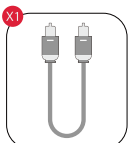

Câble optique numérique



Télécommande

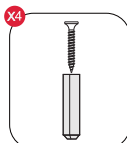

Kit de montage mural

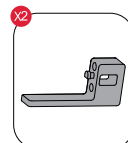

Support mural



Manuel de l'utilisateur

2 COMMANDES DE LA BARRE DE SON

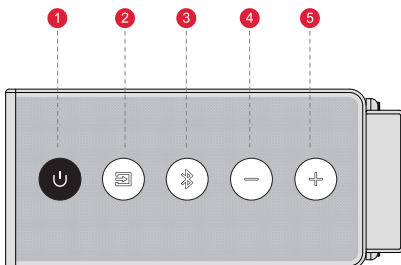

Panneau de contrôle

- 1 "⏻": Bouton d'alimentation**
Appuyez sur ce bouton pour allumer l'appareil / Maintenez-le enfoncé pendant 3 secondes pour l'éteindre.
- 2 "📺": Mode d'entrée**
Appuyer pour changer de canal : ARC-OPT-BT-AUX-USB.
- 3 "📶": BT**
Appuyez sur cette touche pour passer au canal BT / Maintenez la touche enfoncée pendant 3 secondes pour déconnecter l'appareil actuel et vous connecter manuellement à un nouvel appareil sur votre téléphone portable / PC / TV. (BT ID : Nova S40).
- 4 "⏪": Réduction du volume**
- 5 "⏩": Augmentation du volume**

Télécommande

- 1 "⏻" : **Bouton d'alimentation**
Appuyer pour mettre sous tension / Maintenir pendant 3 secondes pour mettre hors tension.
- 2 "⏮" : **ARC**
Appuyez sur cette touche pour passer au canal HDMI ARC.
- 3 "📶" : **BT**
Appuyez sur cette touche pour passer au canal Bluetooth et entrer en mode d'appairage. Maintenez cette touche enfoncée pendant 3 secondes pour déconnecter l'appareil actuel et vous connecter manuellement à un nouvel appareil sur votre téléphone portable / PC / TV (BT ID : Nova S40).
- 4 "📺" : **OPT**
Appuyez sur cette touche pour passer au canal OPTICAL.
- 5 "🎧" : **AUX**
Appuyez sur cette touche pour passer au canal AUX.
- 6 "💡" : **LED**
Appuyez sur cette touche pour allumer la LED, appuyez à nouveau pour l'éteindre.
- 7 "🔌" : **USB**
Appuyez sur cette touche pour passer au canal USB.
- 8 "+": **Augmentation du volume**
- 9 "-": **Diminution du volume**
- 10 "<": **Précédent**
Mode BT et USB : Passer à la piste précédente.
- 11 ">": **Suivant**
Mode BT et USB : Passer à la piste suivante.
- 12 "⏸": **Lecture/Pause**
Pour les modes BT et USB uniquement.
Mode USB : Maintenez cette touche enfoncée pendant 3 secondes pour basculer entre la lecture d'une boucle unique et la lecture d'une boucle de liste.
- 13 "MOVIE": **MOVIE**
Appuyez sur cette touche pour passer au mode MOVIE, l'écran affiche : "E9 I".
- 14 "GAME": **GAME**
Appuyez sur cette touche pour passer en mode JEU, l'écran affiche : "E9 Z".
- 15 "MUSIC": **MUSIQUE**
Appuyez sur cette touche pour passer en mode MUSIQUE, l'écran affiche : "E9 3".
- 16 "BASS MX": **BASSMX™**
Appuyez sur pour régler le niveau des basses, l'écran affiche: "b5- I", " b5 0", " b5 I".
- 17 "🔇": **Mute / Récupérer le volume.**

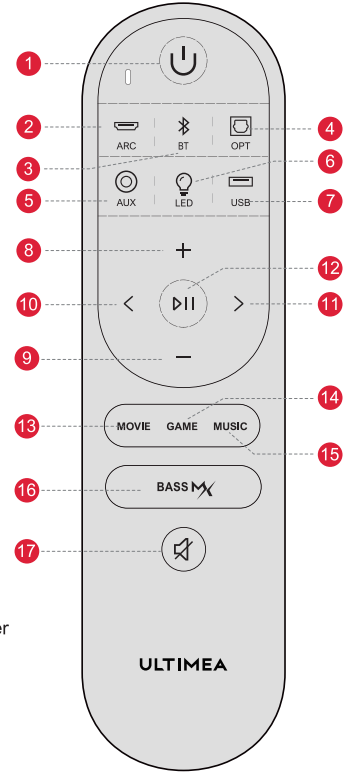

3 CONNECTER AU CAISSON DE BASSE

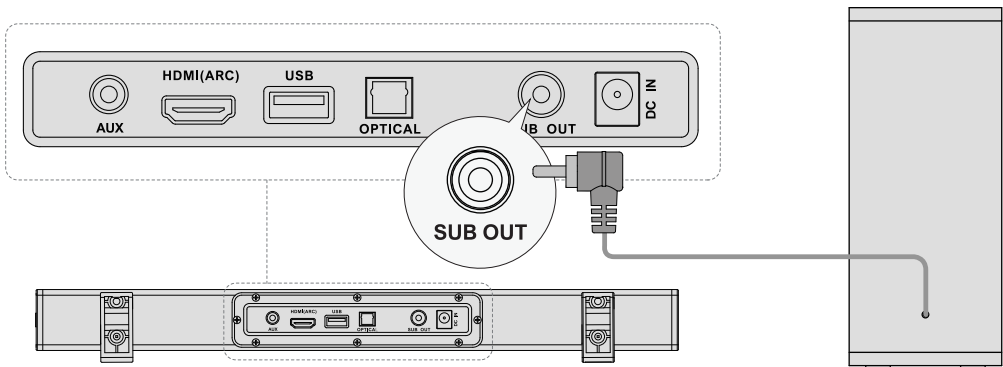

4 CONNEXION AU TÉLÉVISEUR VIA HDMI ARC

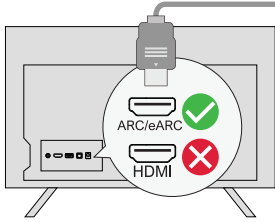

Étape 1:

Connectez une extrémité du câble HDMI au port eARC / ARC à l'arrière de votre téléviseur.

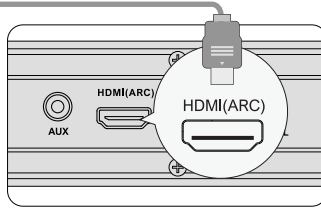

Étape 2:

Connectez ensuite l'autre extrémité au port HDMI (ARC) de la barre de son.

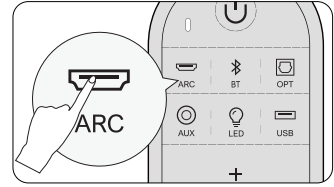

Étape 3:

Appuyez sur le bouton "ARC" de la télécommande pour sélectionner l'entrée "HDMI (ARC)".

FR

En mode optique : S'il n'y a pas de son, essayez de régler la sortie audio du téléviseur sur PCM :
Réglages TV > Accueil > Réglages > Son > Sortie audio numérique > PCM

Remarque : veuillez activer la fonction "CEC" sur votre téléviseur.

Lorsque ARC est connecté, la télécommande de votre téléviseur peut contrôler la barre de son et le téléviseur simultanément :

- 1 Allumer / éteindre
- 2 Régler le volume

5 CONNECTER AU TÉLÉVISEUR VIA OPTIQUE / AUX

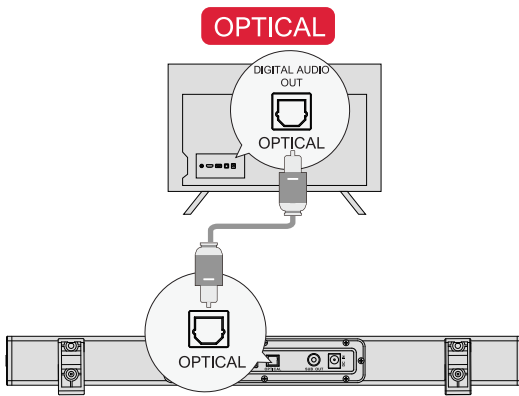

OPTION 1 : OPTIQUE

- 1 Assurez-vous que le câble est connecté au port OPTICAL OUT de votre téléviseur et l'autre extrémité au port OPTICAL de la barre de son.
- 2 Assurez-vous que la prise optique est insérée correctement, comme indiqué sur l'image. N'insérez pas la fiche à l'envers et ne cassez pas le câble optique.

Remarque : Si le son est diffusé par les haut-parleurs internes du téléviseur, coupez ou réduisez le volume du téléviseur.

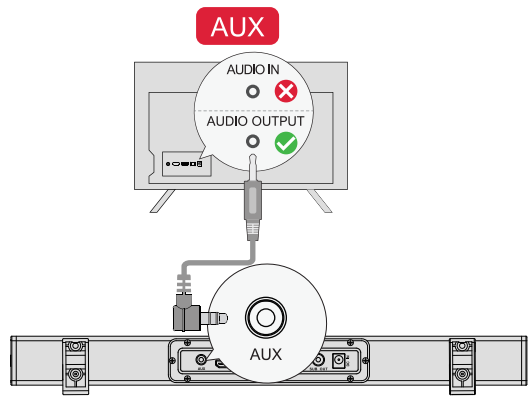

OPTION 2 : AUX

- 1 Connectez le câble audio 3,5 mm à 3,5 mm au port RCA AUDIO OUT de votre téléviseur.
- 2 le port AUDIO IN de la télévision n'est pas pris en charge.

Remarque : N'oubliez pas de débrancher le câble AUX du téléviseur et de la barre de son lorsque vous souhaitez utiliser un autre mode.

En mode optique : S'il n'y a pas de son, essayez de régler la sortie audio du téléviseur sur PCM :
Réglages TV > Accueil > Réglages > Son > Sortie audio numérique > PCM

6 CONNECTER À BLUETOOTH®

- 1 Appuyez sur le bouton "BT" de la barre de son ou de la télécommande pour entrer en mode d'appairage Bluetooth.
- 2 Ouvrez les paramètres Bluetooth de votre téléphone, recherchez et sélectionnez "Nova S40" pour connecter la barre de son.

Remarque : Si l'appareil est déjà en mode Bluetooth et connecté, appuyez sur le bouton "BT" et maintenez-le enfoncé pendant 3 secondes pour déconnecter l'appareil actuel et vous connecter manuellement à un nouvel appareil sur votre téléphone portable / PC / TV.

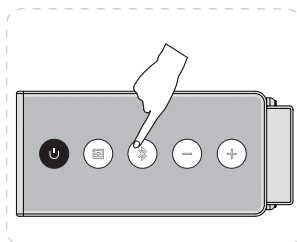

OU

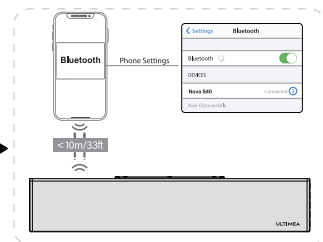
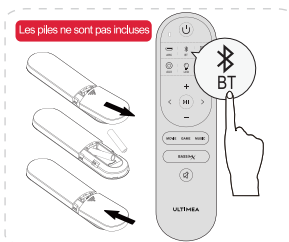

7 OPTIONS DE PLACEMENT

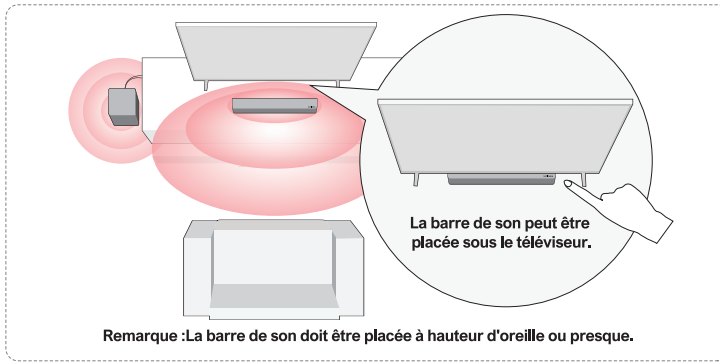

8 INSTALLATION MURALE

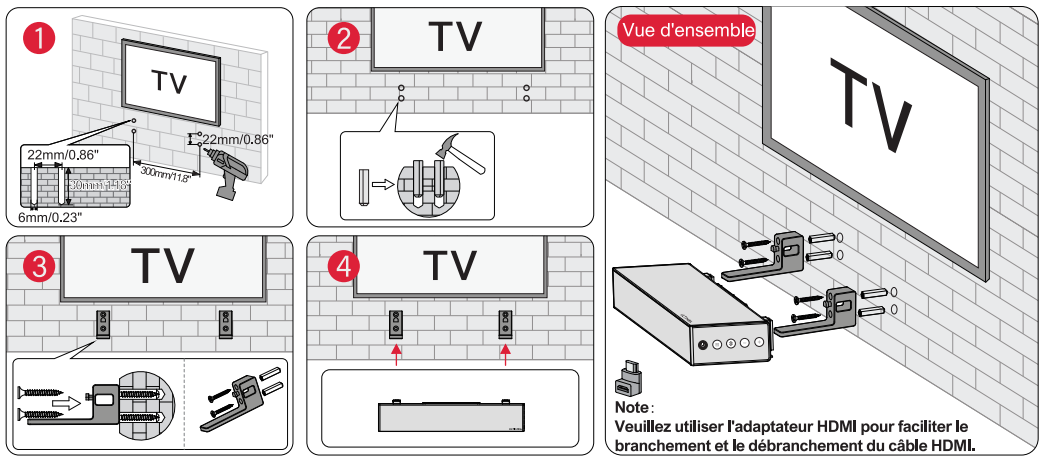

9 CARACTÉRISTIQUES TECHNIQUES

Modèle	U2100
Alimentation Électrique	AC 100-240V, ~50/60Hz
Barre de son Pilotes	(1.2" x 3.8") x 2 (Soundbar) + 5.25" (Subwoofer)
Réponse en fréquence	45Hz - 18kHz
Puissance en veille	< 0.5W
Température de fonctionnement	0°C - 45°C / 32°F - 113°F
Vision Bluetooth	5.3

Dimensions et poids	
Barre de Son	400(W) x 38(H) x 76(D)mm 15.7" x 1.5" x 3.0"
Caisson de basse	270(W) x 115(H) x 270(D)mm 10.5" x 4.5" x 10.6"
Emballage	332(W) x 432(H) x 190(D)mm 13.1" x 17" x 7.5"
Poids net	3.3kg / 7.28lbs
Poids brut	4.2kg / 9.26lbs

ULTIMEA

Nova S40

Manuale d'uso



Modello n.: U2100

SIAMO PRONTI AD AIUTARE



support@ultimea.com

IT

Preferite un video tutorial?

Video guida all'installazione o MANUALE D'USO sul sito web di ULTIMEA.



@ultimea_official



support.ultimea.com

+1 888-598-8875 (US)
+49 89-628-25828 (EU)

Mon-Fri 9am-5pm (PST)
Mon-Fri 9am-5pm (CET)

1 ELENCO DEGLI ACCESSORI

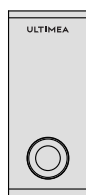

Subwoofer



Soundbar

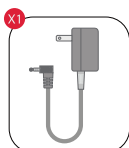

Adattatore di alimentazione

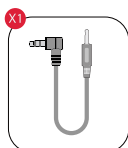

Cavo audio stereo da 3.5 mm a 3.5 mm

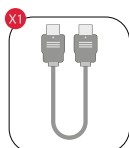

Cavo HDMI

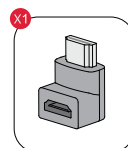

Adattatore HDMI

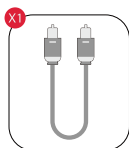

Cavo ottico digitale



Telecomando

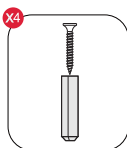

Kit di montaggio a parete

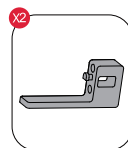

Staffa a parete



Manuale d'uso

2 CONTROLLI DELLA SOUNDBAR

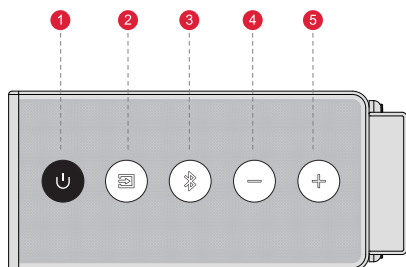

Pannello di controllo

- 1** “”: **pulsante di accensione**
Premere per accendere / Tenere premuto per 3 secondi per spegnere.
- 2** “”: **Modalità di ingresso**
Premere per cambiare canale: ARC-OPT-BT-AUX-USB.
- 3** “”: **BT**
Premere per passare al canale BT / Tenere premuto per 3 secondi per scollegare il dispositivo corrente e collegarsi a un nuovo dispositivo (ID BT: Nova S40).
- 4** “”: **Volume giù**
- 5** “”: **Volume alto**

Telecomando

- 1 “**U**” : **Tasto di accensione**
Premere per accendere / Tenere premuto per 3 secondi per spegnere.
- 2 “**eARC**” : **eARC**
Premere per passare al canale HDMI ARC.
- 3 “**BT**” : **BT**
Premere per passare al canale BT / Tenere premuto per 3 secondi per scollegare il dispositivo corrente e collegarsi a un nuovo dispositivo. (ID BT: Nova S40).
- 4 “**OPT**” : **OPT**
Premere per passare al canale OPTICAL.
- 5 “**AUX**” : **AUX**
Premere per passare al canale AUX.
- 6 “**LED**” : **LED**
Premere per accendere il LED, premere nuovamente per spegnerlo.
- 7 “**USB**” : **USB**
Premere per passare al canale USB.
- 8 “**+**” : **Volume su**
- 9 “**-**” : **Volume giù**
- 10 “**<**” : **Precedente**
Modalità BT e USB: Passa al brano precedente.
- 11 “**>**” : **successivo**
Modalità BT e USB: Passa alla traccia successiva.
- 12 “**▶||**” : **Riproduzione / Pausa**
Solo per le modalità BT e USB.
Modalità USB: Tenere premuto per 3 secondi per passare dalla riproduzione di un singolo loop alla riproduzione di un elenco di loop.
- 13 “**MOVIE**” : **FILMATO**
Drücken Sie , um in den MOVIE-Modus zu wechseln, il display visualizzerà: "E9 1".
- 14 “**GAME**” : **GIOCO**
Drücken Sie , um in den GAME-Modus zu wechseln, il display visualizzerà: "E9 2".
- 15 “**MUSIC**” : **MUSICA**
Drücken Sie , um in den MUSIC-Modus zu wechseln, il display visualizzerà: "E9 3".
- 16 “**BASS MX**” : **BASSMX™**
Premere per regolare il livello dei bassi; il display visualizza: “b5- 1”, “ b5 0”, “ b5 1”.
- 17 “**Mute**” : **Mute / Recupera il volume.**

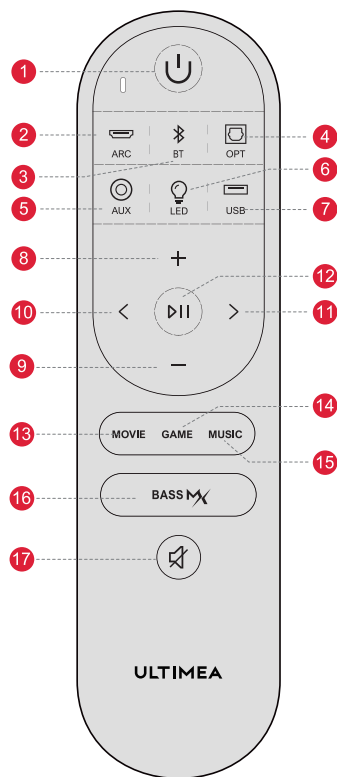

3 COLLEGAMENTO AL SUBWOOFER

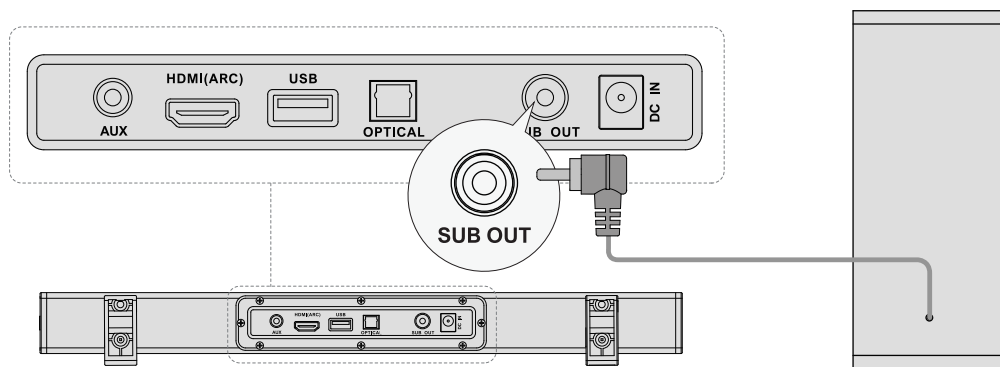

4 COLLEGAMENTO AL TV TRAMITE HDMI ARC

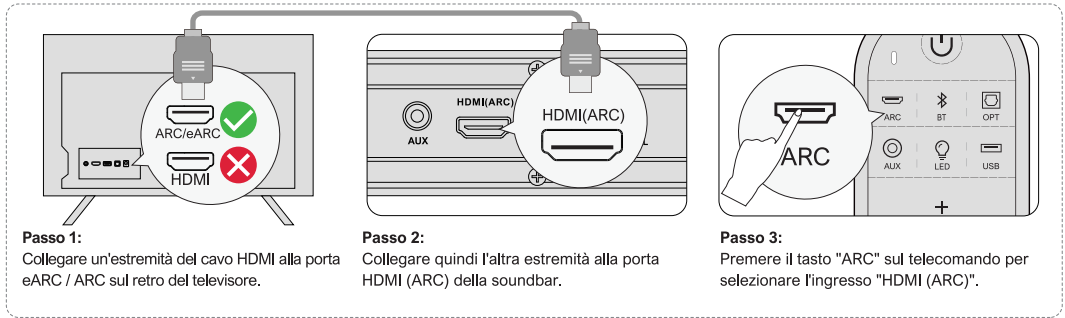

In modalità ottica: Se non si sente alcun suono, provare a impostare l'uscita audio del televisore su PCM:
Impostazioni TV > Home > Impostazioni > Audio > Uscita audio digitale > PCM

Nota: attivare la funzione "CEC" sul televisore.

Quando è collegato ARC, il telecomando del televisore può controllare contemporaneamente la soundbar e il televisore:

- 1 Accendere / Spegnerne
- 2 Regolare il volume

5 COLLEGAMENTO ALLA TV VIA OTTICO/AUX

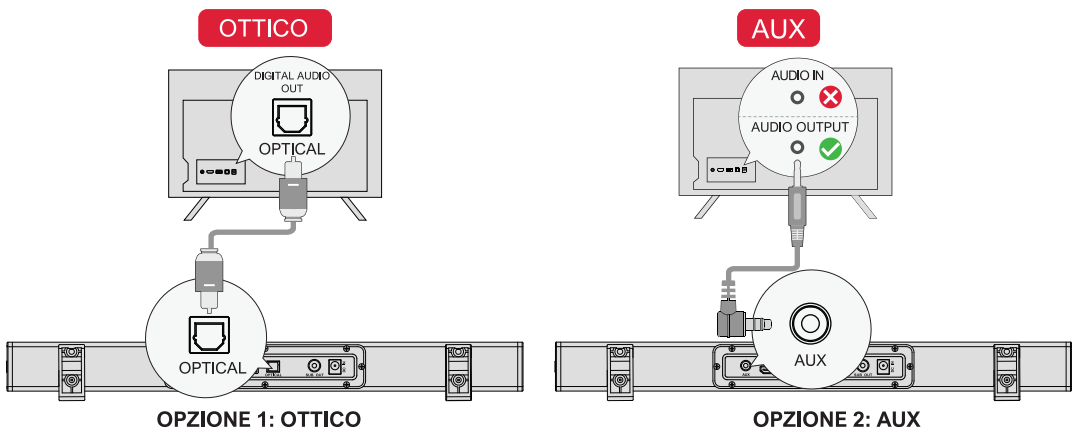

- 1 Assicurarsi che il cavo sia collegato alla porta OPTICAL OUT del televisore e l'altra estremità alla porta OPTICAL del sistema Soundbar.
- 2 Assicurarsi che la spina ottica sia inserita correttamente come mostrato nell'immagine. Non inserire la spina al contrario e non rompere l'ottica.

Nota: se l'audio viene riprodotto dagli altoparlanti interni del televisore, disattivare o ridurre al minimo il volume del televisore.

- 1 Collegare il cavo audio da 3,5 mm a 3,5 mm alla porta RCA AUDIO OUT del televisore.
- 2 Non supporta la porta AUDIO IN del televisore.

Nota: ricordarsi di scollegare il cavo AUX dal televisore e dalla Soundbar quando si desidera utilizzare un'altra modalità.

In modalità ottica: Se non si sente alcun suono, provare a impostare l'uscita audio del televisore su PCM:
Impostazioni TV > Home > Impostazioni > Audio > Uscita audio digitale > PCM

6 CONNETTERSI AL BLUETOOTH®

- 1 Premere il pulsante "BT" sulla soundbar o sul telecomando per accedere alla modalità di accoppiamento Bluetooth.
- 2 Aprire le impostazioni Bluetooth del telefono, trovare e selezionare "Nova S40" per collegare la soundbar.

Nota: se è già in modalità Bluetooth e collegato, tenere premuto il pulsante "BT" per 3 secondi per scollegare il dispositivo corrente e collegarsi manualmente a un nuovo dispositivo sul telefono cellulare / PC / TV.

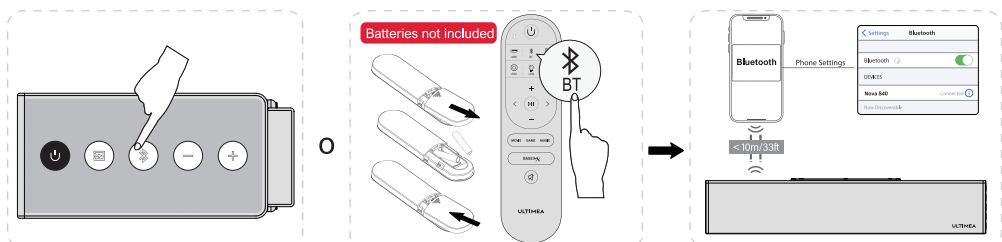

7 OPZIONI DI POSIZIONAMENTO

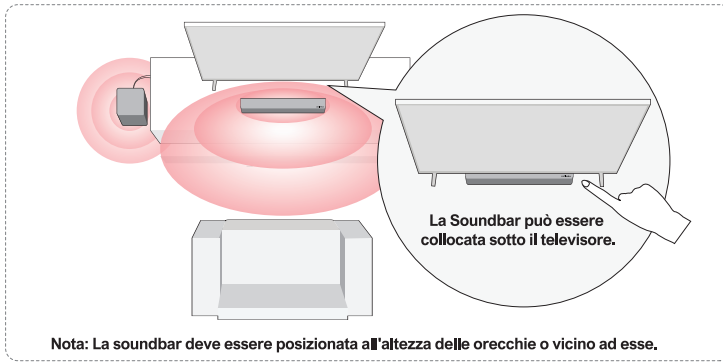

8 INSTALLAZIONE A PARETE

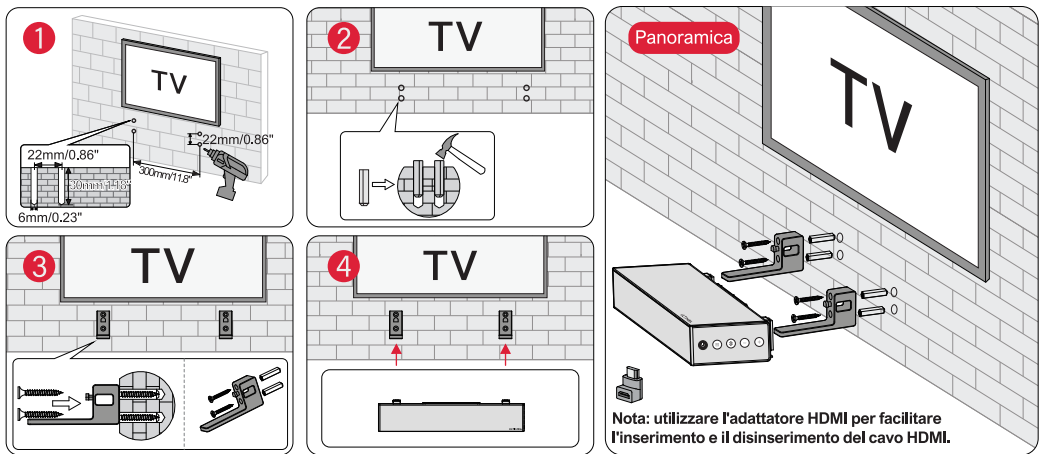

9 SPECIFICHE

Numero di modello	U2100
Alimentazione	AC 100-240V, ~50/60Hz
Driver della soundbar	(1.2" x 3.8") x 2 (Soundbar) + 5.25" (Subwoofer)
Risposta in frequenza	45Hz - 18kHz
Potenza in standby	< 0.5W
Temperatura di esercizio	0°C - 45°C / 32°F - 113°F
Bluetooth Vision	5.3

Visione Bluetooth	
Soundbar	400(W) x 38(H) x 76(D)mm 15.7" x 1.5" x 3.0"
Subwoofer	270(W) x 115(H) x 270(D)mm 10.5" x 4.5" x 10.6"
Imballaggio	332(W) x 432(H) x 190(D)mm 13.1" x 17" x 7.5"
Peso netto	3.3kg / 7.28lbs
Peso lordo	4.2kg / 9.26lbs

ULTIMEA

Nova S40

Manual del usuario



Nº de modelo: U2100

ESTAMOS LISTOS PARA AYUDAR



support@ultimea.com

¿Prefiere un tutorial en vídeo?

Vídeo guía de instalación o MANUAL DE USUARIO en el sitio web de ULTIMEA.

@ultimea_oficial



support.ultimea.com

ES

+1 888-598-8875 (US) Mon-Fri 9am-5pm (PST)
+49 89-628-25828 (EU) Mon-Fri 9am-5pm (CET)

1 LISTA DE ACCESORIOS



Subwoofer



Barra de sonido

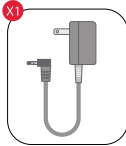

Adaptador de corriente



Cable de audio estéreo de 3.5 mm a 3.5 mm

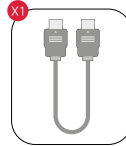

Cable HDMI

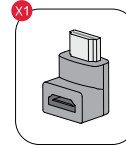

Adaptador HDMI

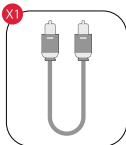

Cable óptico digital



Mando a distancia

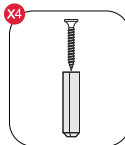

Kit de montaje en pared

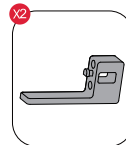

Soporte de pared



Manual del usuario

2 CONTROLES DE LA BARRA DE SONIDO

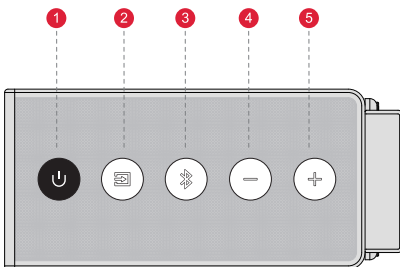

Panel de control

- 1 **“⏻”**: Botón de encendido
Pulse para encender / Mantenga pulsado durante 3 segundos para apagar.
- 2 **“⏮”**: Modo de entrada
Pulse para cambiar de canal: ARC-OPT-BT-AUX-USB.
- 3 **“📶”**: BT
Pulse para cambiar al canal BT / Mantenga pulsado durante 3 segundos para desconectar el dispositivo actual y conectarse a un nuevo dispositivo (BT ID: Nova S40).
- 4 **“⏪”**: Bajar volumen
- 5 **“⏩”**: Subir volumen

Mando a distancia

- 1 “⏻”: **Botón de encendido**
Pulse para encender / Mantenga pulsado durante 3 segundos para apagar.
- 2 “≡”: **ARC**
Pulse para cambiar al canal HDMI ARC.
- 3 “📶”: **BT**
Pulse para cambiar al canal BT / Mantenga pulsado durante 3 segundos para desconectar el dispositivo actual y conectarse a un nuevo dispositivo. (BT ID: Nova S40).
- 4 “📺”: **OPT**
Pulse para cambiar al canal OPTICAL.
- 5 “🎧”: **AUX**
Pulse para cambiar al canal AUX.
- 6 “💡”: **LED**
Pulse para encender el LED, pulse de nuevo para apagarlo.
- 7 “🔌”: **USB**
Pulse para cambiar al canal USB.
- 8 “+”: **Subir volumen**
- 9 “-”: **Bajar volumen**
- 10 “<”: **Anterior**
Modo BT y USB: Salta a la pista anterior.
- 11 “>”: **Siguiente**
Modo BT y USB: Salta a la pista siguiente.
- 12 “▶||”: **Reproducir / Pausa**
Sólo para los modos BT y USB.
Modo USB: Mantenga pulsado durante 3 segundos para cambiar entre reproducción de bucle simple y reproducción de bucle de lista.
- 13 “MOVIE”: **MOVIE**
Pulse para cambiar al modo MOVIE, la pantalla mostrará: "E9 I".
- 14 “GAME”: **JUEGO**
Pulse para cambiar al modo JUEGO, la pantalla mostrará: "E9 2".
- 15 “MUSIC”: **MUSIC**
Pulse para cambiar al modo MÚSICA, la pantalla mostrará: "E9 3".
- 16 “BASS Mx”: **BASSMX™**
Pulse para ajustar el nivel de graves, la pantalla mostrará: "b5- I", "b5 0", "b5 I".
- 17 “🔇”: **Silenciar / Recuperar el volumen.**

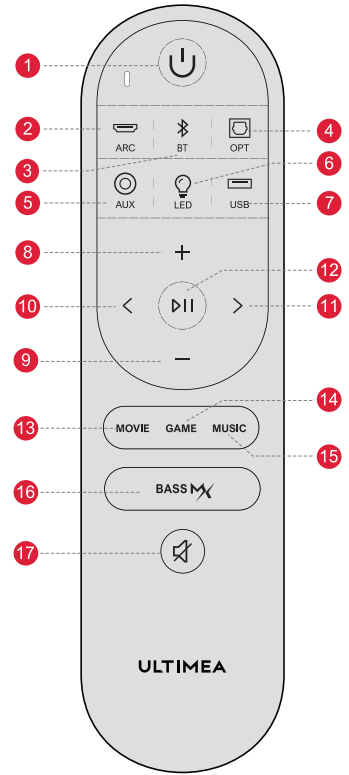

3 CONECTAR AL SUBWOOFER

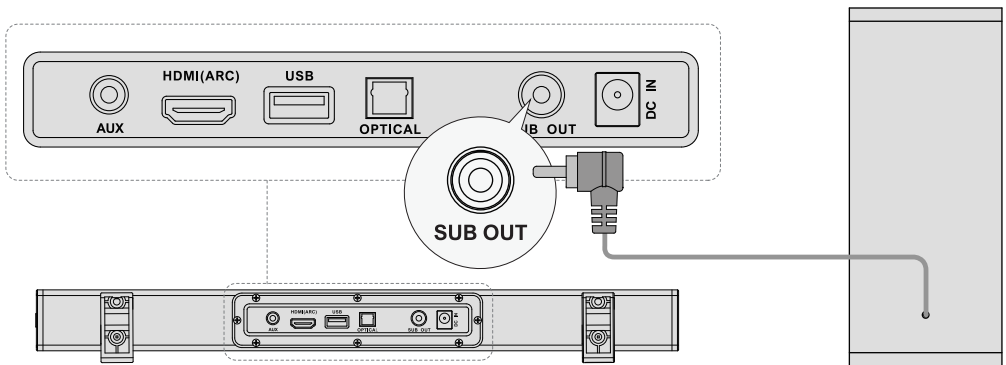

4 CONECTE AL TELEVISOR MEDIANTE HDMI ARC

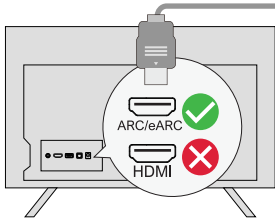

Paso 1:
Conecte un extremo del cable HDMI al puerto eARC / ARC de la parte posterior del televisor.

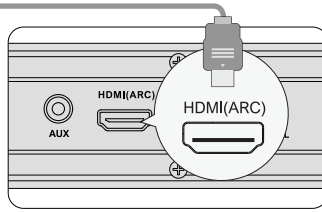

Paso 2:
A continuación, conecte el otro extremo al puerto HDMI (ARC) de la barra de sonido.

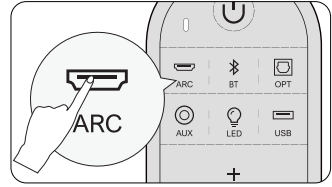

Paso 3:
Press "ARC" button on the remote control to select "HDMI (ARC)" input.

ES

En modo óptico: Si no hay sonido, pruebe a ajustar la salida de audio del televisor a PCM:
Ajustes TV > Inicio > Ajustes > Sonido > Salida de audio digital > PCM

Nota: Active la función "CEC" en su televisor.

Cuando ARC está conectado, el mando a distancia del televisor puede controlar la barra de sonido y el televisor simultáneamente:

- 1 Encender / apagar
- 2 Ajustar el volumen

5 CONEXIÓN AL TELEVISOR VÍA ÓPTICA / AUX

ÓPTICA

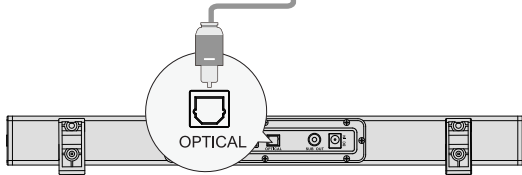
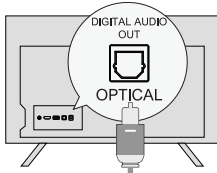

OPCIÓN 1: ÓPTICA

- 1 Asegúrese de que el cable está conectado al puerto OPTICAL OUT del televisor y el otro extremo al puerto OPTICAL de la barra de sonido.
- 2 Asegúrese de que el conector óptico está insertado correctamente como se muestra en la imagen. No inserte el enchufe al revés y rompa el conector óptico.

Nota: Si se reproduce audio por los altavoces internos del televisor, silencie o minimice el volumen del televisor.

AUX

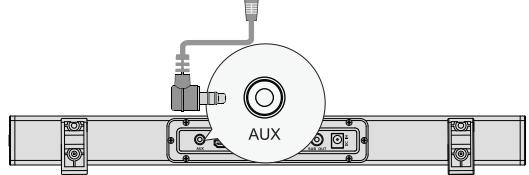
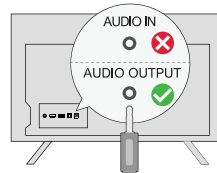

OPCIÓN 2: AUX

- 1 Conecte el cable de audio de 3,5 mm a 3,5 mm al puerto RCA AUDIO OUT de su televisor.
- 2 No es compatible con el puerto AUDIO IN del televisor.

Nota: Recuerde desconectar el cable AUX de la TV y de la barra de sonido cuando desee utilizar otro modo.

En modo óptico: Si no hay sonido, pruebe a ajustar la salida de audio del televisor a PCM:
Ajustes TV > Inicio > Ajustes > Sonido > Salida de audio digital > PCM

6 CONECTAR CON BLUETOOTH®

- 1 Pulse el botón "BT" de la barra de sonido o del mando a distancia para acceder al modo de emparejamiento Bluetooth.
- 2 Abra la configuración Bluetooth de su teléfono, busque y seleccione "Nova S40" para conectar la barra de sonido.

Nota: Si ya está en modo Bluetooth y conectado, mantenga pulsado el botón "BT" durante 3 segundos para desconectar el dispositivo actual y conectarse a un nuevo dispositivo manualmente en su teléfono móvil / PC / TV.

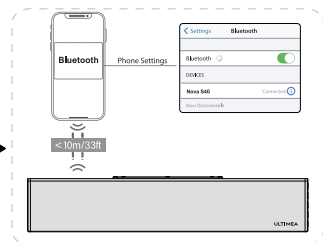
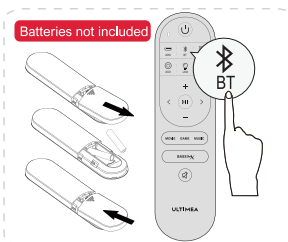
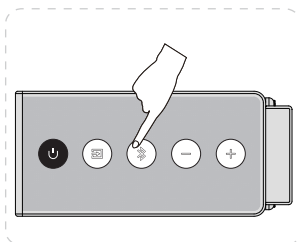

7 OPCIONES DE COLOCACIÓN

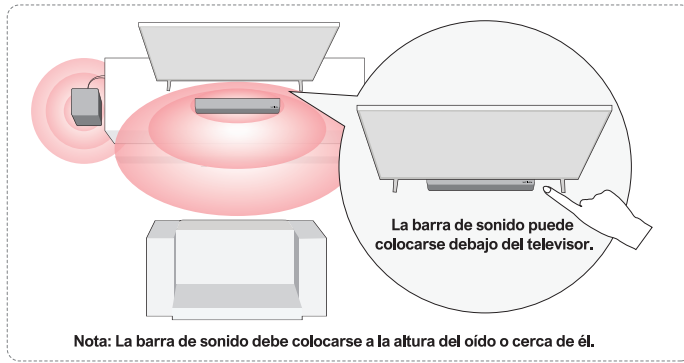

ES

8 INSTALACIÓN MURAL

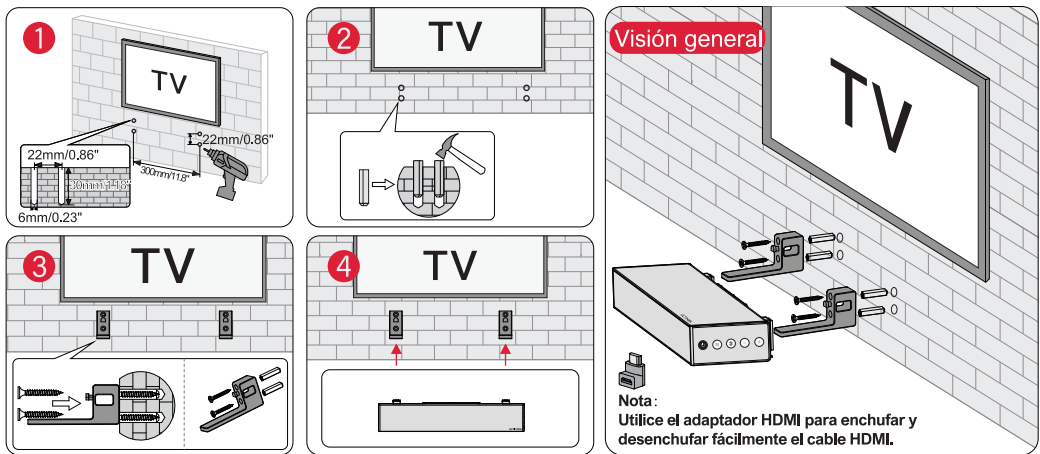

9 ESPECIFICACIONES

Número de modelo	U2100
Fuente de alimentación	AC 100-240V, ~50/60Hz
Controladores de la barra de sonido	(1.2" x 3.8") x 2 (Soundbar) + 5.25" (Subwoofer)
Respuesta en frecuencia	45Hz - 18kHz
Energía de reserva	<0.5W
Temperatura de funcionamiento	0°C - 45°C / 32°F - 113°F
Visión Bluetooth	5.3

Dimensiones y peso	
Soundbar	400(W) x 38(H) x 76(D)mm 15.7" x 1.5" x 3.0"
Subwoofer	270(W) x 115(H) x 270(D)mm 10.5" x 4.5" x 10.6"
Embalaje	332(W) x 432(H) x 190(D)mm 13.1" x 17" x 7.5"
Peso neto	3.3kg / 7.28lbs
Peso bruto	4.2kg / 9.26lbs

SAFETY INSTRUCTIONS

Please read this user manual carefully and save it for future reference.

Do not make unauthorized alterations to the product, doing so may compromise safety, regulatory compliance, system performance, and may void the warranty.

- Avoid dropping.
- Do not disassemble.
- Do not submerge in water
- Avoid extreme temperatures.
- Do not use the device outdoors during thunderstorms.
- Use original or certified cables.
- Do not place dangerous items on top of this device (e.g. liquid filled objects, lit candles).
- Clean with a dry, soft lint-free cloth. Do not use any corrosive cleaner or oil.
- To avoid hearing damage, do not listen for extended periods at high volume.
- Do not expose the batteries to extreme heat sources such as direct sunlight or open flames.
- The ideal operating temperature for this product and its accessories is between 41°F/5°C and 95°F/35°C.
- The adapter should be installed near the device and should be easily accessible.
- Do not use this product in environments of extreme heat or cold. Never expose this device to strong sunshine or wet environments.

PROPER DISPOSAL INSTRUCTIONS



This mark shown on the product or its packaging, indicates that this product should not be disposed of with other household waste at the end of its working life.

To prevent possible harm to the environment or human health from uncontrolled waste disposal, please separate this from other types of wastes and recycle it responsibly to promote the sustainable reuse of material resources.

Waste Electrical & Electronic Equipment

Household user should contact either the retailer where they purchased this product, or their local government office, for details of where and how they can take this item for environmentally safe recycling.

Business users should contact their suppliers and check the terms and conditions of the purchase contract. This product should not be mixed with other commercial wastes for disposal.

FCC REGULATORY COMPLIANCE

NOTE: This equipment has been tested and found to comply with the limits for a Class B digital device, pursuant to part 15 of the FCC Rules. These limits are designed to provide reasonable protection against harmful interference in a residential installation. This equipment generates uses and can radiate radio frequency energy and, if not installed and used in accordance with the instructions, may cause harmful interference to radio communications.

However, there is no guarantee that interference will not occur in a particular installation. If this equipment does cause harmful interference to radio or television reception, which can be determined by turning the equipment off and on, the user is encouraged to try to correct the interference by one or more of the following measures:

- Reorient or relocate the receiving antenna.
- Increase the separation between the equipment and the receiver.
- Connect the equipment to an outlet on a circuit different from that to which the receiver is connected.
- Consult the dealer or an experienced radio / TV technician for help.

Any changes or modifications not expressly approved by the party responsible for compliance could void the user's authority to operate the equipment.

This device complies with Part 15 of the FCC Rules.

Operation is subject to the following two conditions:

- (1) This device may not cause harmful interference.
- (2) This device must accept any interference received, including interference that may cause undesired operation.

This equipment complies with FCC radiation exposure limits set forth for an uncontrolled environment. This equipment should be installed and operated with a minimum distance of 20cm between the radiator & your body. This transmitter must not be co-located or operating in conjunction with any other antenna or transmitter.

ISED WARNINGS

This device contains licence-exempt transmitter (s) / receiver (s) that comply with Innovation, Science and Economic Development Canada's licence-exempt RSS (s). Operation is subject to the following two conditions:

- (1) This device may not cause interference.
- (2) This device must accept any interference, including interference that may cause undesired operation of the device.

L'émetteur/récepteur exempt de licence contenu dans le présent appareil est conforme aux CNR d'Innovation, Sciences et Développement économique Canada applicables aux appareils radio exempts de licence. L'exploitation est autorisée aux deux conditions suivantes:

- (1) L'appareil ne doit pas produire de brouillage;
- (2) L'appareil doit accepter tout brouillage radioélectrique subi, même si le brouillage est susceptible d'en compromettre le fonctionnement.

This equipment complies with IC exposure limits set forth for an uncontrolled environment. This equipment shall be installed and operated with a minimum distance of 20cm between the radiator & body.

Cet équipement est conforme aux limites d'exposition IC définies pour un environnement non contrôlé. Cet équipement doit être installé et utilisé avec une distance minimale de 20cm entre le radiateur et la carrosserie.

Declaration of Conformity

We (Manufacturer is responsible for this declaration)
Dyanic (Shenzhen) Technology Limited
(Company name)

20th Floor, Building 4, Tianan Cloud Park, Bantian St.,
Longgang District Shenzhen, China 518000
(Company address)

Declare under our sole responsibility that the product
Trade Mark: ULTIMEA
Product Name: Nova S40 2.1 Channel Soundbar with
Separate Subwoofer
Model No.: U2100

To which this declaration relates is in conformity with
the essential requirement set out in the Council Directive
on the Approximation of the laws of the Member States
relating to RED Directive (2014/53/EU) & RoHS (2011/
65/EU) product is responsible to affix CE marking, the
following standards were applied:

EN 55032:2015/A11:2020
EN 55035:2017/A11:2020
ENIEC 61000-3-2:2021
EN 61000-3-3:2013/A1:2021
ETSIEN 301 489-1 V2.2.3(2019-11)
ETSIEN 301 489-17 V3.2.4(2020-09)
EN 300 328 V2.2.2(2019-07)
EN 50663:2017
ENIEC 62368-1:2020+A11:2020
IEC62321-3-1:2013
IEC 62321-4:2013+A1:2017
IEC 62321-5:2013
IEC 62321-6:2015
IEC 62321-7-1:2015
IEC 62321-7-2:2017
IEC 62321-8:2017

Full Name: Yoyo.Yu
Position: Approbation Manager
Signature: 
Place/Date: Shenzhen, China/Dec. 25-2022

Trade Marks:



The Bluetooth® word mark and logos are registered trademarks owned by Bluetooth SIG, Inc. and any use of such marks by Soundlab Technology Co.,Ltd. is under license. Other trademarks and trade names are those of their respective owners.



The Adopted Trademarks HDMI, HDMI High-Definition Multimedia Interface, HDMI trade dress and the HDMI Logos are trademarks or registered trademarks of HDMI Licensing Administrator, Inc. in the United States and other.

ULTIMEA

Nova S40 2.1 Channel Soundbar with Separate Subwoofer
Model No.: U2100

 Dyanic GmbH
Buchenring 57, 22359 Hamburg, Germany

 UK Crossborder limited
7 Bell Yard London WC2A 2JR, UK United Kingdom
Made in China

Manufacturer: Dyanic (Shenzhen) Technology Limited
Address: 20th Floor, Building 4, Tianan Cloud Park, Bantian St.,
Longgang District, Shenzhen, China 518000

If you need our support, kindly reach out to our
service team. We are always glad to help.

+1 888-598-8875 (US)
Mon-Fri 9am-5pm (PST)
+49 89-628-25828 (EU)
Mon-Fri 9am-5pm (CET)
 support@ultimea.com
 support@ultimea.de
 support.ultimea.com
support.ultimea.de



@ultimea_official