

ULTIMEA

Dolby Atmos

HDMI™
HIGH-DEFINITION MULTIMEDIA INTERFACE

Bluetooth®



User Manual

Nova S80

EN: User Manual

FR: Manuel de l'Utilisateur

DE: Benutzerhandbuch

IT: Manuale d'uso

JP: ユーザーマニュアル

ES: Manual del usuario

Model No.: U4120

Nova S80 5.1.2 Channel Dolby Atmos Soundbar

Contents

01	User Manual	English
	Connection and Installation	02
07	Benutzerhandbuch	Deutsch
	Anschluss und Installation	08
13	ユーザーマニュアル	日本語
	接続と設置	14
19	Mode d'Emploi	Français
	Raccordement et installation	20
25	Manuale d'uso	Italiano
	Connessione e installazione	26
31	Manual del usuario	Español
	Conexión e instalación	32

User Manual

WE ARE
READY
TO HELP



support@ultimea.com



Model No.: U4120

Prefer video tutorial?

Setup guidance video, USER MANUAL or Trouble Shooting on ULTIMEA website.

@ultimea_official



support,ultimea.com

+1 888-598-8875 (US) Mon-Fri 9am-5pm (PST)
 +49 89-628-25828 (EU) Mon-Fri 9am-5pm (CET)

1 ACCESSORIES LIST

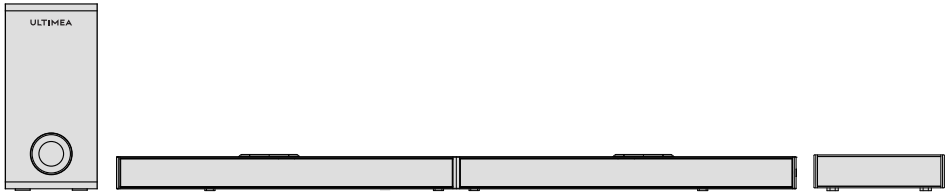

Subwoofer

Soundbar

Surround Speaker x 2



Power Adaptor

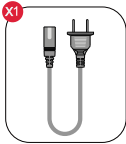

Subwoofer Power Cable

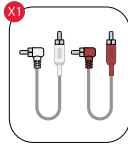

Stereo RCA to RCA Cable (6m)

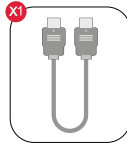

HDMI Cable

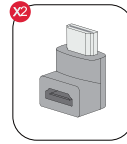

HDMI Adaptor

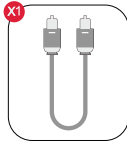

Digital Optical Cable

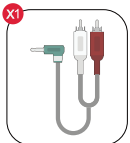

Stereo 3.5mm to RCA Audio Cable

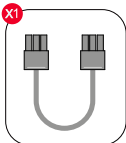

6-pin Cable for Soundbar Connection (140mm)



Remote Control

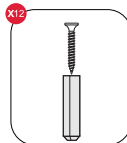

Wall Mounted Kit

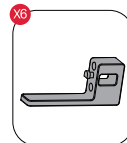

Wall Bracket



User Manual



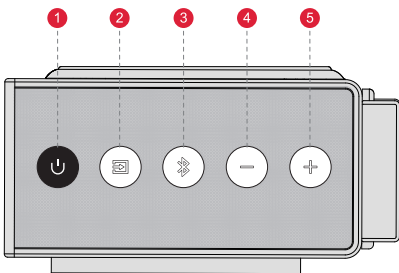





2 SOUNDBAR CONTROLS

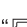
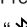
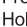

Control Panel

- 1 : **Power Button**
Press to power on / off.
- 2 : **Input Mode**
Press to switch channels: eARC-HD IN (HDMI IN)-OPT (OPTICAL) -BT-AUX-USB.
- 3 : **BT**
Press to switch to Bluetooth channel and enter pairing mode. Hold for 3 seconds to disconnect the current device and connect to a new device manually on your mobile phone / PC / TV (BT ID: Nova S80).
- 4 : **Volume Down**
- 5 : **Volume Up**

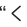
Remote Control

- 1 “”: **Power Button**
Press to power on / off.
- 2 “”: **eARC**
Press to switch to HDMI eARC channel.
- 3 “”: **HD IN**
Press to switch to HDMI IN channel.
- 4 “”: **OPT**
Press to switch to OPTICAL channel.
- 5 “”: **BT**
Press to switch to Bluetooth channel and enter pairing mode.
Hold for 3 seconds to disconnect current device and connect to a new device manually on your mobile phone / PC / TV (BT ID: Nova S80).
- 6 “”: **EQ**
Press to switch among Movie, Dialogue, Music mode, the display will show: “*MOVIE*”, “*JL06*”, “*MUSIC*”.
- 7 “”: **INPUT**
Press to switch channels: eARC-HD IN (HDMI IN)-OPT (OPTICAL)-BT-AUX-USB.
- 8 “+”: **Volume Up**
- 9 “-”: **Volume Down**
- 10 “<”: **Previous**
For BT and USB mode only: Skip to previous track.
- 11 “>”: **Next**
For BT and USB mode only: Skip to next track.
- 12 “”: **Play / Pause**
For BT and USB mode only.
USB mode: Hold for 3 seconds to switch between single loop playback and list loop playback.
- 13 “ **Dolby Atmos**
Press to adjust upward-firing sound level, the display will show: “*AT-1*”, “*AT 0*”, “*AT 1*”.
- 14 “”: **Surround**
Press to adjust surround sound level, the display will show: “*5R-2*”, “*5R-1*”, “*5R 0*”, “*5R 1*”.
- 15 “”: **BASSMAX**
Press to adjust bass level, the display will show: “*B5-4*”, “*B5-3*”, “*B5-2*”, “*B5-1*”, “*B5 0*”, “*B5 1*”, “*B5 2*”, “*B5 3*”, “*B5 4*”.
- 16 “”: Mute / Recover the volume.

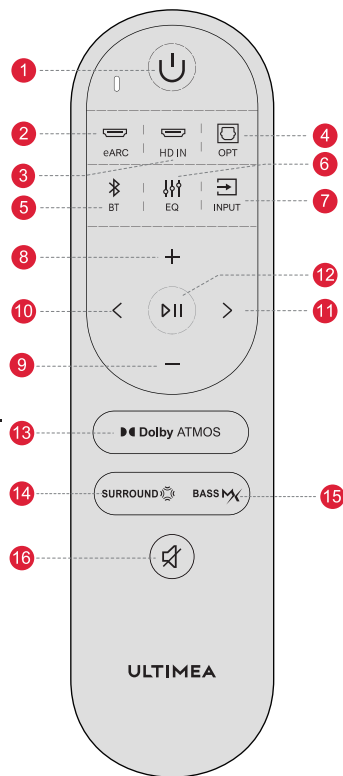

3 SOUNDBAR INSTALLATION

Assembly Steps

Step 1

Set the two parts of the Soundbar on the same level and align the connection joints. Connect the two parts by pushing parallelly to combine as one piece.

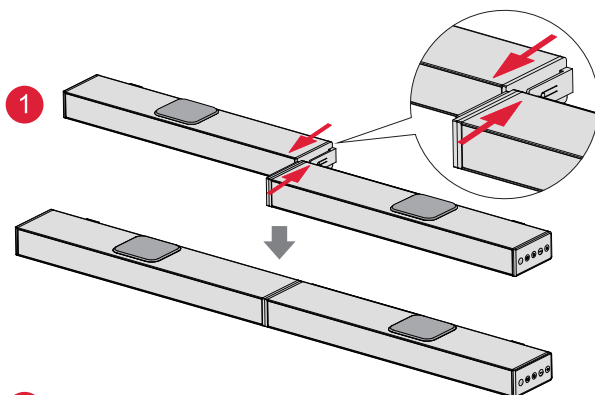

Step 2

Plug in 6pin Cable.

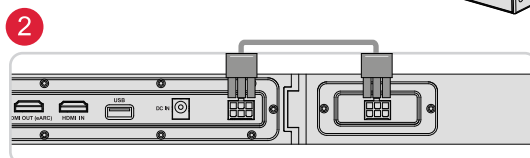

4 CONNECT TO TV VIA HDMI OUT eARC / ARC

EN

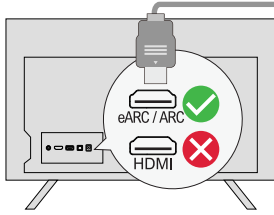

Step 1:
Connect one end of the HDMI cable to the eARC / ARC port on the back of your TV.

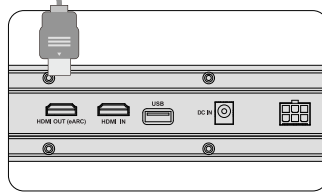

Step 2:
Then connect the other end into the HDMI OUT (eARC) port of the soundbar.

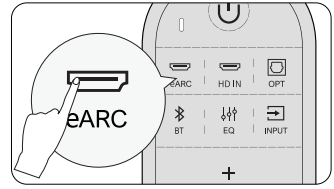

Step 3:
Press "eARC" button on the remote control to select "HDMI OUT (eARC)" input.

Note:

Make sure your TV HDMI supports eARC, otherwise the Dolby Atmos audio signal cannot be transmitted.

Atmos: If you are watching a movie in the Dolby Atmos format, please set the audio output on your TV to Pass Through:
TV Settings > Home > Settings > Sound > Digital Audio Output > Pass Through

DTS: If you are watching a movie in the DTS format, please set the audio output on your TV to PCM:
TV Settings > Home > Settings > Sound > Digital Audio Output > PCM

What's the difference between: HDMI IN, HDMI ARC, HDMI eARC?

HDMI IN is a standard HDMI input that allows you to connect devices to your TV or audio system. It supports audio and video signals, but it does not support audio return channel (ARC) or enhanced audio return channel (eARC) functionality.

HDMI ARC is a special HDMI port that supports two-way communication between your TV and audio system. This means that audio can be sent from your TV to your audio system, and audio system can send audio back to your TV.

HDMI eARC (Enhanced Audio Return Channel) is an updated version of HDMI ARC that supports higher quality audio formats such as Dolby Atmos and DTS:X.

Note: Please turn on the "CEC" function on your TV.

When eARC / ARC is connected, your TV remote control can control the soundbar and TV simultaneously:

- 1 Turn on / off
- 2 Adjust the volume

5 CONNECT TO OTHER DEVICE VIA HDMI IN

Step 1

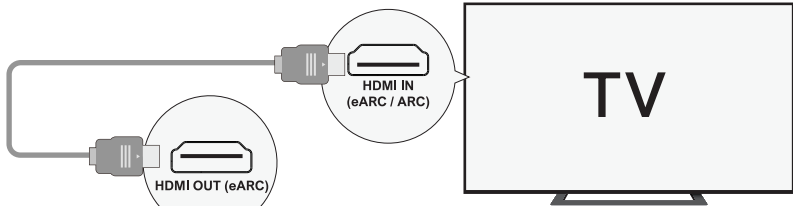

Step 2

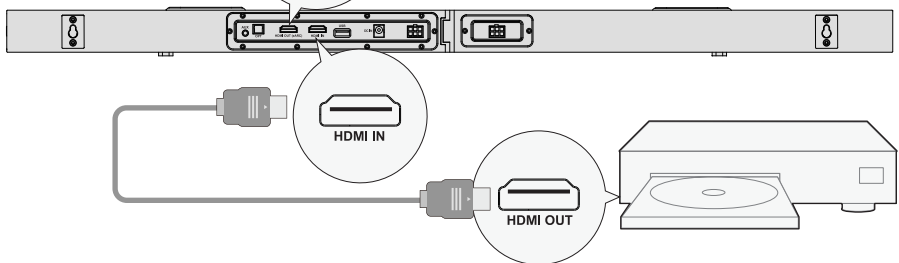

Step 3

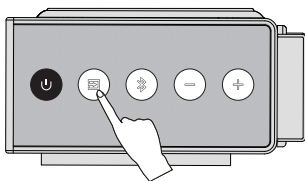

Step 1: Connect the HDMI Cable to the HDMI OUT (eARC) port on the Soundbar and the other end to the eARC / ARC port on the TV.

Step 2: Connect the HDMI cable to the HDMI OUT port on the other device (Such as DVD or game console) and the other end to HDMI IN port on the Soundbar.

Step 3: Press "Source" button on Soundbar or Remote Control to switch to HDMI IN channel.

6 CONNECT TO TV VIA OPTICAL / AUX

EN

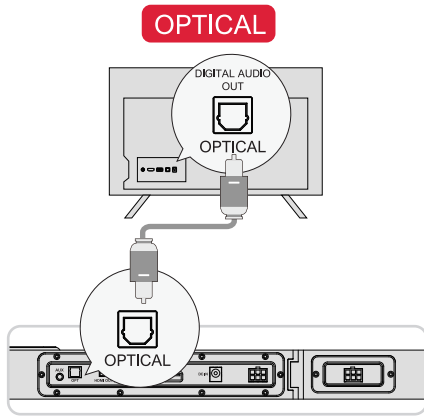

OPTICAL

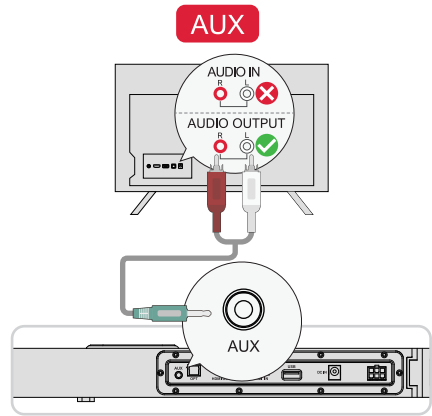

AUX

OPTION 1: OPTICAL

- 1 Make sure the cable is connected to OPTICAL OUT port on your TV, and the other end to OPTICAL port on the Soundbar.
- 2 Make sure the optical plug is inserted correctly as it shows in the picture. Do not insert the plug upside down and break the optical.

Note: If audio is coming from the internal TV speakers, mute or minimize the TV volume.

OPTION 2: AUX

- 1 Connect the 3.5mm RCA audio cable to connect to your TV's RCA AUDIO OUT port.
- 2 Make sure the color of the cables ends matches the color of the TV ports.

Note: Please remember to unplug the AUX cable from TV and Soundbar when you want to switch other mode.

In Optical Mode: If there is no sound, try setting the TV audio output to PCM: TV Settings > Home > Settings > Sound > Digital Audio Output > PCM

7 CONNECT TO BLUETOOTH

- 1 Press the "Bluetooth" button on the soundbar or remote control to enter Bluetooth pairing mode.
- 2 Open your phone's Bluetooth settings, find and select "Nova S80" to connect the soundbar.

Note: If it's already in the Bluetooth mode and connected, press and hold "Bluetooth" button for 3 seconds to disconnect current device and connect to new device manually on your mobile phone / PC / TV.

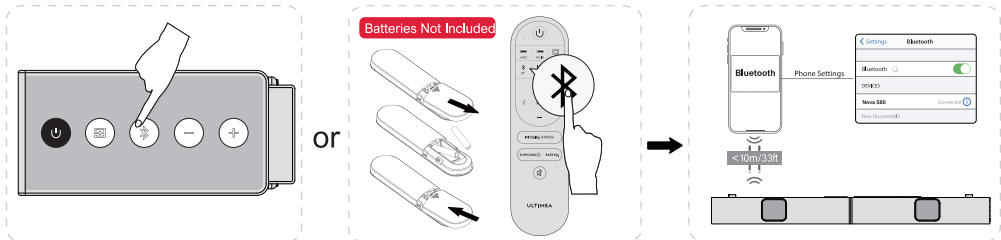

8 CONNECT TO SUBWOOFER AND SURROUND SPEAKERS

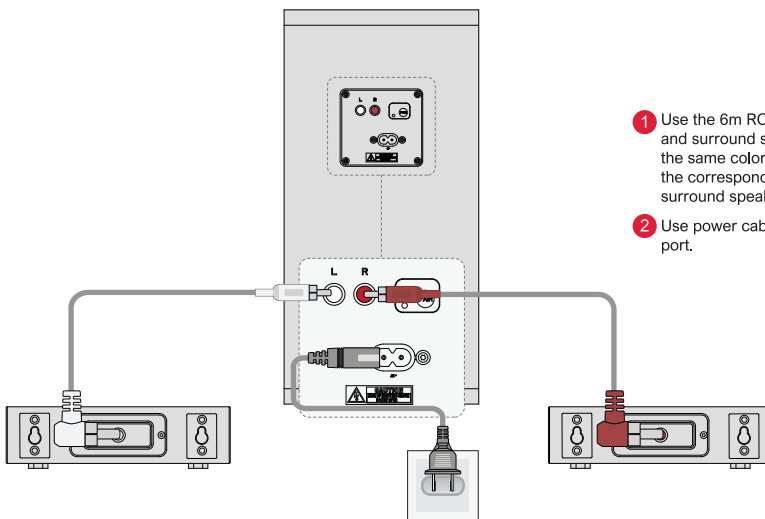

- 1 Use the 6m RCA-RCA cables to connect the subwoofer and surround speakers, please pay attention to match the same color interfaces on the surround speakers with the corresponding ones on the subwoofer and place the surround speakers accordingly.
- 2 Use power cable to connect your subwoofer and power port.

9 PAIRING SUBWOOFER

EN

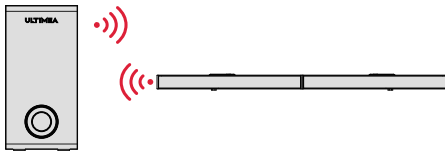

The subwoofer has been paired with the soundbar by ULTIMEA.
If there is no sound coming from the subwoofer, you need to re-pair the Soundbar with the subwoofer.



Step 1

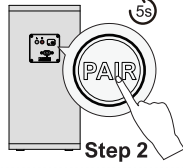

Step 2

Step 1

Press and hold the "BASS+" button on the remote control for 5 seconds, the display will show "SUB" flashing.

Step 2

Press and hold the PAIR button on subwoofer for 5 seconds, the white LED will be fast flashing.

The white LED will be always on when the subwoofer is paired successfully.

10 PLACEMENT OPTIONS

Full 360° Surround (Better Surround)

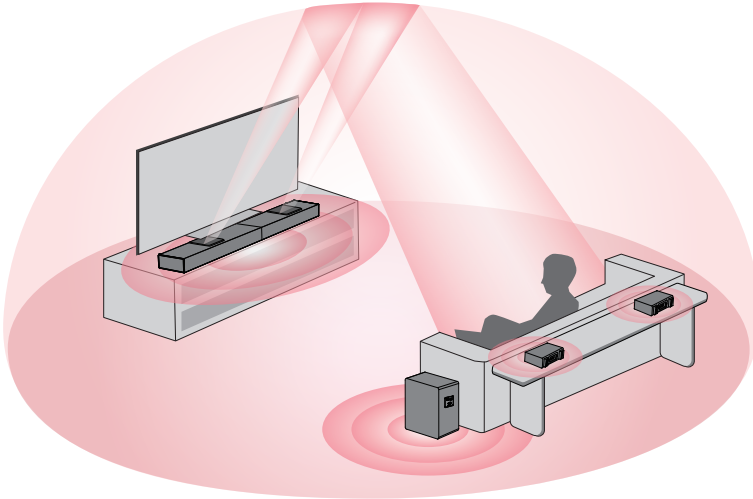

Front Surround

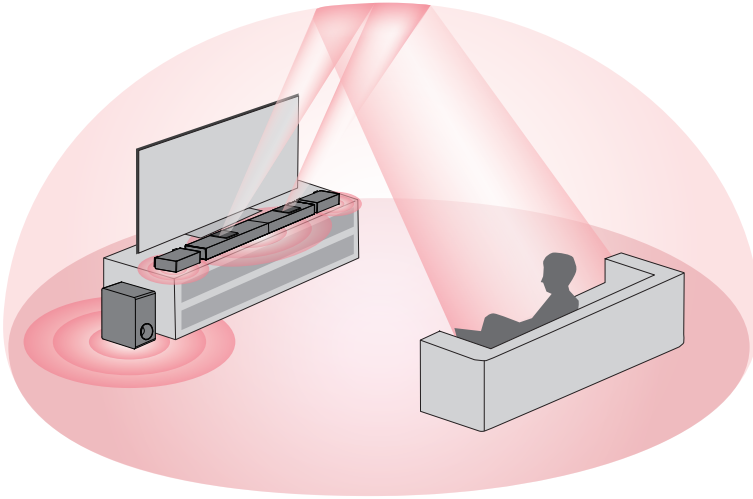

- 1 For a better listening experience, please choose one of the two placement options shown in the illustration above based on your home environment.
- 2 The soundbar and surround speakers should be placed at or near ear level.

11 WALL MOUNT INSTALLATION

EN

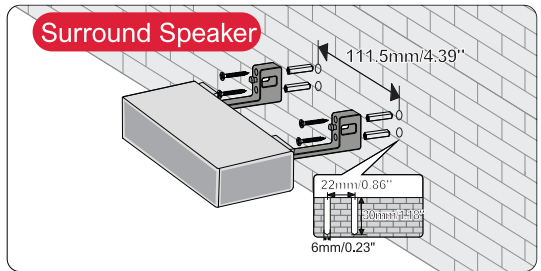
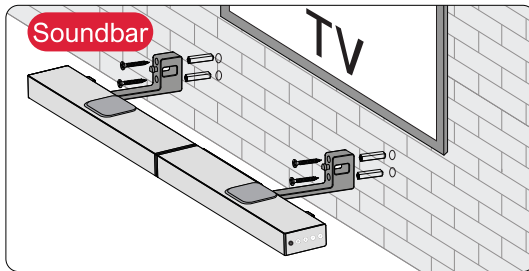
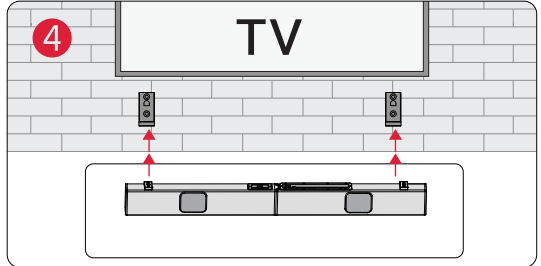
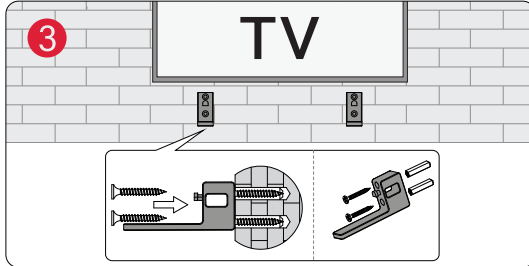
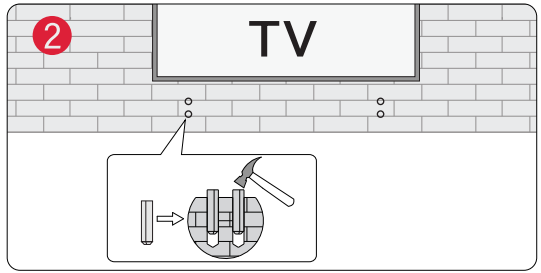
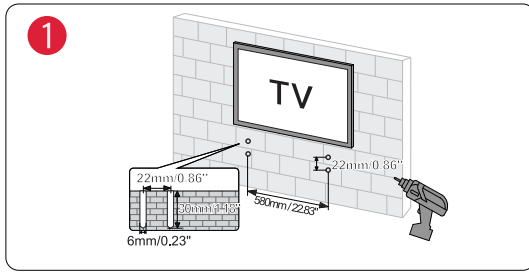

Note: Please use the HDMI Adaptor for easy plugging and unplugging of the HDMI Cable.

12 SPECIFICATIONS

Model Number	U4120
Power Supply	AC 100-240V, ~50/60Hz
Soundbar Drivers	(3.1" x 1.2") x 3 (Soundbar) + 1.8" x 2 (upward-firing Driver) + (3.1" x 1.2") x 2 (Surround Speaker) + 8" (Subwoofer)
Frequency Response	35Hz - 18kHz
Standby Power	<0.5W
Operating Temperature	0°C - 45°C / 32°F - 113°F
Bluetooth Version	5.3

Dimensions and Weight		
Soundbar	800(W) x 38(H) x 90(D)mm	31.5" x 1.5" x 3.5"
Subwoofer	315(W) x 385(H) x 190(D)mm	12.4" x 15.2" x 7.5"
Surround Speaker	150(W) x 38(H) x 82(D)mm	5.9" x 1.5" x 3.2"
Packaging	472(W) x 306(H) x 430(D)mm	15.6" x 12" x 16.9"
Net Weight	6.7kg / 14.77lbs	
Gross Weight	8.94kg / 19.71lbs	

Benutzerhandbuch



Modell Nr.: U4120

WIR SIND
BEREIT ZU
HELFEN



support@ultimea.com

DE

Bevorzugen Sie ein Video-Tutorial?

Setup-Anleitung Video, oder USER MANUAL auf ULTIMEA Website.



@ultimea_official



support.ultimea.com

+1 888-598-8875 (US) Mon-Fri 9am-5pm (PST)
+49 89-628-25828 (EU) Mon-Fri 9am-5pm (CET)

1 ZUBEHÖRLISTE

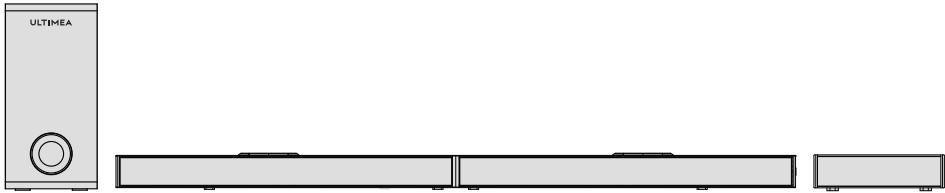

Subwoofer

Soundbar

Surround-Lautsprecher x 2



Netzadapter

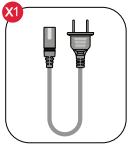

Subwoofer-Netzkabel

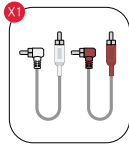

Stereo RCA auf RCA Audiokabel (6m)

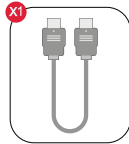

HDMI-Kabel

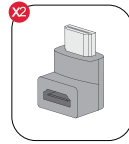

HDMI-Adapter

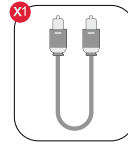

Optisches Digitalkabel

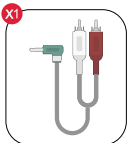

Stereo 3.5mm auf RCA Audiokabel

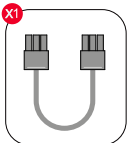

6-pin Kabel für Soundbar-Anschluss (140mm)



Fernbedienung

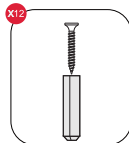

Wandmontage-Kit

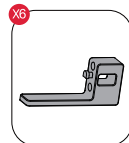

Wandhalterung



Benutzerhandbuch

2 SOUNDBAR-BEDIENELEMENTE

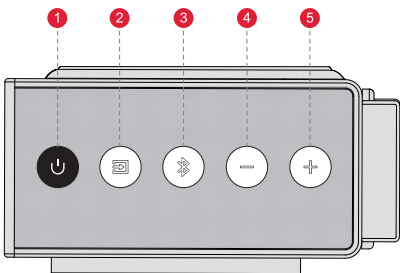

Bedienfeld

- 1 "⏻": **Einschalttaste**
Drücken Sie diese Taste, um das Gerät ein- und auszuschalten..
- 2 "📺": **Eingangsmodus**
Um den Kanal zu wechseln: eARC-HD IN (HDMI IN)-OPT (OPTICAL)-BT-AUX-USB.
- 3 "📶": **BT**
Um zum Bluetooth-Kanal zu wechseln und den Kopplungsmodus zu aktivieren. Halten Sie die Taste 3 Sekunden lang gedrückt, um die Verbindung mit dem aktuellen Gerät zu trennen und sich manuell mit einem neuen Gerät auf Ihrem Mobiltelefon / PC / Fernseher zu verbinden. (BT ID: Nova S80).
- 4 "⏪": **Lautstärke verringern**
- 5 "⏩": **Lauter**

Fernsteuerung

- 1 "⏻": **Einschalttaste**
Drücken Sie diese Taste, um das Gerät ein- und auszuschalten.
- 2 "eARC": **eARC**
Um zum HDMI eARC-Kanal zu wechseln.
- 3 "HD IN": **HD IN**
Um zum HDMI IN-Kanal zu wechseln.
- 4 "OPT": **OPT**
Um zum OPTICAL-Kanal zu wechseln.
- 5 "BT": **BT**
Um zum Bluetooth-Kanal zu wechseln und den Kopplungsmodus zu aktivieren. Halten Sie die Taste 3 Sekunden lang gedrückt, um die Verbindung mit dem aktuellen Gerät zu trennen und sich manuell mit einem neuen Gerät auf Ihrem Mobiltelefon / PC / Fernseher zu verbinden. (BT ID: Nova S80).
- 6 "EQ": **EQ**
Um zwischen den Modi Film, Dialog und Musik umzuschalten; auf dem Display wird angezeigt: "MOV I", "DIALOG", "MUSIC".
- 7 "INPUT": **INPUT**
Zum Umschalten der Kanäle drücken: eARC-HD IN (HDMI IN)-OPT (OPTICAL)-BT-AUX-USB.
- 8 "+": **Lautstärke aufwärts**
- 9 "-": **Lautstärke runter**
- 10 "<": **Zurück**
BT- und USB-Modus: Zum vorherigen Titel springen.
- 11 ">": **Nächster**
BT- und USB-Modus: Sprung zum nächsten Titel.
- 12 "⏸": **Wiedergabe/Pause**
USB-Modus: Halten Sie die Taste 3 Sekunden lang gedrückt, um zwischen Einzelschleifenwiedergabe und Listenschleifenwiedergabe umzuschalten.
- 13 "Dolby ATMOS": **Dolby Atmos**
Drücken Sie, um die Lautstärke der oberen Lautsprecher einzustellen, auf dem Display wird angezeigt: "AT- 1", "AT 0", "AT 1".
- 14 "SURROUND": **Surround**
Drücken Sie zum Einstellen des Surround-Sound-Pegels, auf dem Display erscheint angezeigt: "SR-2", "SR- 1", "SR 0", "SR 1".
- 15 "BASSMAX": **BASSMAX**
Drücken Sie diese Taste, um den Basspegel einzustellen; auf dem Display wird angezeigt: "BS-4", "BS-3", "BS-2", "BS- 1", "BS 0", "BS 1", "BS 2", "BS 3", "BS 4".
- 16 "🔊": **Stummschaltung / Wiederherstellung der Lautstärke.**

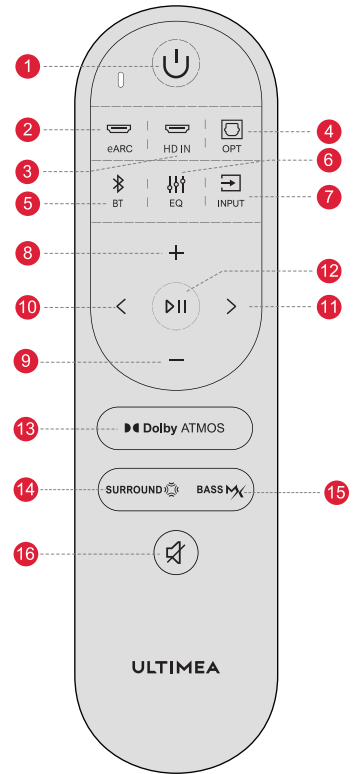

3 SOUNDBAR-INSTALLATION

Montageschritte

Schritt 1

Stellen Sie die beiden Teile der Soundbar auf die gleiche Höhe und richten Sie die Verbindungsstellen aus. Verbinden Sie die beiden Teile durch paralleles Schieben, um sie zu einem Stück zusammenzufügen.

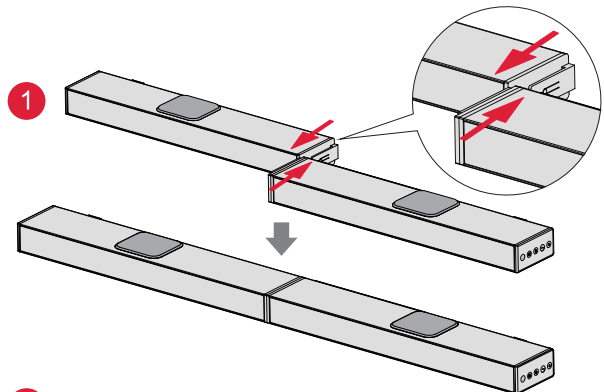

Schritt 2

6-pin Kabel einstecken.

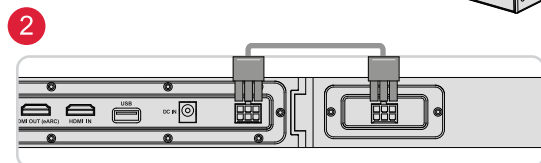

4 ANSCHLUSS AN DEN TV VIA HDMI OUT eARC / ARC

DE

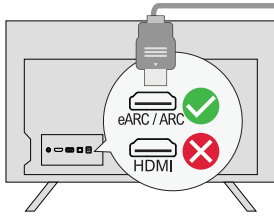

Schritt 1:

Schließen Sie ein Ende des HDMI-Kabels an den eARC / ARC Anschluss auf der Rückseite Ihres Fernsehers an.

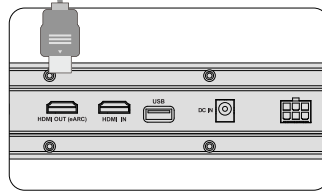

Schritt 2:

Schließen Sie dann das andere Ende an den HDMI (eARC)-Anschluss der Soundbar an.

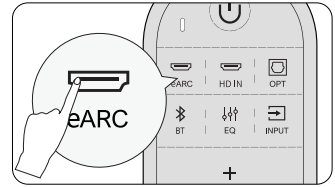

Schritt 3:

Drücken Sie die Taste "eARC" auf der Fernbedienung, um den Eingang "HDMI OUT (eARC)" auszuwählen.

Hinweis:

Der HDMI-Anschluss Ihres Fernsehers muss eARC unterstützen, um das Dolby Atmos-Audioformat an Ihre Soundbar zu übertragen.

Atmos: Wenn Sie einen Film im Dolby Atmos-Format ansehen, stellen Sie bitte den Audioausgang an Ihrem Fernseher auf Pass Through: TV-Einstellungen > Home > Einstellungen > Ton > Digitaler Audioausgang > Pass Through

DTS: Wenn Sie sich einen Film im DTS-Format ansehen, stellen Sie den Audioausgang an Ihrem Fernseher bitte auf PCM: TV-Einstellungen > Home > Einstellungen > Ton > Digitaler Audioausgang > PCM

Was ist der Unterschied zwischen: HDMI IN, HDMI ARC, HDMI eARC?

HDMI IN ist ein Standard-HDMI-Eingang, über den Sie Geräte an Ihren Fernseher oder Ihr Audiosystem anschließen können. Er unterstützt Audio- und Videosignale, aber keine Audio-Rückkanal- (ARC) oder erweiterte Audio-Rückkanal- (eARC) Funktionalität.

HDMI ARC ist ein spezieller HDMI-Anschluss, der die Zwei-Wege-Kommunikation zwischen Ihrem Fernsehgerät und Ihrem Audiosystem unterstützt. Das bedeutet, dass Audiosignale von Ihrem Fernseher an Ihr Audiosystem gesendet werden können und das Audiosystem Audiosignale zurück an Ihren Fernseher senden kann.

HDMI eARC (Enhanced Audio Return Channel) ist eine aktualisierte Version von HDMI ARC, die höherwertige Audioformate wie Dolby Atmos und DTS:X unterstützt.

Hinweis: Bitte schalten Sie die "CEC"-Funktion an Ihrem Fernseher ein.

Wenn eARC / ARC angeschlossen ist, kann Ihre TV-Fernbedienung die Soundbar und den Fernseher gleichzeitig steuern: ① Einschalten / Ausschalten ② Lautstärke einstellen

5 ANSCHLUSS AN EIN ANDERES GERÄT ÜBER HDMI IN

Schritt 1

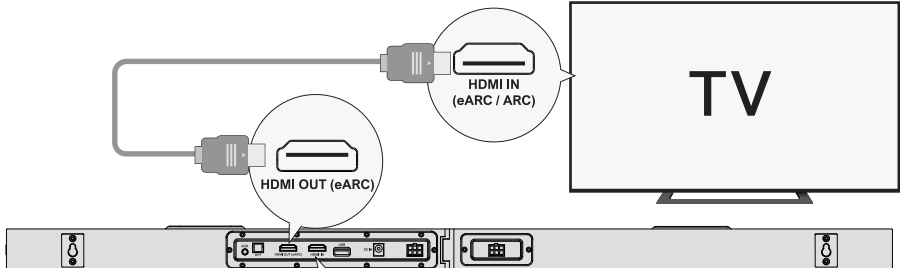

Schritt 2

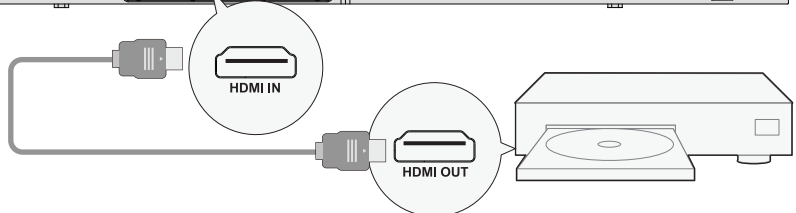

Schritt 3

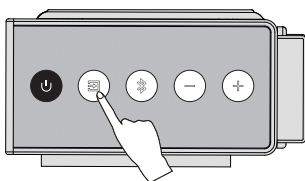

Schritt 1: Verbinden Sie das HDMI-Kabel mit dem Anschluss HDMI OUT (eARC) an der Soundbar und das andere Ende mit dem Anschluss eARC / ARC am Fernsehgerät.

Schritt 2: Schließen Sie das HDMI-Kabel an den HDMI OUT-Anschluss des anderen Geräts (z. B. DVD oder Spielkonsole) und das andere Ende an den HDMI IN-Anschluss der Soundbar an.

Schritt 3: Drücken Sie die Taste "HDMI" auf der Soundbar oder der Fernbedienung, um zum HDMI IN-Kanal.

6 ANSCHLUSS AN FERNSEHER ÜBER OPTISCH / AUX

DE

OPTISCH

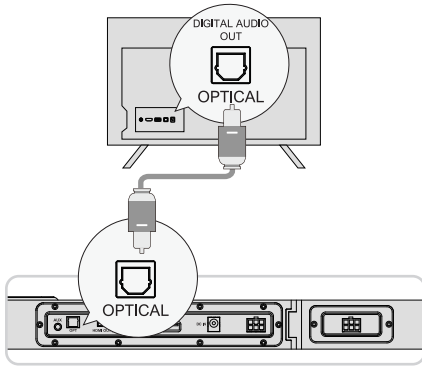

OPTION 1: OPTISCH

- 1 Stellen Sie sicher, dass das Kabel an den OPTICAL OUT-Anschluss Ihres Fernsehers und das andere Ende an den OPTICAL-Anschluss der Soundbar angeschlossen ist.
- 2 Vergewissern Sie sich, dass der optische Stecker richtig eingesteckt ist, wie auf dem Bild zu sehen. Stecken Sie den Stecker nicht verkehrt herum ein, um das optische Kabel nicht zu beschädigen.

Hinweis: Wenn der Ton über die internen TV-Lautsprecher wiedergegeben wird, schalten Sie die Lautstärke des Fernsehers stumm oder verringern Sie sie.

Im optischen Modus: Wenn kein Ton zu hören ist, versuchen Sie, den Audioausgang des Fernsehers auf PCM einzustellen:
TV-Einstellungen > Home > Einstellungen > Ton > Digitaler Audioausgang > PCM

AUX

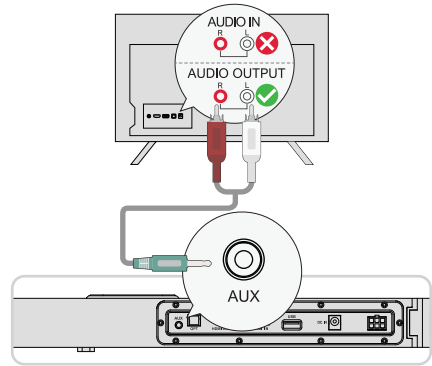

OPTION 2: AUX

- 1 Schließen Sie das 3,5-mm-Cinch-Audiokabel an den RCA-AUDIO OUT-Anschluss Ihres Fernsehers an.
- 2 Achten Sie darauf, dass die Farbe der Kabelenden mit der Farbe der TV-Anschlüsse übereinstimmen.

Hinweis: Bitte denken Sie daran, das AUX-Kabel vom Fernseher und der Soundbar zu trennen, wenn Sie in einen anderen Modus wechseln möchten.

7 MIT BLUETOOTH VERBINDEN

- 1 Drücken Sie die Taste "Bluetooth" auf der Soundbar oder der Fernbedienung, um den Bluetooth-Kopplungsmodus zu aktivieren.
- 2 Öffnen Sie die Bluetooth-Einstellungen Ihres Telefons, suchen und wählen Sie "Nova S80", um die Soundbar zu verbinden.

Hinweis: Wenn sich das Gerät bereits im Bluetooth-Modus befindet und verbunden ist, halten Sie die Taste "Bluetooth" 3 Sekunden lang gedrückt, um die Verbindung mit dem aktuellen Gerät zu trennen und manuell eine Verbindung mit einem neuen Gerät zu Ihrem Mobiltelefon / PC / Fernseher herzustellen.

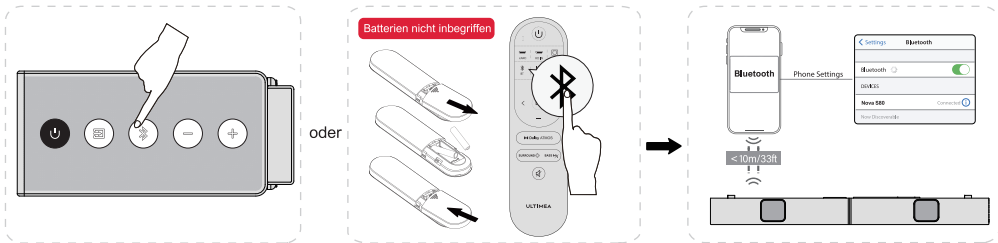

8 ANSCHLUSS AN SUBWOOFER UND SURROUND-LAUTSPRECHER

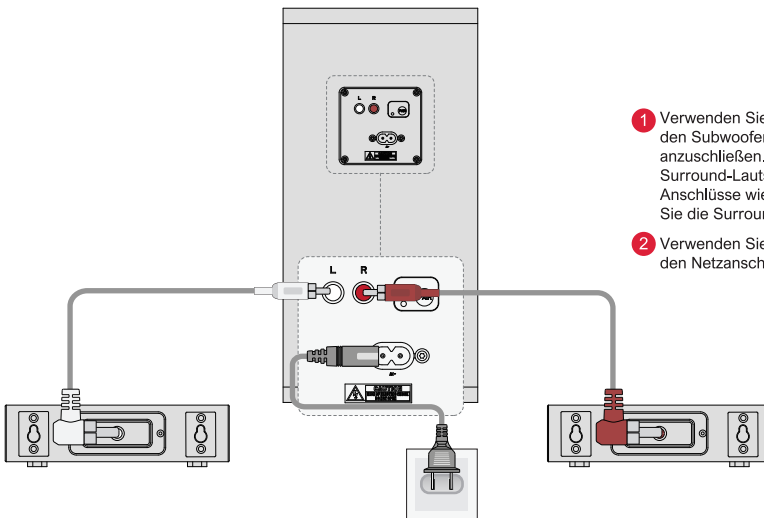

- 1 Verwenden Sie die 6 m langen Cinch-Cinch-Kabel, um den Subwoofer und die Surround-Lautsprecher anzuschließen. Achten Sie darauf, dass die Surround-Lautsprecher die gleichen farbigen Anschlüsse wie der Subwoofer haben, und platzieren Sie die Surround-Lautsprecher entsprechend.
- 2 Verwenden Sie ein Netzkabel, um den Subwoofer und den Netzanschluss zu verbinden.

9 SUBWOOFER KOPPELN

DE

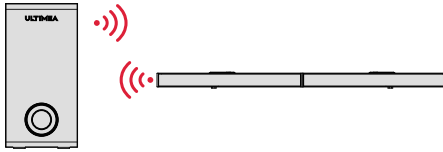

Der Subwoofer wurde von ULTIMEA automatisch mit der Soundbar gepaart.
Wenn kein Ton aus dem Subwoofer kommt, müssen Sie die Soundbar erneut mit dem Subwoofer koppeln.



Schritt 1

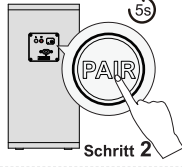

Schritt 2

Schritt 1

Halten Sie die Taste "BASS M" auf der Fernbedienung 5 Sekunden lang gedrückt, auf dem Display blinkt "SUB".

Schritt 2

Halten Sie die PAIR-Taste am Subwoofer 5 Sekunden lang gedrückt, die weiße LED blinkt nun schnell.

Die weiße LED leuchtet immer, wenn der Subwoofer erfolgreich gepaart wurde.

10 PLATZIERUNGSMÖGLICHKEITEN

Vollständiger 360°-Surround (besserer Surround)

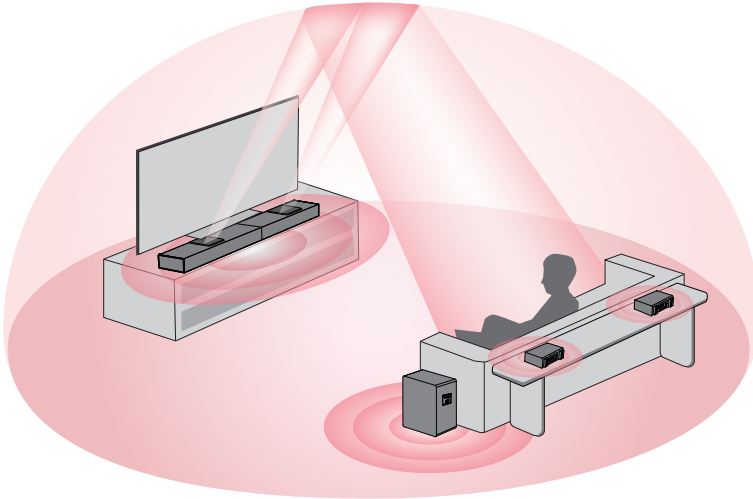

Front Surround

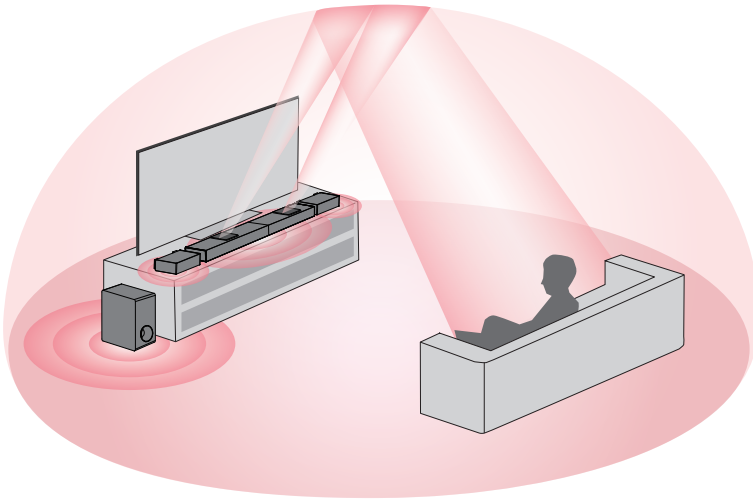

- 1 Für ein besseres Hörerlebnis wählen Sie bitte eine der beiden in der obigen Abbildung gezeigten Aufstellungsmöglichkeiten, je nach Ihrer Wohnumgebung.
- 2 Die Soundbar sollte in Ohrhöhe oder in der Nähe des Ohres aufgestellt werden.

11 WANDBEFESTIGUNG

DE

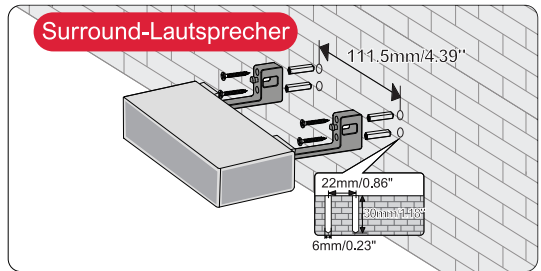
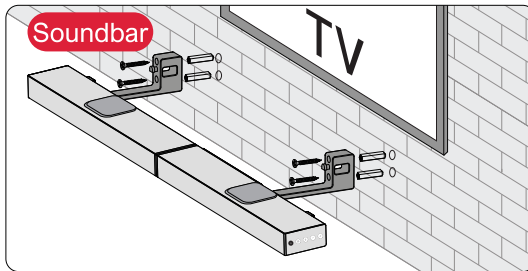
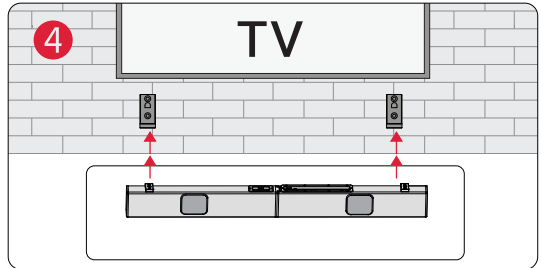
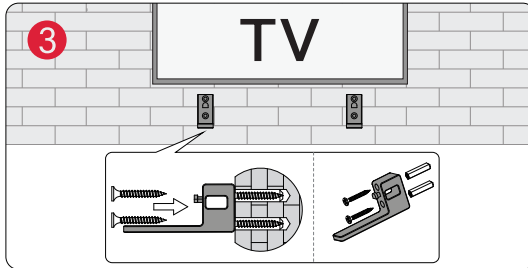
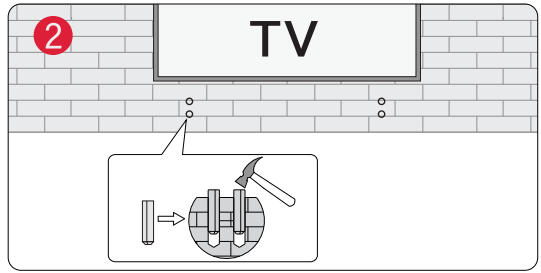
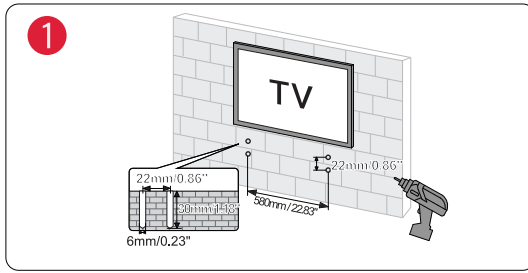

Hinweis: Bitte verwenden Sie den HDMI-Adapter, um das HDMI-Kabel einfach ein- und ausstecken zu können.

12 SPEZIFIKATIONEN

Modell-Nummer	U4120
Stromversorgung	AC 100-240V, ~50/60Hz
Soundbar-Treiber	(3.1" x 1.2") x 3 (Soundbar)+ 1.8" x 2 (aufwärts gerichtete Treiber) + (3.1" x 1.2") x 2 (Surroundbar Speaker) +8" (Subwoofer)
Frequenzgang	35Hz - 18kHz
Standby-Leistung	<0.5W
Betriebstemperatur	0°C - 45°C / 32°F - 113°F
Bluetooth Vision	5.3

Abmessungen und Gewicht		
Soundbar	800(W) x 38(H) x 90(D)mm	31.5" x 1.5" x 3.5"
Subwoofer	315(W) x 385(H) x 190(D)mm	12.4" x 15.2" x 7.5"
Surround-Lautsprecher	150(W) x 38(H) x 82(D)mm	5.9" x 1.5" x 3.2"
Verpackung	472(W) x 306(H) x 430(D)mm	15.6" x 12" x 16.9"
Nettogewicht	6.7kg / 14.77lbs	
Bruttogewicht	8.94kg / 19.71lbs	

ULTIMEA

Nova S80

ユーザーマニュアル



モデル番号: U4120

お手伝
いた
します



support@ultimea.com

JP

ビデオチュートリアル
をご希望ですか?

セットアップガイドンスのビデオ、またはULTIMEAウェブサイトのユーザーマニュアルをご覧ください。



support.ultimea.com

Twitter Facebook YouTube Instagram
@ultimea_official

+1 888-598-8875 (US) Mon-Fri 9am-5pm (PST)
+49 89-628-25828 (EU) Mon-Fri 9am-5pm (CET)

1 アクセサリーリスト



サウンドバー

サブウーファー

サラウンドスピーカー×2

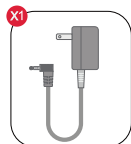

電源アダプター

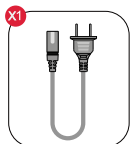

サブウーファー
電源ケーブル

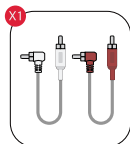

ステレオRCA-RCAオーディオケーブル(6m)

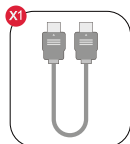

HDMIケーブル

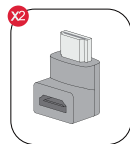

HDMIアダプター

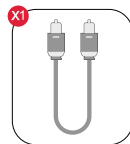

デジタル光ケーブル

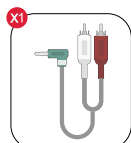

3.5mm-RCAオーディオケーブル

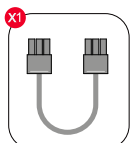

サウンドバー接続用6ピンケーブル(140mm)



リモコン

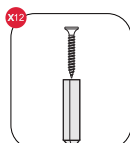

壁掛けネジキット

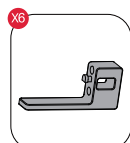

壁掛け固定スタンド



ユーザーマニュアル

2 サウンドバーのコントロール

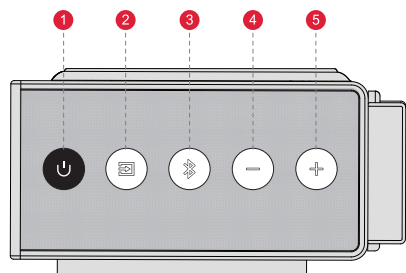

コントロールパネル

- 1 “”：電源ボタン
一回押すと電源がオン/オフ。
- 2 “”：「入力モード」
押してチャンネルを切り替える：eARC-HD IN (HDMI IN)-OPT (OPTICAL)-BT-AUX-USB。
- 3 “”：BT
を押すとBTチャンネルに切り替わります。
(BT ID: Nova S80)。
- 4 “”：ボリュームダウン
- 5 “”：ボリューム・アップ

リモコン

JP

- ① “**⏻**”：電源ボタン
一回押すと電源がオン/オフ。
- ② “**eARC**”：eARC
押すとHDMI eARCに切り替えます。
- ③ “**HD IN**”：HD IN
押すとHDMI INに切り替えます。
- ④ “**OPT**”：OPT
押すとOPTICALに切り替えます。
- ⑤ “**BT**”：BT
を押すとBTチャンネルに切り替わります。
(BT ID: Nova S80).
- ⑥ “**EQ**”：EQ
を押して映画、対話、音楽モードを切り替えます：
“**MOVIE**”，“**JLDS**”，“**MUSIC**”。
- ⑦ “**INPUT**”：INPUT
を押してチャンネルを切り替えます：eARC-HD IN (HDMI IN) -
OPT (OPTICAL)-BT-AUX-USB。
- ⑧ “**+**”：ボリュームアップ
- ⑨ “**-**”：ボリュームダウン
- ⑩ “**<**”：前
BTおよびUSBモード：前のトラックにスキップします。
- ⑪ “**>**”：次へ
BTおよびUSBモード：次のトラックにスキップします。
- ⑫ “**⏮**”：再生/一時停止
BTおよびUSBモードのみ
USBモード：3秒間長押しすると、シングルループ再生とリストループ再生が切り替わります。
- ⑬ “**Dolby ATMOS**”：ドルビーアトモス
を押してトップドライバーのサウンドレベルを調整します：“**AT-1**”，“**AT 0**”，“**AT 1**”と表示されます。
- ⑭ “**SURROUND**”：サラウンド
を押してサラウンドレベルを調整します：“**SR-2**”，“**SR-1**”，“**SR 0**”，“**SR 1**”と表示されます。
- ⑮ “**BASS MX**”：バスマックス
を押して低音レベルを調整します：“**BS-4**”，“**BS-3**”，“**BS-2**”，“**BS-1**”，“**BS 0**”，“**BS 1**”，“**BS 2**”，“**BS 3**”，“**BS 4**”。
- ⑯ “**🔇**”：音量ミュート/リストア。

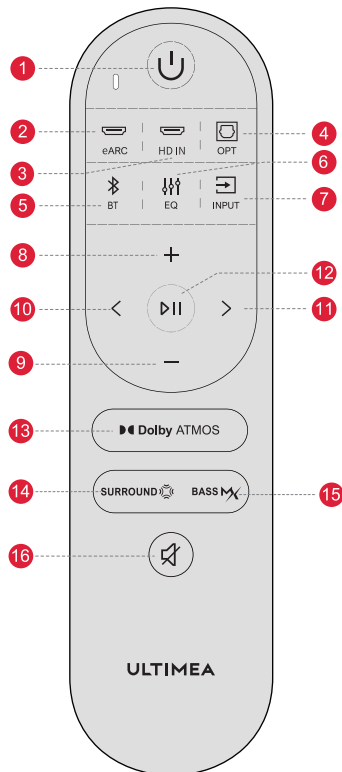

3 サウンドバー設置

組み立て手順

ステップ 1

サウンドバーの2つのパーツを同じ高さにセットし、接続部の位置を合わせます。2つのパーツを平行に押しつけて接続し、1つのパーツとして組み合わせます。

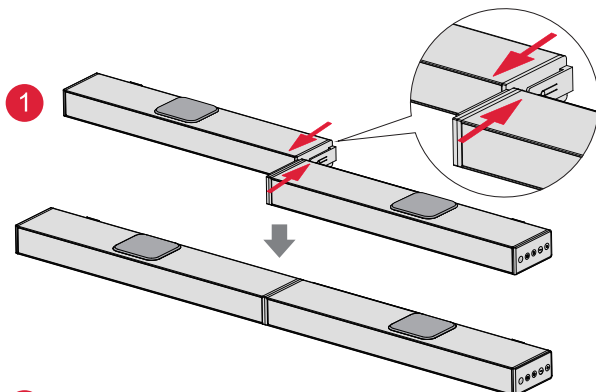

ステップ 2

プラグイン6ピンケーブル

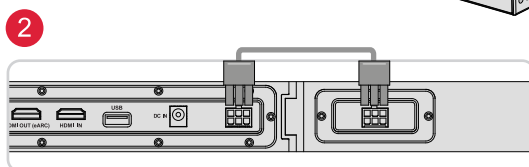

4 HDMI出力でテレビに接続 eARC / ARC

JP

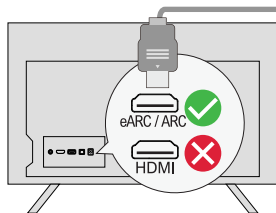

ステップ 1:

HDMIケーブルの一端をテレビ背面のeARC / ARCポートに接続します。

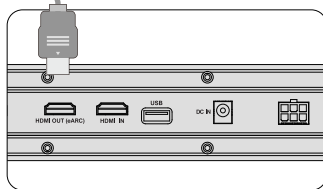

ステップ 2:

もう一方の端をサウンドバーのHDMI (eARC) ポートに接続します。

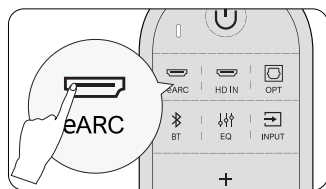

ステップ 3:

リモコンの "eARC" ボタンを押して "HDMI OUT (eARC)" 入力を選択します。

注意:

Dolby Atmos 音声フォーマットをサウンドバーに伝送するには、テレビのHDMIポートがeARCに対応している必要があります。

Atmos: Dolby Atmos フォーマットの映画を視聴する場合は、テレビの音声出力をパススルーに設定してください:

テレビの設定 > ホーム > 設定 > サウンド > デジタル音声出力 > パススルー

DTS: DTS フォーマットの映画を視聴する場合、テレビの音声出力をPCMに設定してください:

テレビの設定 > ホーム > 設定 > サウンド > デジタル音声出力 > PCM

HDMI IN、HDMI ARC、HDMI eARCの違いは何ですか? HDMI IN、HDMI ARC、HDMI eARCの違いは何ですか?

HDMI IN は、テレビやオーディオシステムに機器を接続するための標準的なHDMI入力です。オーディオとビデオ信号に対応していますが、オーディオ・リターン・チャンネル (ARC) やエンハンスト・オーディオ・リターン・チャンネル (eARC) 機能には対応していません。

HDMI ARC は、テレビとオーディオシステム間の双方向通信を可能にする特別なHDMIポートです。つまり、テレビからオーディオ・システムに音声を送り、オーディオ・システムからテレビに音声を送り返すことができます。

HDMI eARC (Enhanced Audio Return Channel) は、Dolby AtmosやDTS:Xなどの高品質オーディオフォーマットをサポートするHDMI ARCのアップデートバージョンです。

注: テレビの「CEC」機能をオンにしてください。

eARC / ARCが接続されている場合、テレビのリモコンでサウンドバーとテレビを同時に操作できます:

- 1 電源オン/オフ
- 2 音量調整

5 HDMI入力で他の機器に接続する

ステップ 1

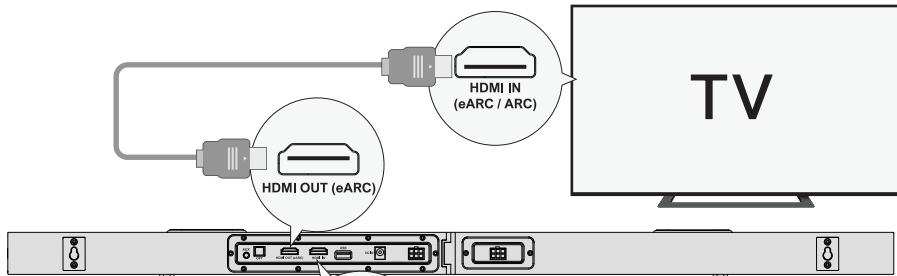

ステップ 2

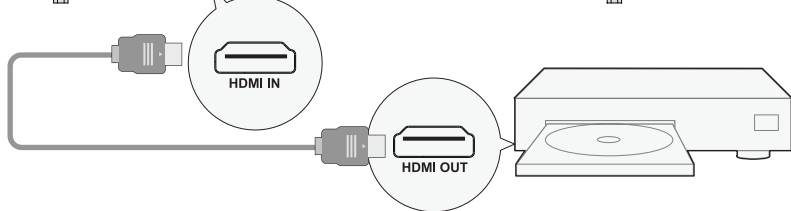

ステップ 3

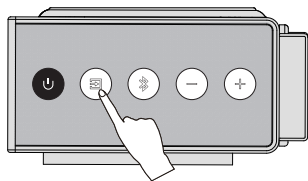

ステップ 1: HDMIケーブルをサウンドバーのHDMI OUT (eARC)ポートに接続し、もう一方をテレビのeARC / ARCポートに接続します。

ステップ 2: HDMIケーブルを他の機器 (DVDやゲーム機など) のHDMI OUTポートに接続し、もう一方をサウンドバーのHDMI INポートに接続します。

ステップ 3: サウンドバーまたはリモコンの "HDMI IN" ボタンを押して、HDMI INチャンネルに切り替えます。

6 オプティカル/AUXでテレビに接続

光学式

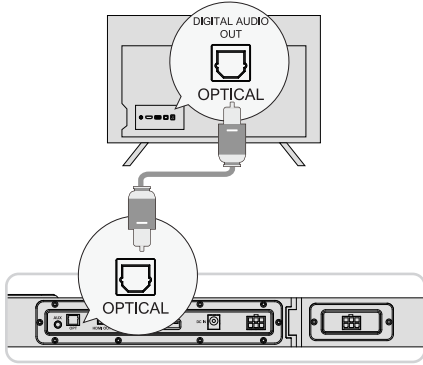

オプション1: 光学式

- 1 テレビのポートがOPTICAL OUTであることを確認し、ケーブルの両側をテレビとサウンドバーの両方でOPTICALに接続します。
 - 2 コードの差し込み口が写真のように正しく差し込まれていることを確認してください。
(間違っただけで差し込むと破損する恐れがあります)
- 注: 接続した後、テレビのスピーカーからも音が再生される場合は、テレビの音量をミュートまたは最小にしてください。

AUX

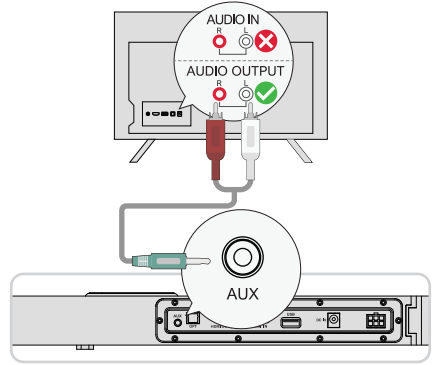

オプション2: AUX

- 1 3.5mmオーディオケーブルをテレビのRCA AUDIO OUTポートに接続します。
 - 2 ケーブルの端の色がテレビのポートの色と同じであることを確認してください。ポートに接続してください。
- 注: 他のモードに切り替える場合は、テレビとサウンドバーからAUXケーブルを抜いてください。

オプティカルモード: 音が出ない場合は、テレビの音声出力をPCMに設定してください:
TV設定>ホーム>設定>サウンド>デジタル音声出力>PCM

7 ブルートゥース接続

- 1 サウンドバーまたはリモコンの "Bluetooth" ボタンを押してBluetoothペアリングモードに入ります。
 - 2 携帯電話のBluetooth設定を開き、"Nova S80" を見つけて選択し、サウンドバーを接続します。
- 注: すでにBluetoothモードで接続されている場合は、"Bluetooth" ボタンを3秒間長押しして、現在のデバイスを切断し、携帯電話/PC/テレビで手動で新しいデバイスに接続します。

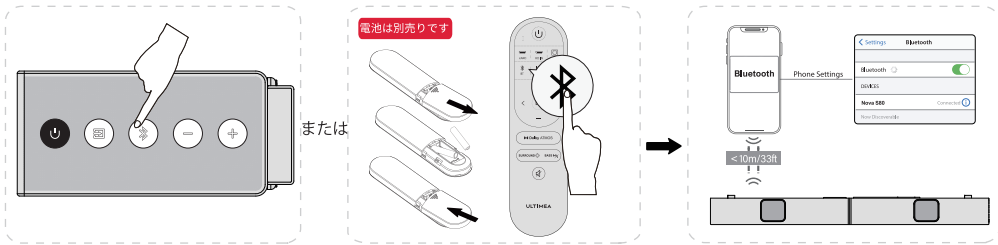

8 サブウーファーとサラウンドスピーカーに接続

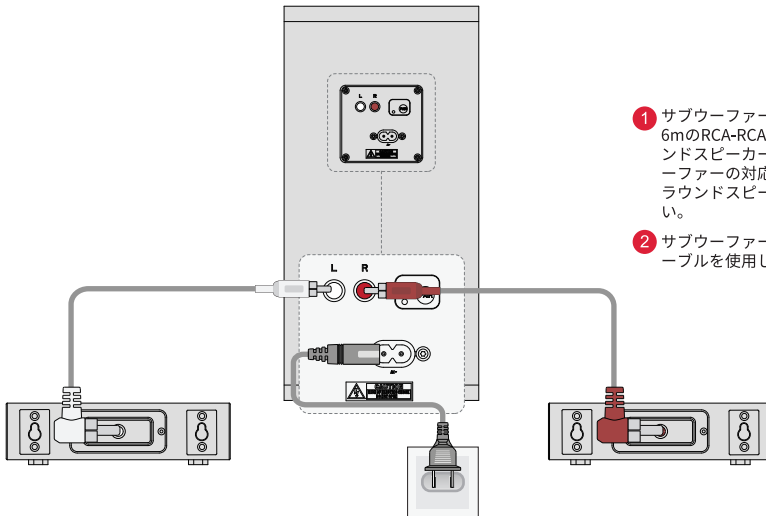

- 1 サブウーファーとサラウンドスピーカーの接続には、6mのRCA-RCAケーブルを使用してください。サラウンドスピーカーの同じ色のインターフェースとサブウーファーの対応するものを一致させ、それに応じてサラウンドスピーカーを配置することに注意してください。
- 2 サブウーファーと電源ポートを接続するには、電源ケーブルを使用します。

9 ペアサブウーファー

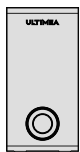

サブウーファーはULTIMEAによってサウンドバーと自動的にペアリングされています。
サブウーファーから音が出ない場合は、サウンドバーとサブウーファーを再度ペアリングする必要があります。



ステップ1

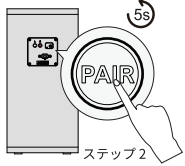

ステップ2

ステップ1
リモコンの"BASS Mx"ボタンを5秒間長押しすると、ディスプレイに"50%"が点滅表示されます。

ステップ2
サブウーファーのPAIRボタンを5秒間長押しすると、白色LEDが高速点滅します。
サブウーファーとのペアリングに成功すると、白色LEDが常時点灯します。

10 配置オプション

360°フルサラウンド (より良いサラウンド)

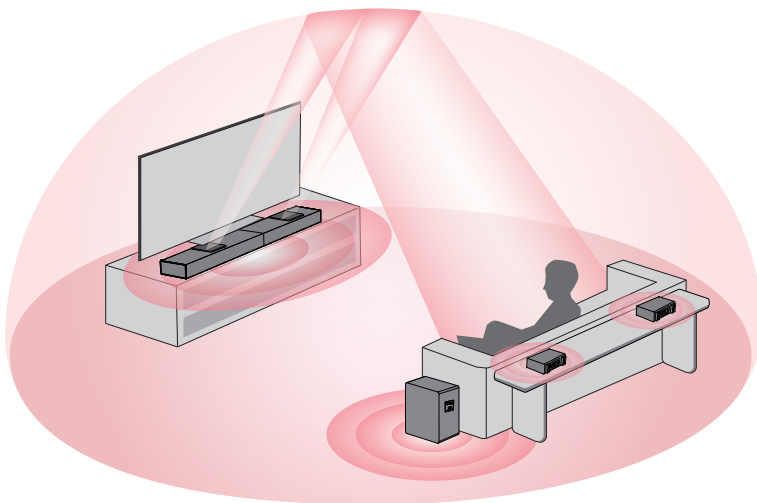

フロント・サラウンド

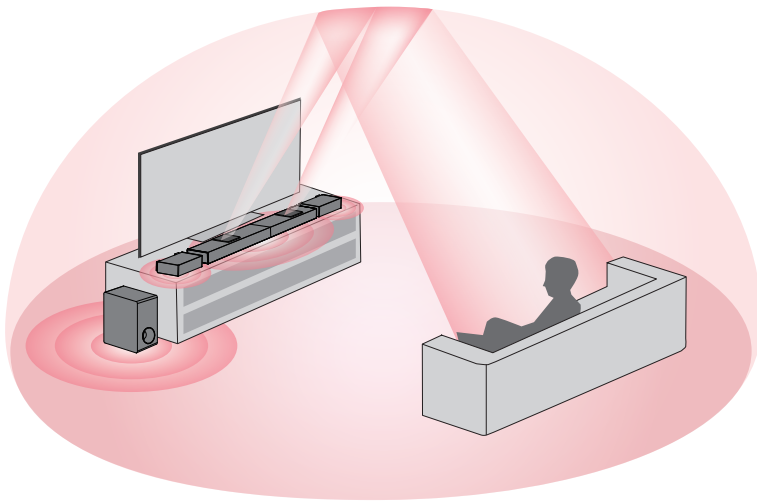

- 1 より良いリスニング体験のために、ご自宅の環境に合わせて、上図の2つの配置オプションのいずれかをお選びください。
- 2 サウンドバーは耳の高さかその近くに設置する。

11 壁掛け設置

JP

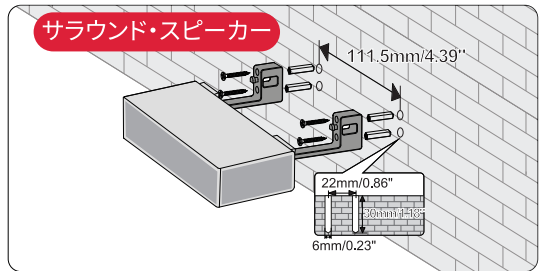
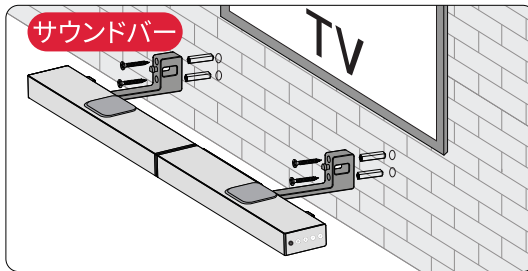
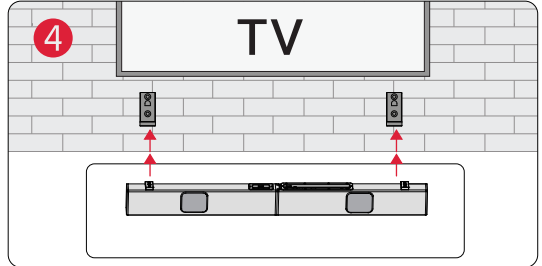
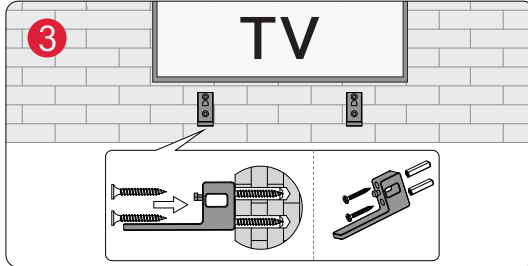
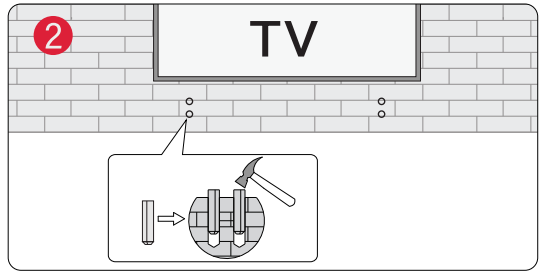
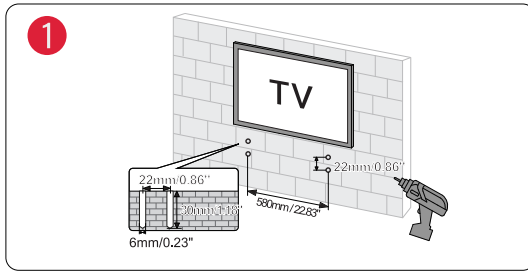

 注意事項: HDMIケーブルの抜き差しを簡単にするために、HDMIアダプターをご使用ください。

12 仕様

モデル番号	U4120
電源	AC 100-240V, ~50/60Hz
サウンドバードライバー	(3.1インチ×12インチ) ×3 (サウンドバー) +18インチ×2 (上向きドライバー) + (3.1インチ×12インチ) ×2 (サラウンドベースピーカー) +8インチ (サブウーファー)
周波数特性	35Hz - 18kHz
スタンバイ電力	<0.5W
動作温度	0°C - 45°C / 32°F - 113°F
ブルートゥース・バージョン	5.3

サウンドバー	800(W) x 38(H) x 90(D)mm	31.5" x 1.5" x 3.5"
サブウーファー	315(W) x 385(H) x 190(D)mm	12.4" x 15.2" x 7.5"
サラウンドスピーカー	150(W) x 38(H) x 82(D)mm	5.9" x 1.5" x 3.2"
パッケージ	472(W) x 306(H) x 430(D)mm	15.6" x 12" x 16.9"
正味重量	6.67kg / 14.77lbs	
総重量	8.9kg / 19.71lbs	

ULTIMEA

Nova S80

Manuel de l'utilisateur



Numéro de modèle : U4120

NOUS SOMMES PRÊTS À VOUS AIDER



support@ultimea.com

FR

Vous préférez un tutoriel vidéo ?

Vidéo d'aide à l'installation, ou MANUEL D'UTILISATION sur le site web d'ULTIMEA.

@ultimea_official



support,ultimea.com

+1 888-598-8875 (US) Mon-Fri 9am-5pm (PST)
+49 89-628-25828 (EU) Mon-Fri 9am-5pm (CET)

1 LISTE D'ACCESSOIRES

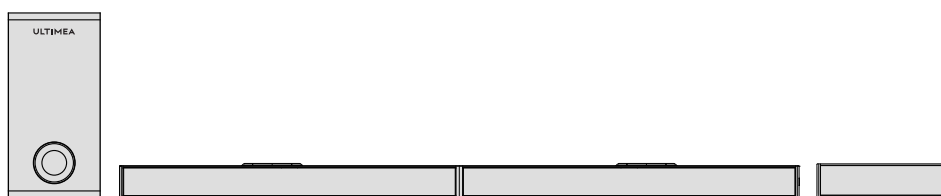

Barre de son

Caisson de basse

Enceinte surround x 2



Adaptateur d'alimentation

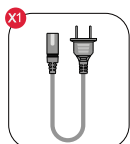

Câble d'alimentation du caisson de basse

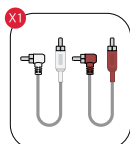

Câble audio stéréo RCA vers RCA (6m)

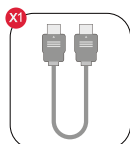

Câble HDMI

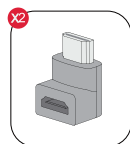

Adaptateur HDMI

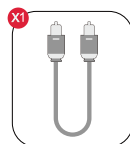

Câble Optique Numérique

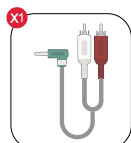

Câble audio stéréo 3.5 mm vers RCA

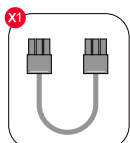

Câble 6 broches pour connexion au soundbar (140 mm)



Télécommande

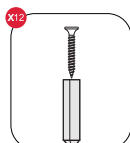

Kit de montage mural

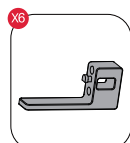

Support mural



Manuel de l'utilisateur

2 COMMANDES DE LA BARRE DE SON

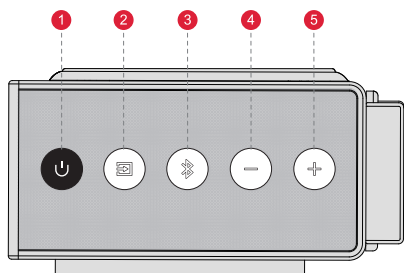

Panneau de contrôle

- 1 "⏻": Bouton d'alimentation**
Appuyez pour allumer/éteindre.
- 2 "📺": Mode d'entrée**
Appuyez sur cette touche pour changer de canal : eARC-HD IN (HDMI IN) -OPT (OPTICAL)-BT-AUX-USB.
- 3 "📶": BT**
Appuyez sur cette touche pour passer au canal BT et entrer en mode d'appariement. Maintenez-la enfoncée pendant 3 secondes pour déconnecter l'appareil actuel et vous connecter manuellement à un nouvel appareil sur votre téléphone portable / PC / TV. (BT ID: Nova S80).
- 4 "⏪": Diminution du volume**
- 5 "⏩": Augmentation du volume**

Télécommande

- 1 "⏻" : **Bouton d'alimentation**
Appuyez pour allumer/éteindre.
- 2 "eARC" : **eARC**
Appuyez sur cette touche pour passer au canal HDMI eARC.
- 3 "HD IN" : **HD IN**
Appuyez sur cette touche pour passer au canal HDMI IN.
- 4 "OPT" : **OPT**
Appuyez sur cette touche pour passer au canal OPTICAL.
- 5 "BT" : **BT**
Appuyez sur cette touche pour passer au canal Bluetooth et entrer en mode d'appairage. Maintenez cette touche enfoncée pendant 3 secondes pour déconnecter l'appareil actuel et vous connecter manuellement à un nouvel appareil sur votre téléphone portable / PC / TV (BT ID: Nova S80).
- 6 "EQ" : **EQ**
Appuyez sur cette touche pour basculer entre les modes Film, Dialogue et Musique : "MOVIE", "DIALOG", "MUSIC".
- 7 "INPUT" : **INPUT**
Appuyez sur cette touche pour changer de canal : eARC-HD IN (HDMI IN) -OPT (OPTICAL)-BT-AUX-USB.
- 8 "+": **Augmentation du volume**
- 9 "-": **Diminution du volume**
- 10 "<": **Précédent**
Pour les modes BT et USB uniquement : Passer à la piste précédente.
- 11 ">": **Suivant**
Pour les modes BT et USB uniquement : Passer à la piste suivante.
- 12 "⏸": **Lecture / Pause**
Pour les modes BT et USB uniquement.
Mode USB : Maintenez cette touche enfoncée pendant 3 secondes pour basculer entre la lecture d'une boucle unique et la lecture d'une boucle de liste.
- 13 "Dolby ATMOS" : **Dolby Atmos**
Appuyez sur cette touche pour régler le niveau sonore des pilotes supérieurs, l'écran affiche : "AT-1", "AT 0", "AT 1".
- 14 "SURROUND" : **Surround**
Appuyez sur cette touche pour régler le niveau du son surround, l'écran affichera : "SR-2", "SR-1", "SR 0", "SR 1".
- 15 "BASSMAX" : **BASSMAX**
Appuyez sur cette touche pour régler le niveau des basses : "BS-4", "BS-3", "BS-2", "BS-1", "BS 0", "BS 1", "BS 2", "BS 3", "BS 4".
- 16 "Mute" : **Mute / Récupérer le volume.**

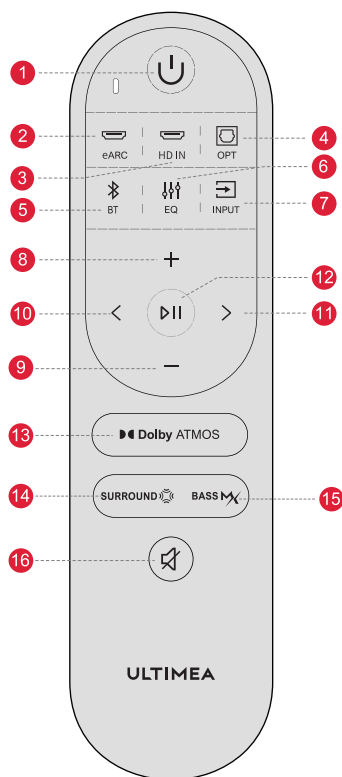

3 INSTALLATION DU SOUNDBAR

Étapes d'assemblage

Étape 1

Placez les deux parties du soundbar au même niveau et alignez les joints de connexion. Connectez les deux parties en les poussant parallèlement pour les assembler en une seule pièce.

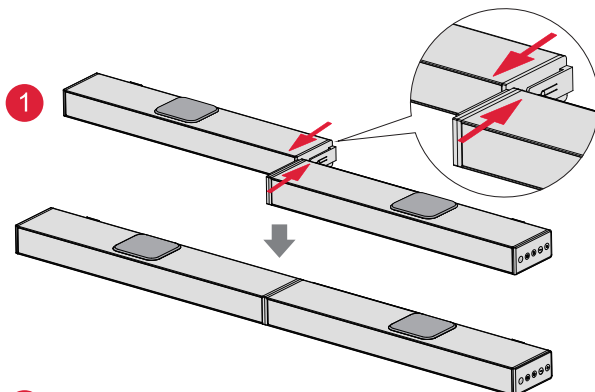

Étape 2

Brancher le câble à 6 broches.

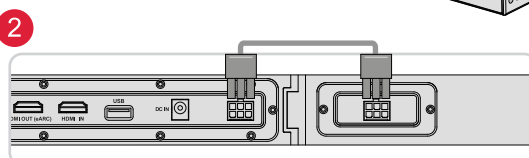

4 CONNECTER AU TÉLÉVISEUR VIA HDMI OUT eARC / ARC

FR

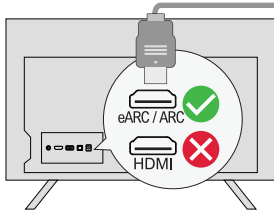

Étape 1:

Branchez une extrémité du câble HDMI sur le port eARC / ARC à l'arrière de votre téléviseur.

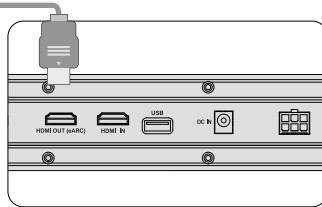

Étape 2:

Ensuite, connectez l'autre extrémité au port HDMI (eARC) du soundbar.

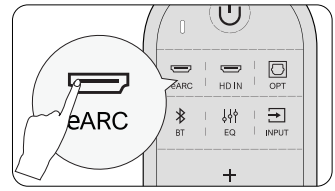

Étape 3:

Appuyez sur le bouton eARC de la télécommande pour sélectionner l'entrée HDMI OUT (eARC).

Note:

Le port HDMI de votre téléviseur doit prendre en charge la fonction eARC pour transmettre le format audio Dolby Atmos à votre soundbar.

Atmos: Si vous regardez un film au format Dolby Atmos, veuillez régler la sortie audio de votre téléviseur sur Pass Through :

Paramètres TV > Accueil > Paramètres > Son > Sortie audio numérique > Pass Through

DTS: Si vous regardez un film au format DTS, veuillez régler la sortie audio de votre téléviseur sur PCM :

Paramètres TV > Accueil > Paramètres > Son > Sortie audio numérique > PCM

Quelle est la différence entre HDMI IN, HDMI ARC et HDMI eARC ?

HDMI IN est une entrée HDMI standard qui vous permet de connecter des appareils à votre téléviseur ou à votre système audio. Il prend en charge les signaux audio et vidéo, mais ne prend pas en charge la fonctionnalité de canal de retour audio (ARC) ou de canal de retour audio amélioré (eARC).

HDMI ARC est un port HDMI spécial qui prend en charge la communication bidirectionnelle entre votre téléviseur et votre système audio. Cela signifie que l'audio peut être envoyé de votre téléviseur à votre système audio, et le système audio peut renvoyer l'audio à votre téléviseur.

HDMI eARC (Enhanced Audio Return Channel) est une version améliorée de HDMI ARC qui prend en charge des formats audio de meilleure qualité tels que Dolby Atmos et DTS:X.

Note : Veuillez activer la fonction "CEC" sur votre téléviseur.

Lorsque l'eARC / l'ARC est connecté, la télécommande de votre téléviseur peut contrôler simultanément le soundbar et le téléviseur :

- 1 Allumer / éteindre
- 2 Régler le volume

5 CONNECTER À UN AUTRE APPAREIL VIA HDMI IN

Étape 1

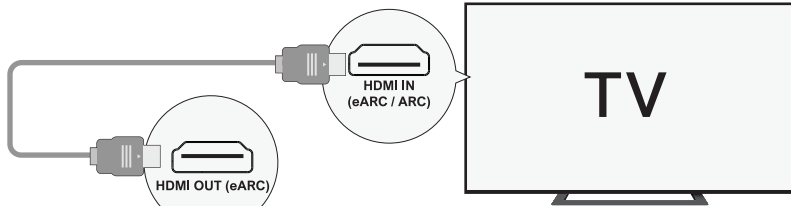

Étape 2

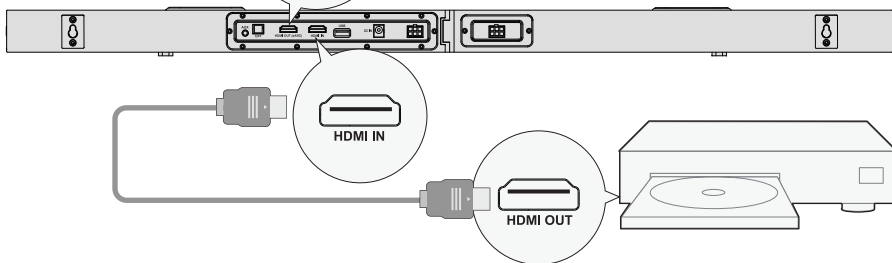

Étape 3

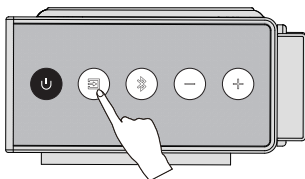

Étape 1: Connectez le câble HDMI au port HDMI OUT (eARC) du Soundbar et l'autre extrémité au port eARC / ARC du téléviseur.

Étape 2: Connectez le câble HDMI au port HDMI OUT de l'autre appareil (comme un lecteur DVD ou une console de jeu) et l'autre extrémité au port HDMI IN du Soundbar.

Étape 3: Appuyez sur la touche " " de la barre de son ou de la télécommande pour passer au canal HDMI IN.

6 CONNECTER AU TÉLÉVISEUR VIA OPTIQUE / AUX

FR

OPTIQUE

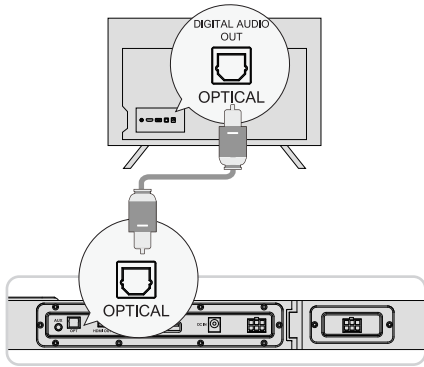

OPTION 1 : OPTIQUE

- 1 Assurez-vous que le câble est connecté au port OPTICAL OUT de votre téléviseur et l'autre extrémité au port OPTICAL de la barre de son.
- 2 Assurez-vous que la prise optique est insérée correctement, comme indiqué sur l'image. N'insérez pas la fiche à l'envers et ne cassez pas le câble optique.

Remarque : Si le son est diffusé par les haut-parleurs internes du téléviseur, coupez ou réduisez le volume du téléviseur.

AUX

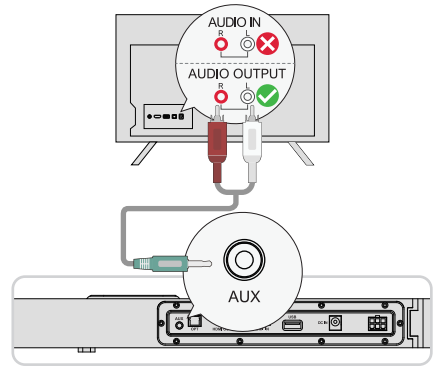

OPTION 2 : AUX

- 1 Connectez le câble audio 3.5 mm vers RCA au port RCA AUDIO OUT de votre téléviseur.
- 2 Assurez-vous que la couleur des extrémités du câble correspond à la couleur des ports du téléviseur.

Remarque : N'oubliez pas de débrancher le câble AUX de la télévision et de la barre de son lorsque vous souhaitez changer de mode.

En mode optique : S'il n'y a pas de son, essayez de régler la sortie audio du téléviseur sur PCM :
Réglages TV > Accueil > Réglages > Son > Sortie audio numérique > PCM

7 CONNECTER À BLUETOOTH

- 1 Appuyez sur le bouton "Bluetooth" de la barre de son ou de la télécommande pour entrer en mode d'appairage Bluetooth.
- 2 Ouvrez les paramètres Bluetooth de votre téléphone, recherchez et sélectionnez "Nova S80" pour connecter la barre de son.

Remarque : Si l'appareil est déjà en mode Bluetooth et connecté, appuyez sur le bouton "Bluetooth" et maintenez-le enfoncé pendant 3 secondes pour déconnecter l'appareil actuel et vous connecter manuellement à un nouvel appareil sur votre téléphone portable / PC / TV.

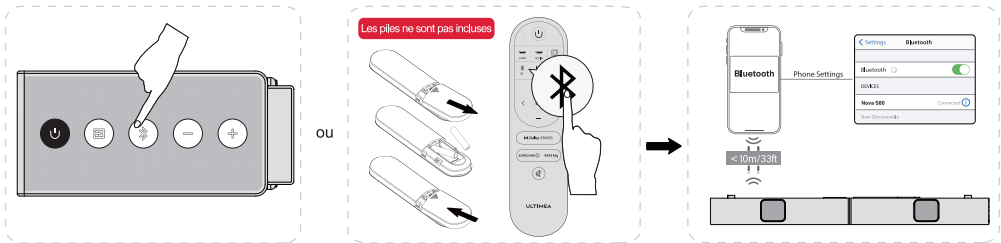

8 CONNECTER AU CAISSON DE BASSE ET AUX ENCEINTES SURROUND

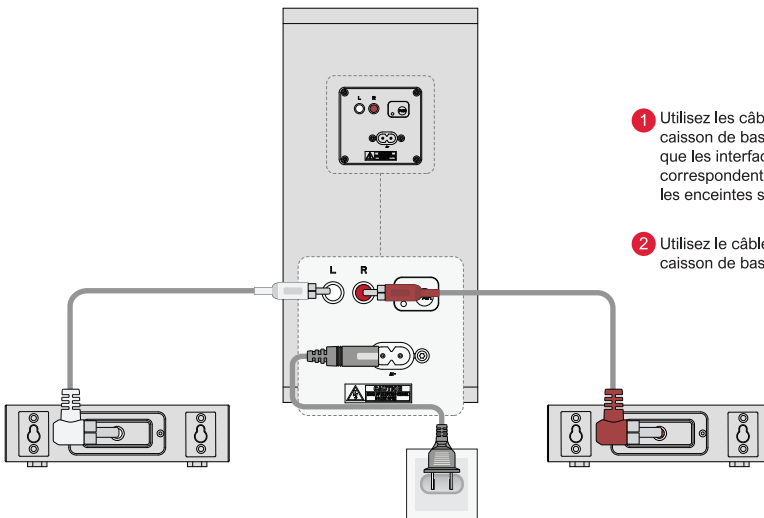

- 1 Utilisez les câbles RCA-RCA de 6 m pour connecter le caisson de basse et les enceintes surround. Veillez à ce que les interfaces de couleur des enceintes surround correspondent à celles du caisson de basse et placez les enceintes surround en conséquence.
- 2 Utilisez le câble d'alimentation pour connecter votre caisson de basse et le port d'alimentation.

9 APPAIRAGE DU CAISSON DE BASSE

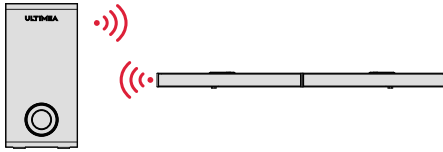

Le caisson de basse a été associé automatiquement à la barre de son par ULTIMEA.
Si aucun son ne provient du caisson de basse, vous devez appairer à nouveau la barre de son avec le caisson de basse.



Étape 1

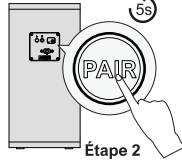

Étape 2

Étape 1

Appuyez sur le bouton "BASS Mx" de la télécommande et maintenez-le enfoncé pendant 5 secondes, l'écran affiche "SUB" en clignotant.

Étape 2

Appuyez sur le bouton PAIR du caisson de basses et maintenez-le enfoncé pendant 5 secondes, la LED blanche clignote rapidement. La LED blanche s'allume en permanence lorsque le caisson de basse est apparié avec succès.

10 OPTIONS DE PLACEMENT

Surround complet à 360° (Meilleur Surround)

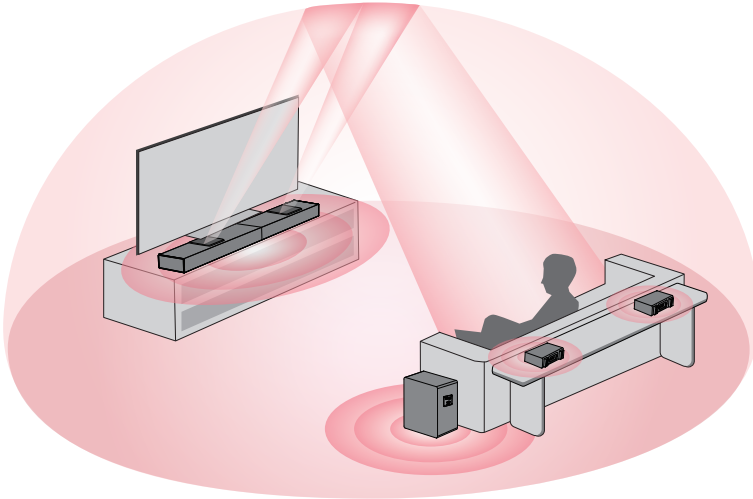

Front Surround

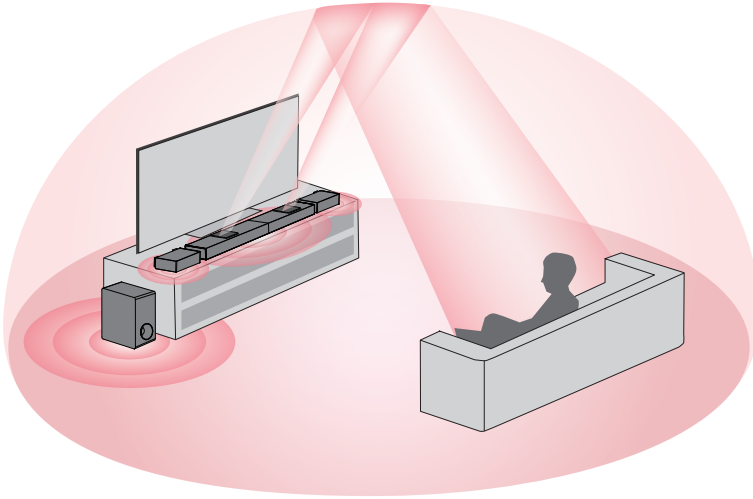

- 1 Pour une expérience d'écoute optimale, veuillez choisir l'une des deux options de placement illustrées ci-dessus en fonction de votre environnement domestique.
- 2 Le soundbar doit être placé au niveau de l'oreille ou à proximité de celle-ci.

11 INSTALLATION DU SUPPORT MURAL

FR

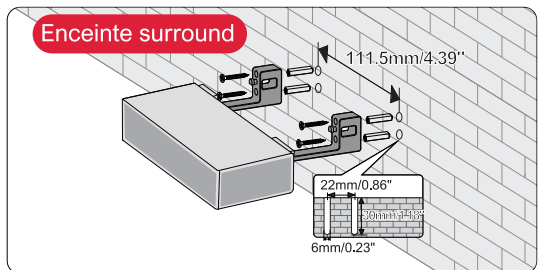
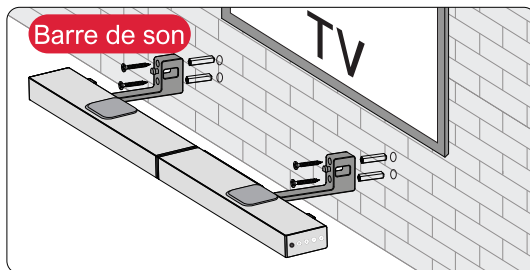
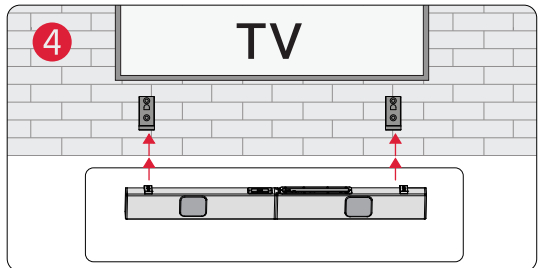
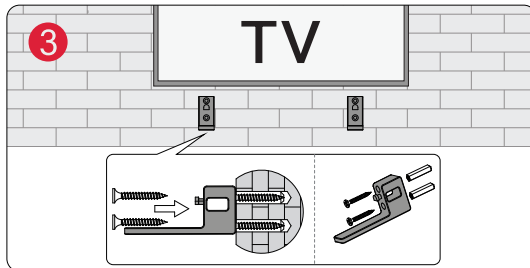
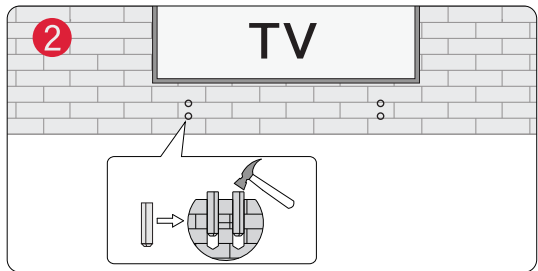
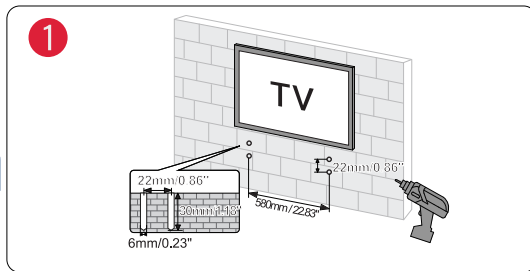

Remarque : Veuillez utiliser l'adaptateur HDMI pour faciliter le branchement et le débranchement du câble HDMI.

12 SPÉCIFICATIONS

Numéro de modèle	U4120
Alimentation	AC 100-240V, ~50/60Hz
Haut-parleurs de la barre de son	(3.1" x 1.2") x 3(barre de son) + 1.8" x 2(haut-parleurs orientés vers le haut) + (3.1" x 1.2") x 2(haut-parleur surround) + 8"(caisson de basse)
Réponse en fréquence	35Hz - 18kHz
Puissance en veille	<0.5W
Température de fonctionnement	0°C - 45°C / 32°F - 113°F
Vision Bluetooth	5.3

Dimensions et poids		
Barre de son	800(W) x 38(H) x 90(D)mm	31.5" x 1.5" x 3.5"
Caisson de basse	315(W) x 385(H) x 190(D)mm	12.4" x 15.2" x 7.5"
Enceinte surround	150(W) x 38(H) x 82(D)mm	5.9" x 1.5" x 3.2"
Emballage	472(W) x 306(H) x 430(D)mm	15.6" x 12" x 16.9"
Poids net	6.7kg / 14.77lbs	
Poids brut	8.94kg / 19.71lbs	

ULTIMEA

Nova S80

Manuale d'uso



Modello n.: U4120

SIAMO PRONTI AD AIUTARE



support@ultimea.com

IT

Preferite un video tutorial?

Video guida all'installazione o MANUALE D'USO sul sito web di ULTIMEA.



@ultimea_official



support.ultimea.com

+1 888-598-8875 (US) Mon-Fri 9am-5pm (PST)
+49 89-628-25828 (EU) Mon-Fri 9am-5pm (CET)

1 ELENCO DEGLI ACCESSORI

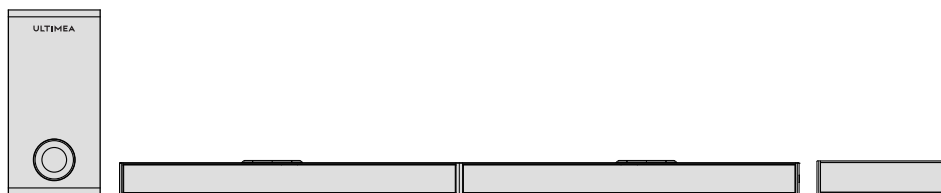

Barra audio

Subwoofer

Altoparlante surround x 2



Adattatore di alimentazione

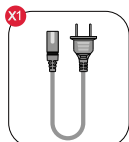

Cavo di alimentazione del subwoofer

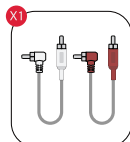

Cavo audio stereo da RCA a RCA (6 m)

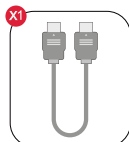

Cavo HDMI

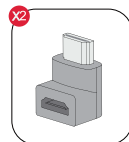

Adattatore HDMI

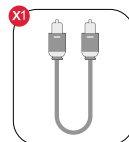

Cavo ottico digitale

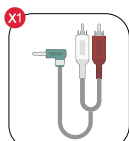

Cavo audio stereo da 3,5 mm a RCA

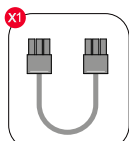

Cavo a 6 pin per il collegamento della Soundbar (140 mm)



Telecomando

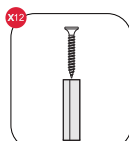

Kit di montaggio a parete

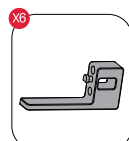

Staffa a parete



Manuale d'uso

2 CONTROLLI DELLA SOUNDBAR

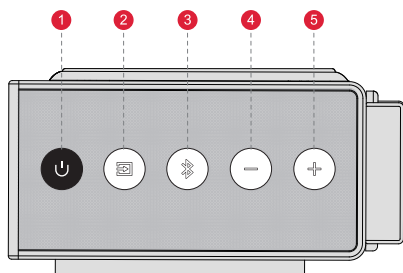

Pannello di controllo

- 1 "⏻": **Pulsante di accensione**
Premere per accendere/spingere il dispositivo.
- 2 "📺": **Modalità di ingresso**
Premere per cambiare canale: eARC-HD IN (HDMI IN) - OPT (OPTICAL)-BT-AUX-USB.
- 3 "📶": **BT**
Premere per passare al canale BT / Tenere premuto per 3 secondi per scollegare il dispositivo corrente e collegarsi a un nuovo dispositivo. (BT ID: Nova S80).
- 4 "⏮": **Volume giù**
- 5 "⏭": **Volume su**

Telecomando

- 1 **“⏻” : Tasto di accensione**
Premere per accendere/spgnere il dispositivo.
- 2 **“eARC” : eARC**
Premere per passare al canale HDMI eARC.
- 3 **“HD IN” : HD IN**
Premere per passare al canale HDMI IN.
- 4 **“OPT” : OPT**
Premere per passare al canale OTTICO.
- 5 **“BT” : BT**
Premere per passare al canale BT / Tenere premuto per 3 secondi per scollegare il dispositivo corrente e collegarsi a un nuovo dispositivo. (BT ID: Nova S80).
- 6 **“EQ” : EQ**
Premere per passare dalla modalità Film, Dialogo, Musica, il display mostrerà : “*MOVIE*”, “*JL06*”, “*MUSIC*”.
- 7 **“INPUT” : INPUT**
Premere per cambiare canale: eARC-HD IN (HDMI IN) -OPT (OPTICAL)-BT-AUX-USB.
- 8 **“+” : Volume su**
- 9 **“-” : Volume giù**
- 10 **“<” : Precedente**
Modalità BT e USB: Passa al brano precedente.
- 11 **“>” : Successivo**
Modalità BT e USB: Passa alla traccia successiva.
- 12 **“▶||” : Riproduzione / Pausa**
Solo per le modalità BT e USB.
Modalità USB: Tenere premuto per 3 secondi per passare dalla riproduzione di un singolo loop alla riproduzione di un elenco di loop.
- 13 **“Dolby ATMOS” : Dolby Atmos**
Premere per regolare il livello sonoro degli altoparlanti superiori; il display visualizza : “*AT-1*”, “*AT 0*”, “*AT 1*”.
- 14 **“SURROUND” : Surround**
Premere per regolare il livello del suono surround, il display visualizzerà : “*SR-2*”, “*SR-1*”, “*SR 0*”, “*SR 1*”.
- 15 **“BASSMAX” : BASSMAX**
Premere per regolare il livello dei bassi; il display visualizza : “*B5-4*”, “*B5-3*”, “*B5-2*”, “*B5-1*”, “*B5 0*”, “*B5 1*”, “*B5 2*”, “*B5 3*”, “*B5 4*”.
- 16 **“Mute” : Mute / Recuperare il volume.**

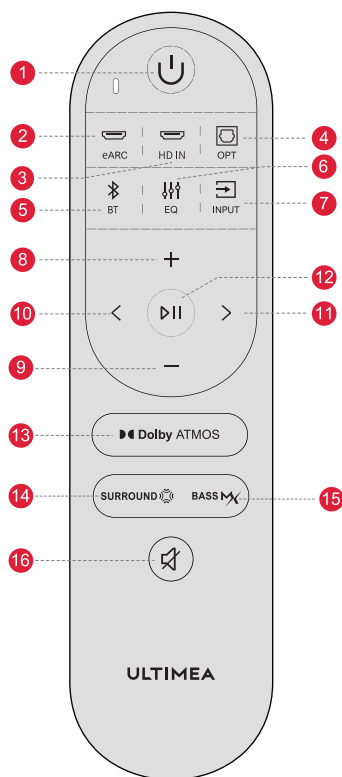

3 INSTALLAZIONE DELLA SOUNDBAR

Fasi di montaggio

Passo 1

Posizionare le due parti della Soundbar sullo stesso livello e allineare i giunti di collegamento. Collegare le due parti spingendole parallelamente per unirle in un unico pezzo.

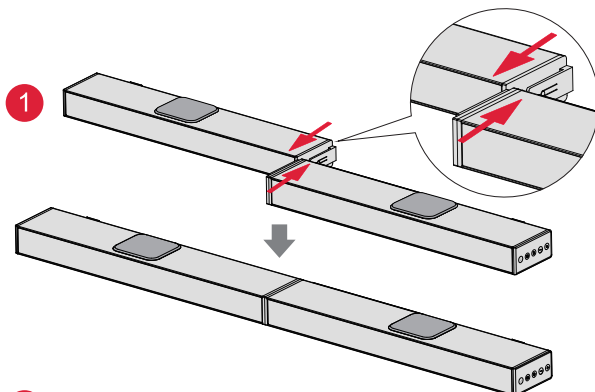

Passo 2

Inserire il cavo a 6 pin.

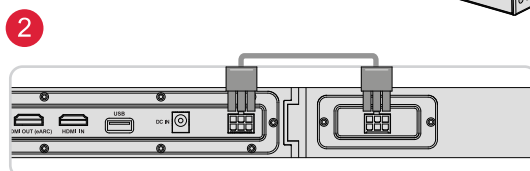

4 COLLEGAMENTO AL TV TRAMITE USCITA HDMI eARC / ARC

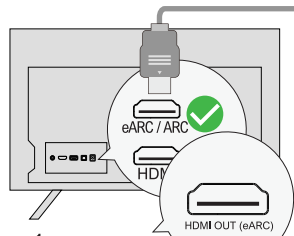

Passo 1:
Collegare un'estremità del cavo HDMI alla porta eARC / ARC sul retro del televisore.

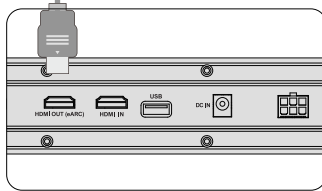

Passo 2:
Collegare quindi l'altra estremità alla porta HDMI (eARC) della soundbar.

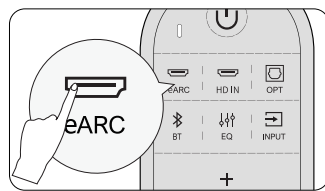

Passo 3:
Premere il tasto "eARC" del telecomando per selezionare l'ingresso "HDMI OUT (eARC)".

Nota:

La porta HDMI del televisore deve supportare eARC per trasmettere il formato audio Dolby Atmos alla Soundbar.

Atmos: se si guarda un film in formato Dolby Atmos, impostare l'uscita audio del televisore su Pass Through:

Impostazioni TV > Home > Impostazioni > Suono > Uscita audio digitale > Passa attraverso

DTS: Se si sta guardando un film in formato DTS, impostare l'uscita audio sul televisore su PCM:

Impostazioni TV > Home > Impostazioni > Audio > Uscita audio digitale > PCM

Qual è la differenza tra: HDMI IN, HDMI ARC, HDMI eARC?

HDMI IN è un ingresso HDMI standard che consente di collegare i dispositivi al televisore o al sistema audio. Supporta segnali audio e video, ma non supporta la funzionalità ARC (Audio Return Channel) o eARC (Enhanced Audio Return Channel).

HDMI ARC è una porta HDMI speciale che consente la comunicazione bidirezionale tra il televisore e il sistema audio. Ciò significa che l'audio può essere inviato dal televisore al sistema audio e il sistema audio può inviare l'audio al televisore.

HDMI eARC (Enhanced Audio Return Channel) è una versione aggiornata dell'HDMI ARC che supporta formati audio di qualità superiore come Dolby Atmos e DTS:X.

Nota: attivare la funzione "CEC" sul televisore.

Quando è collegato eARC / ARC, il telecomando del televisore può controllare contemporaneamente la soundbar e il televisore : ① Accendere / Spegnere ② Regolare il volume

5 COLLEGAMENTO AD ALTRI DISPOSITIVI TRAMITE INGRESSO HDMI

Fase 1

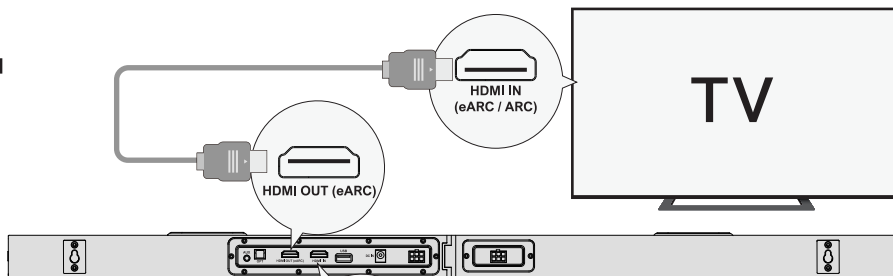

Fase 2

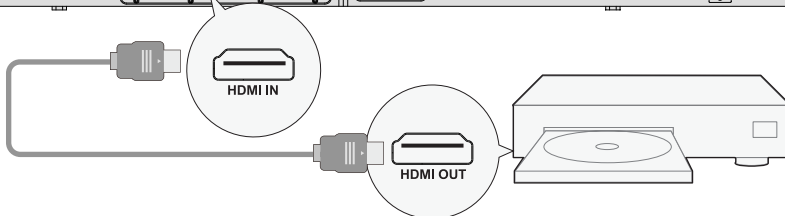

Fase 3

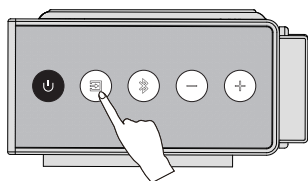

Fase 1: Collegare il cavo HDMI alla porta HDMI OUT (eARC) della Soundbar e l'altra estremità alla porta eARC / ARC del televisore.

Fase 2: Collegare il cavo HDMI alla porta HDMI OUT dell'altro dispositivo (ad esempio un DVD o una console per videogiochi) e l'altra estremità alla porta HDMI IN della Soundbar.

Fase 3: Premere il pulsante "HDMI IN" sulla Soundbar o sul telecomando per passare al canale HDMI IN.

6 COLLEGAMENTO ALLA TV VIA OTTICO/AUX

IT

OTTICO

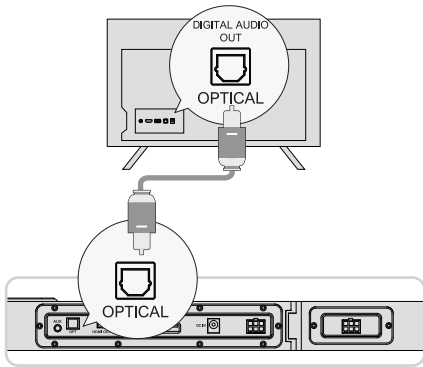

OPZIONE 1: OTTICO

- 1 Assicurarsi che il cavo sia collegato alla porta OPTICAL OUT del televisore e l'altra estremità alla porta OPTICAL del sistema Soundbar.
- 2 Assicurarsi che la spina ottica sia inserita correttamente come mostrato nell'immagine. Non inserire la spina al contrario e non rompere l'ottica.

Nota: Se l'audio viene riprodotto dagli altoparlanti interni del televisore, disattivare o ridurre al minimo il volume del televisore.

AUX

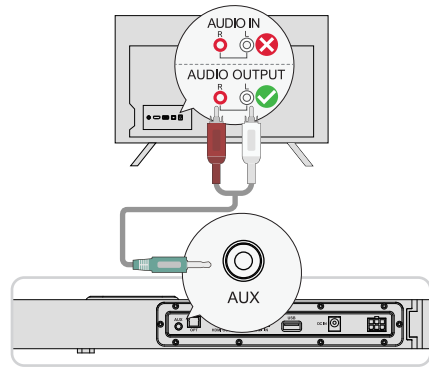

OPZIONE 2: AUX

- 1 Collegare il cavo audio da 3.5 mm a RCA alla porta RCA AUDIO OUT del televisore.
- 2 Assicurarsi che il colore delle estremità dei cavi corrisponda a quello delle porte del televisore.

Nota: Ricordarsi di scollegare il cavo AUX dal televisore e dalla Soundbar quando si desidera cambiare modalità.

In modalità ottica: Se non si sente alcun suono, provare a impostare l'uscita audio del televisore su PCM:
Impostazioni TV > Home > Impostazioni > Audio > Uscita audio digitale > PCM

7 CONNETTERSI AL BLUETOOTH

- 1 Premere il pulsante "Bluetooth" sulla soundbar o sul telecomando per accedere alla modalità di accoppiamento Bluetooth.
- 2 Aprire le impostazioni Bluetooth del telefono, trovare e selezionare "Nova S80" per collegare la soundbar.

Nota: se è già in modalità Bluetooth e collegato, tenere premuto il pulsante "Bluetooth" per 3 secondi per scollegare il dispositivo corrente e collegarsi manualmente a un nuovo dispositivo sul telefono cellulare / PC / TV.

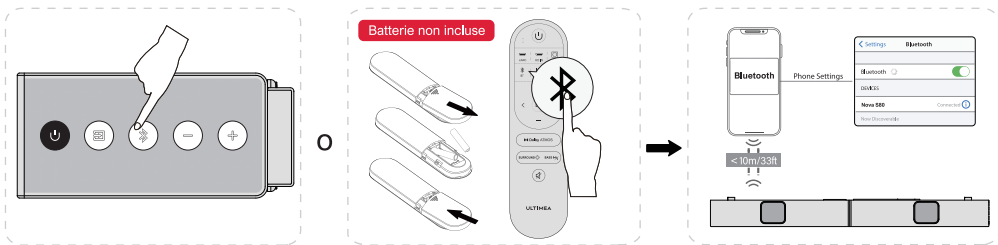

8 COLLEGAMENTO AL SUBWOOFER E AI DIFFUSORI SURROUND

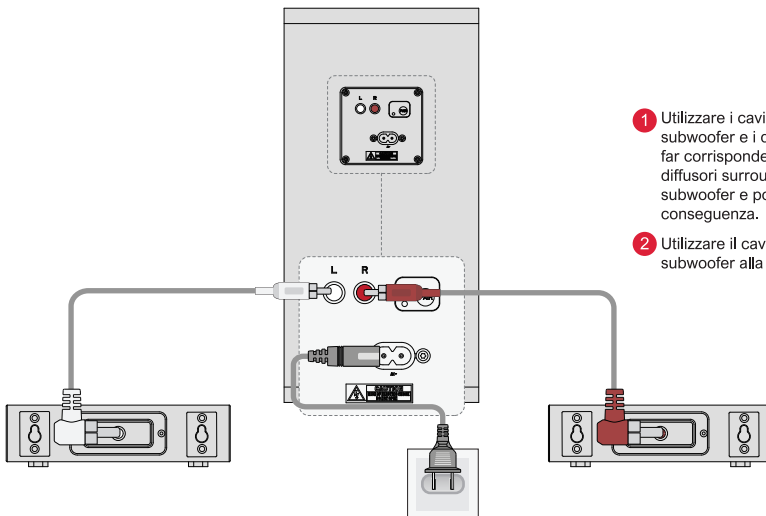

- 1 Utilizzare i cavi RCA-RCA da 6 m per collegare il subwoofer e i diffusori surround; prestare attenzione a far corrispondere le interfacce dello stesso colore dei diffusori surround con quelle corrispondenti del subwoofer e posizionare i diffusori surround di conseguenza.
- 2 Utilizzare il cavo di alimentazione per collegare il subwoofer alla porta di alimentazione.

9 ACCOPPIAMENTO DEL SUBWOOFER

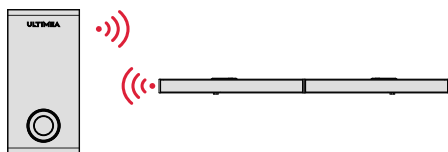

Il subwoofer è stato abbinato automaticamente alla soundbar da ULTIMEA.
Se il suono non proviene dal subwoofer, è necessario accoppiare nuovamente la Soundbar con il subwoofer.



Posso 1

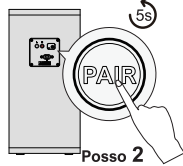

Posso 2

Passo 1

Tenere premuto il tasto "BASS+X" del telecomando per 5 secondi; il display visualizzerà "SUB" lampeggiante.

Passo 2

Tenere premuto il pulsante PAIR sul subwoofer per 5 secondi, il LED bianco lampeggerà velocemente.

Il LED bianco sarà sempre acceso quando il subwoofer è stato accoppiato correttamente.

IT

10 OPZIONI DI POSIZIONAMENTO

Surround completo a 360° (Surround migliore)

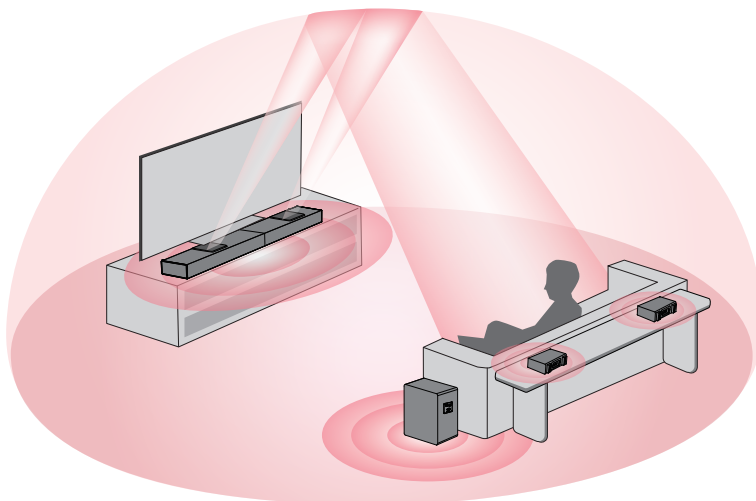

Surround anteriore

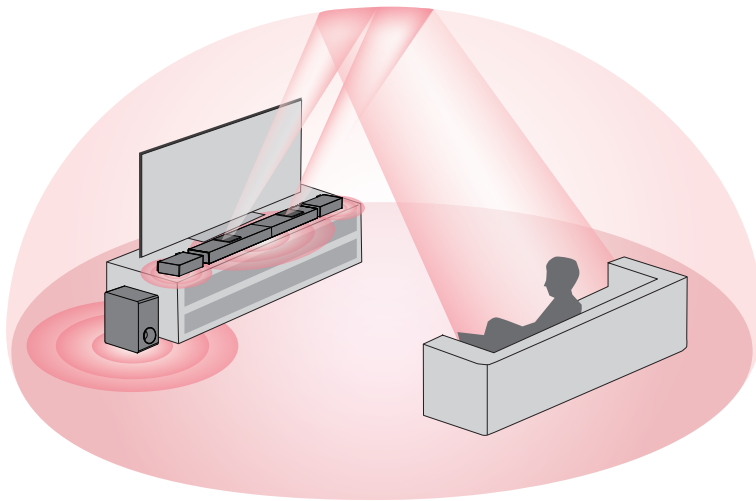

- 1 Per una migliore esperienza d'ascolto, scegliere una delle due opzioni di posizionamento mostrate nell'illustrazione precedente in base all'ambiente domestico.
- 2 La soundbar deve essere posizionata all'altezza delle orecchie o quasi.

11 INSTALLAZIONE A PARETE

IT

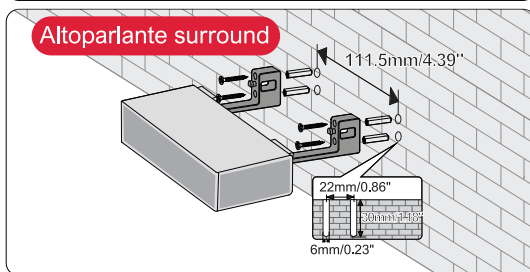
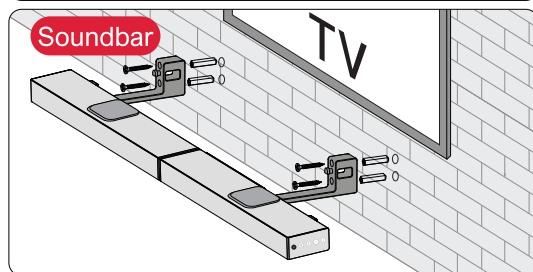
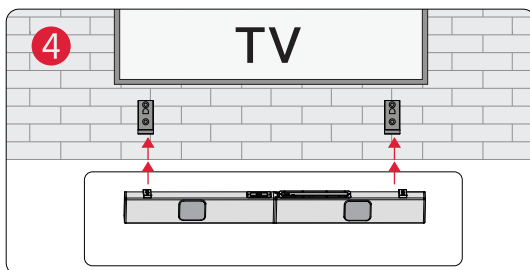
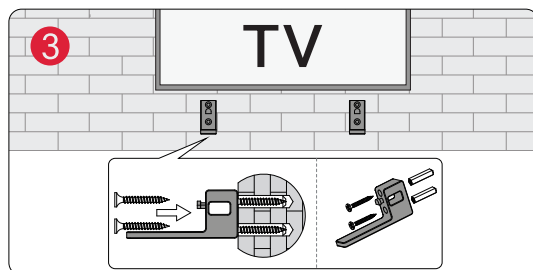
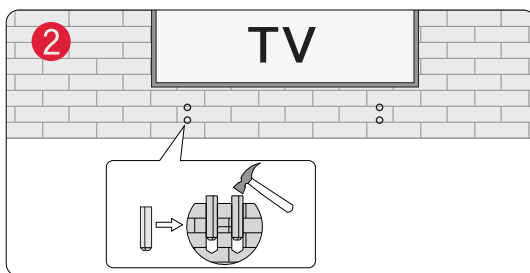
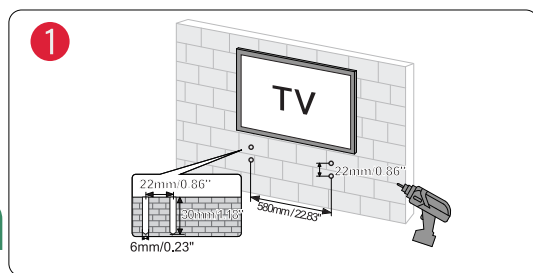

 **Nota :** Utilice el adaptador HDMI para enchufar y desenchufar fácilmente el cable HDMI.

12 SPECIFICHE

Numero di modello	U4120
Alimentazione	AC 100-240V, ~50/60Hz
Driver della Soundbar	(3.1" x 1.2") x 3 (Soundbar) + 1.8" x 2 (driver con fuoco verso l'alto) + (3.1" x 1.2") x 2 (altoparlante della Surroundbar) + 8" (subwoofer)
Risposta in frequenza	35Hz - 18kHz
Potenza in standby	<0.5W
Temperatura di esercizio	0°C - 45°C / 32°F - 113°F
Visione Bluetooth	5.3

Dimensioni e peso		
Soundbar	800(W) x 38(H) x 90(D)mm	31.5" x 1.5" x 3.5"
Subwoofer	315(W) x 385(H) x 190(D)mm	12.4" x 15.2" x 7.5"
Altoparlante surround	150(W) x 38(H) x 82(D)mm	5.9" x 1.5" x 3.2"
Imballaggio	472(W) x 306(H) x 430(D)mm	15.6" x 12" x 16.9"
Peso netto	6.7kg / 14.77lbs	
Peso lordo	8.94kg / 19.71lbs	

ULTIMEA

Nova S80

Manual del usuario

ESTAMOS LISTOS PARA AYUDAR



support@ultimea.com



Nº de modelo: U4120

¿Prefiere un tutorial en vídeo?

Vídeo guía de instalación o MANUAL DE USUARIO en el sitio web de ULTIMEA.

Twitter Facebook Instagram YouTube SoundCloud
@ultimea_official



support.ultimea.com

ES

+1 888-598-8875 (US) Mon-Fri 9am-5pm (PST)
+49 89-628-25828 (EU) Mon-Fri 9am-5pm (CET)

1 LISTA DE ACCESORIOS

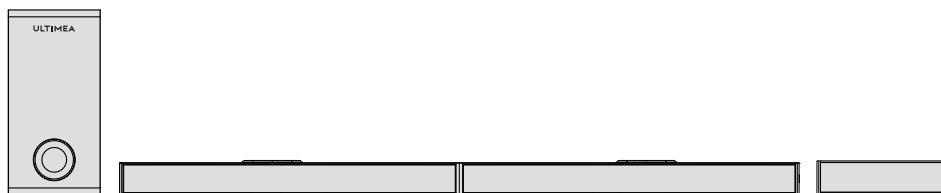

Barra de sonido

Subwoofer

Altavoz surround x 2



Adaptador de alimentación

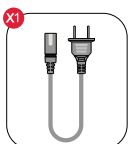

Cable de alimentación del subwoofer

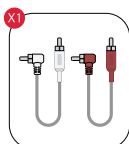

Cable de audio estéreo RCA a RCA (6 m) / Cable HDMI

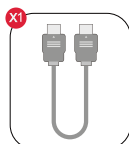

Cable HDMI

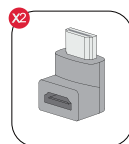

Adaptador HDMI

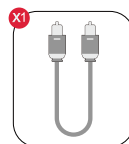

Cable óptico digital

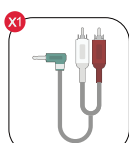

Cable de audio estéreo de 3.5 mm a RCA

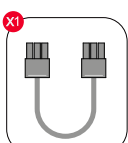

Cable de 6 clavijas para conexión de barra de sonido (140 mm)



Mando a distancia

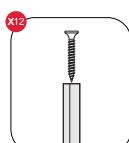

Kit de montaje en pared

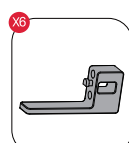

Soporte de pared



Manual del usuario

2 CONTROLES DE LA BARRA DE SONIDO

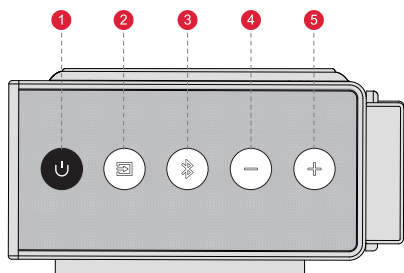

Panel de control

- 1 "⏻": **Botón de encendido**
Pulse para encender / apagar.
- 2 "📺": **Modo de entrada**
Pulse para cambiar de canal: eARC-HD IN (HDMI IN) - OPT (OPTICAL)-BT-AUX-USB.
- 3 "📶": **BT**
Pulse para cambiar al canal BT / Mantenga pulsado durante 3 segundos para desconectar el dispositivo actual y conectarse a un nuevo dispositivo. (BT ID: Nova S80).
- 4 "⏮": **Bajar volumen**
- 5 "⏭": **Subir volumen**

Mando a distancia

- 1 "⏻": **Botón de encendido**
Pulse para encender / apagar.
- 2 "eARC": **eARC**
Pulse para cambiar al canal HDMI eARC.
- 3 "HD IN": **HD IN**
Pulse para cambiar al canal HDMI IN.
- 4 "OPT": **OPT**
Pulse para cambiar al canal OPTICAL.
- 5 "BT": **BT**
Pulse para cambiar al canal BT / Mantenga pulsado durante 3 segundos para desconectar el dispositivo actual y conectarse a un nuevo dispositivo. (BT ID: Nova S80).
- 6 "EQ": **EQ**
Pulse para cambiar entre los modos Película, Diálogo, Música, la pantalla mostrará: "MOVIE", "DIALOG", "MUSIC".
- 7 "ENTRADA": **ENTRADA**
Pulse para cambiar de canal: eARC-HD IN (HDMI IN) -OPT (OPTICAL)-BT-AUX-USB.
- 8 "+": **Subir Volumen**
- 9 "-": **Bajar volumen**
- 10 "<": **Anterior**
Modo BT y USB: Salta a la pista anterior.
- 11 ">": **Siguiente**
Modo BT y USB: Salta a la pista siguiente.
- 12 "▶||": **Reproducir / Pausa**
Sólo para los modos BT y USB.
Modo USB: Mantenga pulsado durante 3 segundos para cambiar entre reproducción de bucle simple y reproducción de bucle de lista.
- 13 "Dolby ATMOS": **Dolby Atmos**
Pulse para ajustar el nivel de sonido de los controladores superiores, la pantalla mostrará: "AT-1", "AT 0", "AT 1".
- 14 "SURROUND": **Surround**
Pulse para ajustar el nivel de sonido envolvente, la pantalla mostrará: "SR-2", "SR-1", "SR 0", "SR 1".
- 15 "BASSMAX": **BASSMAX**
Pulse este botón para ajustar el nivel de graves: "B5-4", "B5-3", "B5-2", "B5-1", "B5 0", "B5 1", "B5 2", "B5 3", "B5 4".
- 16 "🔇": **Silenciar / Recuperar el volumen.**

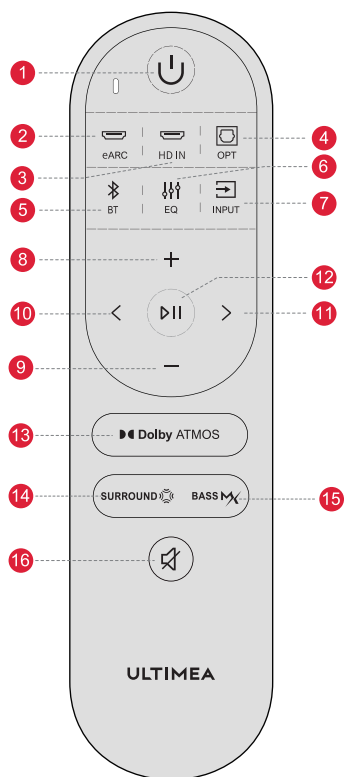

3 INSTALACIÓN DE LA BARRA DE SONIDO

Pasos de montaje

Paso 1

Coloque las dos partes de la barra de sonido al mismo nivel y alinee las juntas de conexión. Conecte las dos partes empujando paralelamente para combinarlas como una sola pieza.

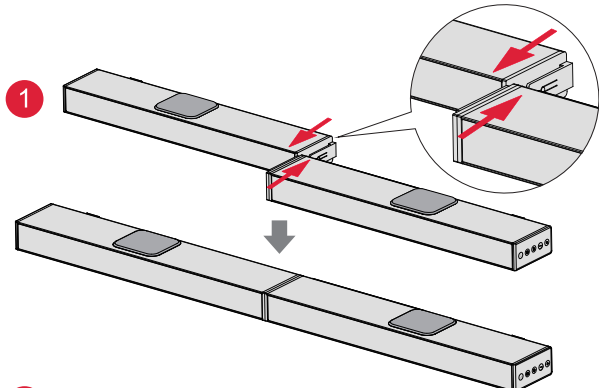

Paso 2

Enchufe el cable de 6 clavijas.

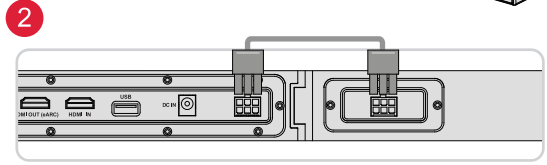

4 CONECTE AL TELEVISOR MEDIANTE SALIDA HDMI eARC / ARC

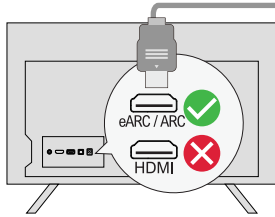

Paso 1:

Conecte un extremo del cable HDMI al puerto eARC / ARC de la parte posterior del televisor.

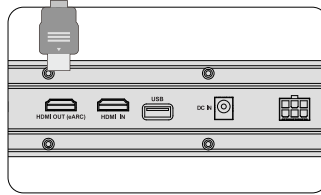

Paso 2:

A continuación, conecte el otro extremo al puerto HDMI (eARC) de la barra de sonido.

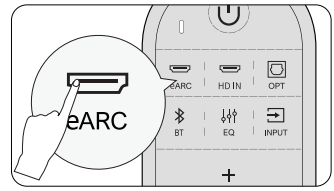

Paso 3:

Pulse el botón "eARC" del mando a distancia para seleccionar la entrada "HDMI OUT (eARC)".

Nota:

1 El puerto HDMI de su televisor debe ser compatible con eARC para transmitir el formato de audio Dolby Atmos a su Soundbar.

Atmos: Si está viendo una película en formato Dolby Atmos, ajuste la salida de audio del televisor en Pass Through:

Ajustes TV > Inicio > Ajustes > Sonido > Salida de audio digital > Pass Through.

DTS: Si está viendo una película en formato DTS, configure la salida de audio del televisor como PCM: .

Ajustes TV > Inicio > Ajustes > Sonido > Salida de audio digital > PCM

2 Si el HDMI de su televisor sólo admite ARC, configure la salida de audio de su televisor en PCM, normalmente como se indica a continuación.

Ajustes TV > Inicio > Ajustes > Sonido > Salida de audio digital > PCM

¿Cuál es la diferencia entre: HDMI IN, HDMI ARC, HDMI eARC?

HDMI IN es una entrada HDMI estándar que permite conectar dispositivos al televisor o al sistema de audio. Admite señales de audio y vídeo, pero no es compatible con las funciones de canal de retorno de audio (ARC) o canal de retorno de audio mejorado (eARC).

HDMI ARC es un puerto HDMI especial que permite la comunicación bidireccional entre el televisor y el sistema de audio. Esto significa que el audio puede enviarse desde el televisor al sistema de audio, y el sistema de audio puede devolver el audio al televisor.

HDMI eARC (canal de retorno de audio mejorado) es una versión actualizada de HDMI ARC que admite formatos de audio de mayor calidad, como Dolby Atmos y DTS:X.

Nota: Active la función "CEC" en su televisor.

Cuando eARC / ARC está conectado, el mando a distancia del televisor puede controlar la barra de sonido y el televisor simultáneamente: 1 Encender / apagar 2 Ajustar el volumen

5 CONECTE A OTRO DISPOSITIVO A TRAVÉS DE LA ENTRADA HDMI

Paso 1

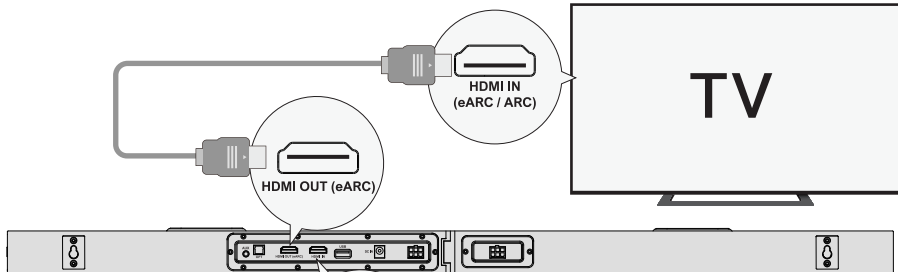

Paso 2

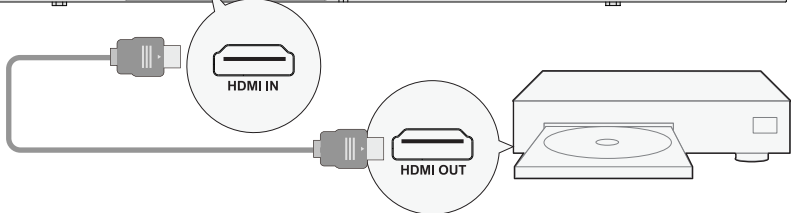

Paso 3

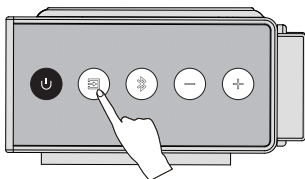

Paso 1: Conecte el cable HDMI al puerto HDMI OUT (eARC) de la barra de sonido y el otro extremo al puerto eARC / ARC del televisor.

Paso 2: Conecte el cable HDMI al puerto HDMI OUT del otro dispositivo (como un DVD o una videoconsola) y el otro extremo al puerto HDMI IN de la barra de sonido.

Paso 3: Pulse el botón "HDMI" en la barra de sonido o en el mando a distancia para cambiar a canal HDMI IN.

ES

6 CONEXIÓN AL TELEVISOR VÍA ÓPTICA / AUX

ÓPTICA

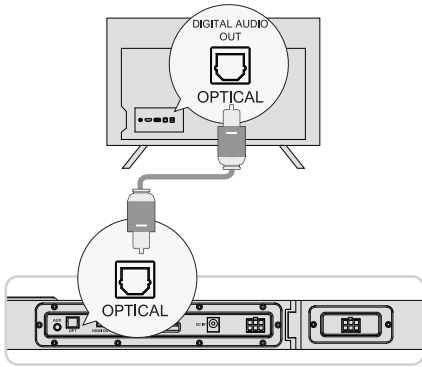

OPCIÓN 1: ÓPTICA

- 1 Asegúrese de que el cable está conectado al puerto OPTICAL OUT del televisor y el otro extremo al puerto OPTICAL de la barra de sonido.
- 2 Asegúrese de que el conector óptico está insertado correctamente como se muestra en la imagen. No inserte el enchufe al revés y rompa el conector óptico.

Nota: Si se reproduce audio por los altavoces internos del televisor, silencie o minimice el volumen del televisor.

AUX

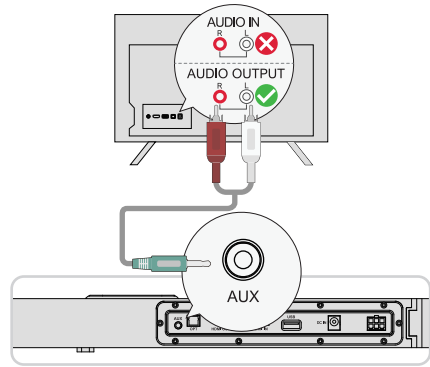

OPCIÓN 2: AUX

- 1 Conecte el cable de audio de 3.5 mm a RCA para conectarlo al puerto RCA AUDIO OUT de su TV.
- 2 Asegúrese de que el color de los extremos de los cables coincide con el color de los puertos del televisor.

Nota: Recuerde desconectar el cable AUX del televisor y de la barra de sonido cuando desee cambiar de modo.

En modo óptico: Si no hay sonido, pruebe a ajustar la salida de audio del televisor a PCM:
Ajustes TV > Inicio > Ajustes > Sonido > Salida de audio digital > PCM

7 CONECTAR CON BLUETOOTH

- 1 Pulse el botón "Bluetooth" de la barra de sonido o del mando a distancia para acceder al modo de emparejamiento Bluetooth.
- 2 Abra la configuración Bluetooth de su teléfono, busque y seleccione "Nova S80" para conectar la barra de sonido.

Nota: Si ya está en modo Bluetooth y conectado, mantenga pulsado el botón "Bluetooth" durante 3 segundos para desconectar el dispositivo actual y conectarse a un nuevo dispositivo manualmente en su teléfono móvil / PC / TV.



8 CONECTAR A SUBWOOFER Y ALTAVOCES SURROUND

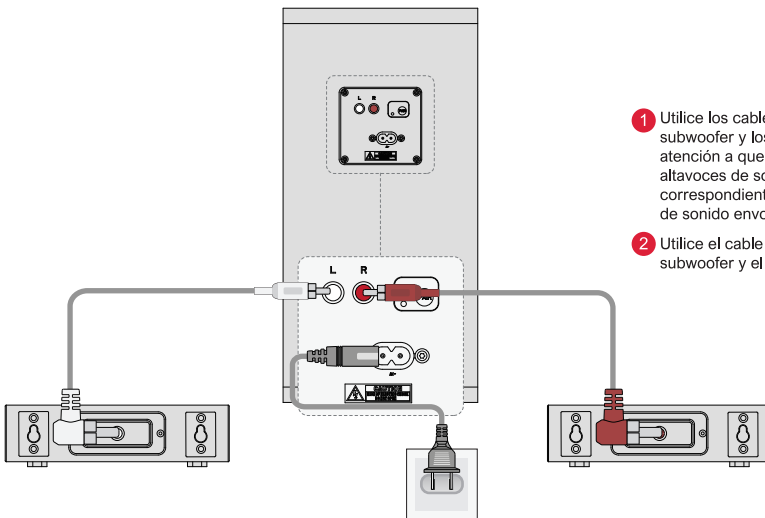

- 1 Utilice los cables RCA-RCA de 6 m para conectar el subwoofer y los altavoces de sonido envolvente; preste atención a que las interfaces del mismo color de los altavoces de sonido envolvente coincidan con las correspondientes del subwoofer y coloque los altavoces de sonido envolvente en consecuencia.
- 2 Utilice el cable de alimentación para conectar el subwoofer y el puerto de alimentación.

9 EMPAREJAMIENTO SUBWOOFER

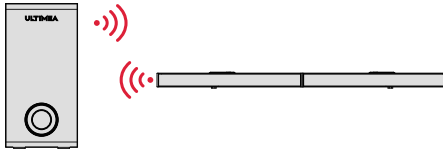

ULTIMEA ha emparejado automáticamente el subwoofer con la barra de sonido.
Si el subwoofer no emite sonido, deberá volver a emparejar la barra de sonido con el subwoofer.



Paso 1

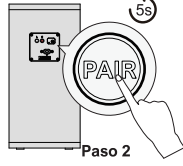

Paso 2

Paso 1
Mantenga pulsado el botón "BASS M" del mando a distancia durante 5 segundos, la pantalla mostrará "SUB" parpadeando.
Paso 2
Mantenga pulsado el botón PAIR del subwoofer durante 5 segundos, el LED blanco parpadeará rápidamente.
El LED blanco estará siempre encendido cuando el subwoofer se haya emparejado correctamente.

ES

10 OPCIONES DE COLOCACIÓN

Sonido envolvente completo de 360° (mejor sonido envolvente)

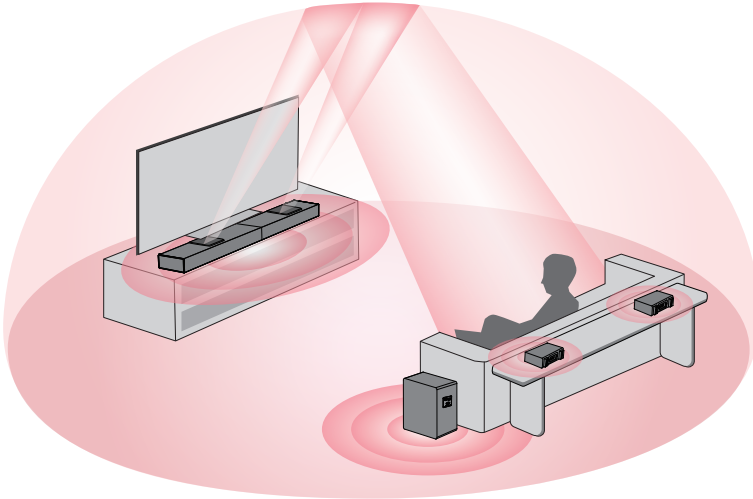

Envolvente frontal

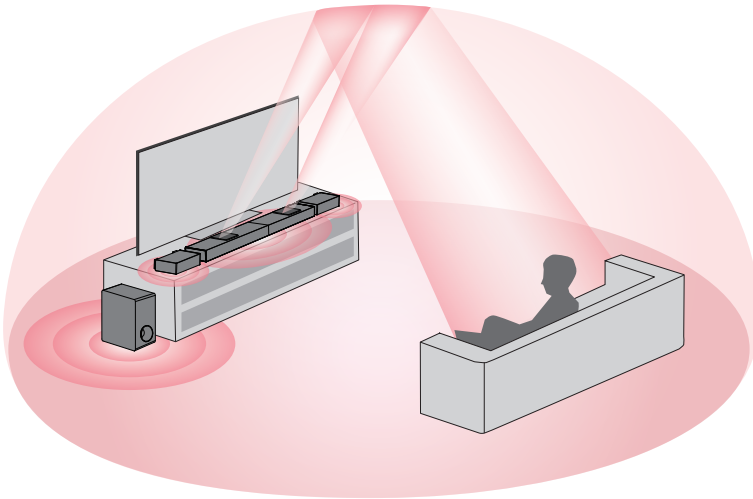

- 1 Para una mejor experiencia de escucha, elija una de las dos opciones de colocación que se muestran en la ilustración anterior en función de su entorno doméstico.
- 2 La barra de sonido debe colocarse a la altura del oído o cerca de él.

11 INSTALACIÓN MURAL

ES

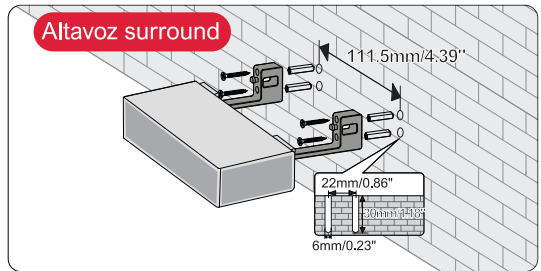
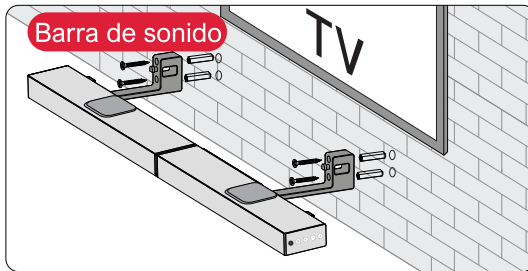
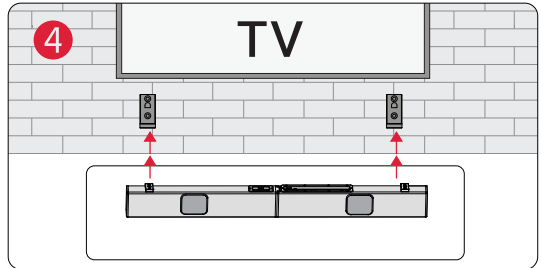
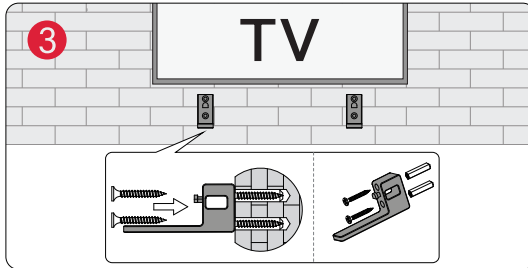
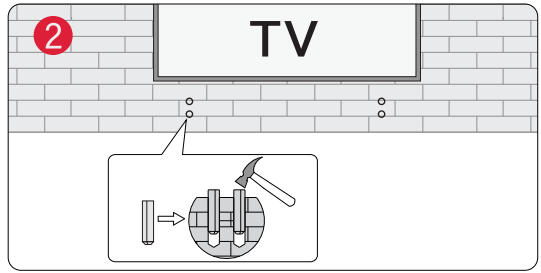
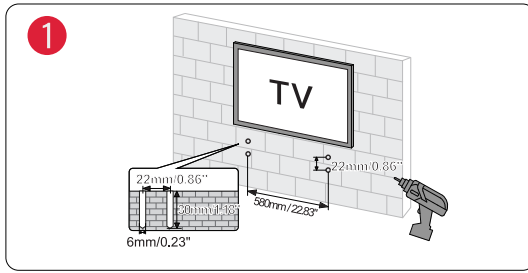

 **Nota :** Utilice el adaptador HDMI para enchufar y desenchufar fácilmente el cable HDMI.

12 ESPECIFICACIONES

Número de modelo	U4120
Fuente de alimentación	AC 100-240V, ~50/60Hz
Altavoces de la barra de sonido	(3.1" x 1.2") x 3(barra de sonido)+ 1.8" x 2(altavoces de tiro ascendente) + (3.1" x 1.2") x 2(altavoz de la barra surround) +8"(subwoofer)
Respuesta en frecuencia	35Hz - 18kHz
Potencia en espera	<0.5W
Temperatura de funcionamiento	0°C - 45°C / 32°F - 113°F
Visión Bluetooth	5.3

Dimensiones y peso		
Barra de sonido	800(W) x 38(H) x 90(D)mm	31.5" x 1.5" x 3.5"
Subwoofer	315(W) x 385(H) x 190(D)mm	12.4" x 15.2" x 7.5"
Altavoz surround	150(W) x 38(H) x 82(D)mm	5.9" x 1.5" x 3.2"
Embalaje	472(W) x 306(H) x 430(D)mm	15.6" x 12" x 16.9"
Peso neto	6.7kg / 14.77lbs	
Peso bruto	8.94kg / 19.71lbs	

SAFETY INSTRUCTIONS

Please read this user manual carefully and save it for future reference.

Do not make unauthorized alterations to the product, doing so may compromise safety, regulatory compliance, system performance, and may void the warranty.

- Avoid dropping.
- Do not disassemble.
- Do not submerge in water
- Avoid extreme temperatures.
- Do not use the device outdoors during thunderstorms.
- Use original or certified cables.
- Do not place dangerous items on top of this device (e.g. liquid filled objects, lit candles).
- Clean with a dry, soft lint-free cloth. Do not use any corrosive cleaner or oil.
- To avoid hearing damage, do not listen for extended periods at high volume.
- Do not expose the batteries to extreme heat sources such as direct sunlight or open flames.
- The ideal operating temperature for this product and its accessories is between 41°F/5°C and 95°F/35°C.
- The adapter should be installed near the device and should be easily accessible.
- Do not use this product in environments of extreme heat or cold. Never expose this device to strong sunshine or wet environments.

PROPER DISPOSAL INSTRUCTIONS



This mark shown on the product or its packaging, indicates that this product should not be disposed of with other household waste at the end of its working life.

To prevent possible harm to the environment or human health from uncontrolled waste disposal, please separate this from other types of wastes and recycle it responsibly to promote the sustainable reuse of material resources.

Waste Electrical & Electronic Equipment

Household user should contact either the retailer where they purchased this product, or their local government office, for details of where and how they can take this item for environmentally safe recycling.

Business users should contact their suppliers and check the terms and conditions of the purchase contract. This product should not be mixed with other commercial wastes for disposal.

FCC REGULATORY COMPLIANCE

Any changes or modifications not expressly approved by the party responsible for compliance could void the user's authority to operate the equipment.

This device complies with Part 15 of the FCC Rules.

Operation is subject to the following two conditions:

- (1) This device may not cause harmful interference.
- (2) This device must accept any interference received, including interference that may cause undesired operation.

NOTE: This equipment has been tested and found to comply with the limits for a Class B digital device, pursuant to part 15 of the FCC Rules. These limits are designed to provide reasonable protection against harmful interference in a residential installation. This equipment generates, uses, and can radiate radio frequency energy, and if not installed and used in accordance with the instructions, may cause harmful interference to radio communications.

However, there is no guarantee that interference will not occur in a particular installation. If this equipment does cause harmful interference to radio or television reception, which can be determined by turning the equipment off and on, the user is encouraged to try to correct the interference by one or more of the following measures:

- Reorient or relocate the receiving antenna.
- Increase the separation between the equipment and the receiver.
- Connect the equipment to an outlet on a circuit different from that to which the receiver is connected.
- Consult the dealer or an experienced radio / TV technician for help.

ISED WARNINGS

This device contains licence-exempt transmitter (s) / receiver (s) that comply with Innovation, Science and Economic Development Canada's licence-exempt RSS (s). Operation is subject to the following two conditions:

- (1) This device may not cause interference.
- (2) This device must accept any interference, including interference that may cause undesired operation of the device.

L'émetteur/récepteur exempt de licence contenu dans le présent appareil est conforme aux CNR d'Innovation, Sciences et Développement économique Canada applicables aux appareils radio exempts de licence. L'exploitation est autorisée aux deux conditions suivantes:

- (1) L'appareil ne doit pas produire de brouillage;
- (2) L'appareil doit accepter tout brouillage radioélectrique subi, même si le brouillage est susceptible d'en compromettre le fonctionnement.

The device meets the exemption from the routine evaluation limits in section 2.5 of RSS 102 and compliance with RSS-102 RF exposure, users can obtain Canadian information on RF exposure and compliance.

Le dispositif rencontre l'exemption des limites courantes d'évaluation dans la section 2,5 de RSS 102 et la conformité à l'exposition de RSS-102 rf, utilisateurs peut obtenir l'information canadienne sur l'exposition et la conformité de rf.

This transmitter must not be co-located or operating in conjunction with any other antenna or transmitter. This equipment should be installed and operated with a minimum distance of 20 centimeters between the radiator and your body.

Cet émetteur ne doit pas être Co-placé ou ne fonctionnant en même temps qu'aucune autre antenne ou émetteur. Cet équipement devrait être installé et actionné avec une distance minimum de 20 centimètres entre le radiateur et votre corps.

Declaration of Conformity

We (Manufacturer is responsible for this declaration)
Dyanic (Shenzhen) Technology Limited
(Company name)

20th Floor, Building 4, Tianan Cloud Park, Bantian St.,
Longgang District Shenzhen, China 518000
(Company address)

Declare under our sole responsibility that the product
Trade Mark: ULTIMEA
Product Name: Nova S80 5.1.2 Channel Dolby Atmos Soundbar
Model No.: U4120
To which this declaration relates is in conformity with
the essential
requirement set out in the Council Directive on the
Approximation of the laws of the Member States
relating to RED Directive (2014/53/EU) & RoHS (2011/
65/ EU) product is responsible to affix CE marking, the
following standards were applied:

EN 55032:2015/A11:2020
EN 55035:2017/A1:2020
ENIEC 61000-3-2:2019/A1:2021
EN 61000-3-3:2013/A2:2021
ETSI EN 301 489-1 V2.2.3(2019-11)
ETSI EN 301 489-17 V3.2.4(2020-09)
EN 300 328 V2.2.2(2019-07)
EN 50663:2017
EN IEC 62368-1:2020+A11:2020
IEC62321-3-1:2013
IEC 62321-4:2013+A1:2017
IEC 62321-5:2013
IEC 62321-6:2015
IEC 62321-7-1:2015
IEC 62321-7-2:2017
IEC 62321-8:2017

Full Name: Yoyo.Yu
Position: Approbation Manager
Signature: 
Place/Date: Shenzhen, China / Dec. 25-2023

Trade Marks:



Dolby, Dolby Atmos, and the double-D symbol are registered trademarks of Dolby Laboratories Licensing Corporation. Manufactured under license from Dolby Laboratories. Confidential unpublished works. Copyright© 2012-2021 Dolby Laboratories. All rights reserved.



The Bluetooth® word mark and logos are registered trademarks owned by Bluetooth SIG, Inc. and any use of such marks by Soundlab Technology Co.,Ltd. is under license. Other trademarks and trade names are those of their respective owners.



The Adopted Trademarks HDMI, HDMI High-Definition Multimedia Interface, HDMI trade dress and the HDMI Logos are trademarks or registered trademarks of HDMI Licensing Administrator, Inc. in the United States and other.

ULTIMEA

Nova S80 5.1.2 Channel Dolby Atmos Soundbar
Model No.: U4120

 Dyanic GmbH
Buchenring 57, 22359 Hamburg, Germany

 UK Crossborder limited
7 Bell Yard London WC2A 2JR, UK United Kingdom

Made in China
Manufacturer: Dyanic (Shenzhen) Technology Limited
Address: 20th Floor, Building 4, Tianan Cloud Park, Bantian St.,
Longgang District, Shenzhen, China 518000

If you need our support, kindly reach out to our
service team. We are always glad to help.

 +1 888-598-8875 (US)
Mon-Fri 9am-5pm (PST)
+49 89-628-25828 (EU)
Mon-Fri 9am-5pm (CET)
 support@ultimea.com
support@ultimea.de
 support.ultimea.com
support.ultimea.de



@ultimea_official