

The [Homey Pro Ethernet Adapter](#) can be used together with [Homey Pro \(Early 2023\)](#) to add wired connectivity to Homey Pro.

The Homey Pro Ethernet Adapter is designed to be placed near Homey Pro's power adapter. This ensures all cables being together and out-of-sight, so Homey Pro will always be the eye-catcher in your home.

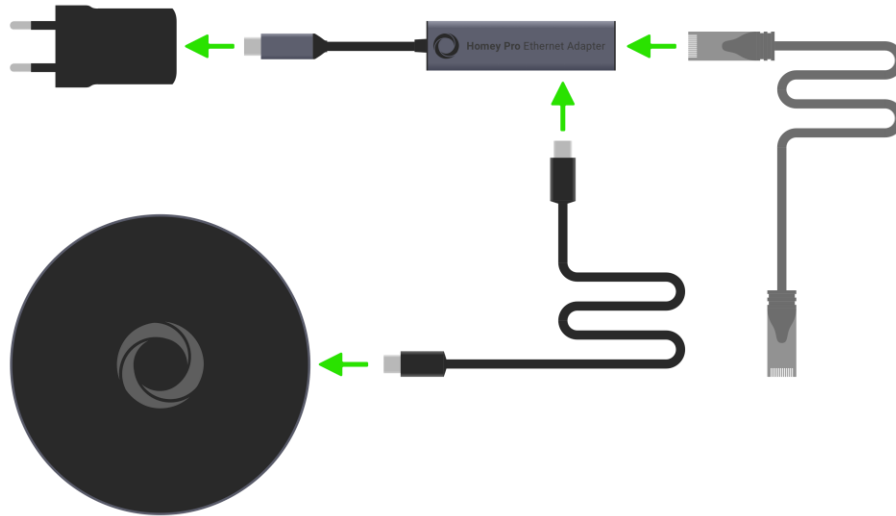

1. The short-end cable of the Homey Pro Ethernet Adapter should be plugged into the power adapter.
2. Plug Homey Pro's USB-C cable into the side of the Homey Pro Ethernet Adapter.
3. Finally, plug in an ethernet cable into the Homey Pro Ethernet Adapter.

Warning: Do not plug the short end cable directly in Homey Pro! The lights on the Homey Pro Ethernet Adapter will blink but there will be no connection!

That's it! Homey Pro will automatically use the ethernet connection if it's available. During setup, you will be asked to optionally connect to Wi-Fi as well.

💡 The Homey Pro Ethernet Adapter is a Gigabit adapter, but please note that the speeds are limited to USB2.0 speeds (480 Mbit/s).